

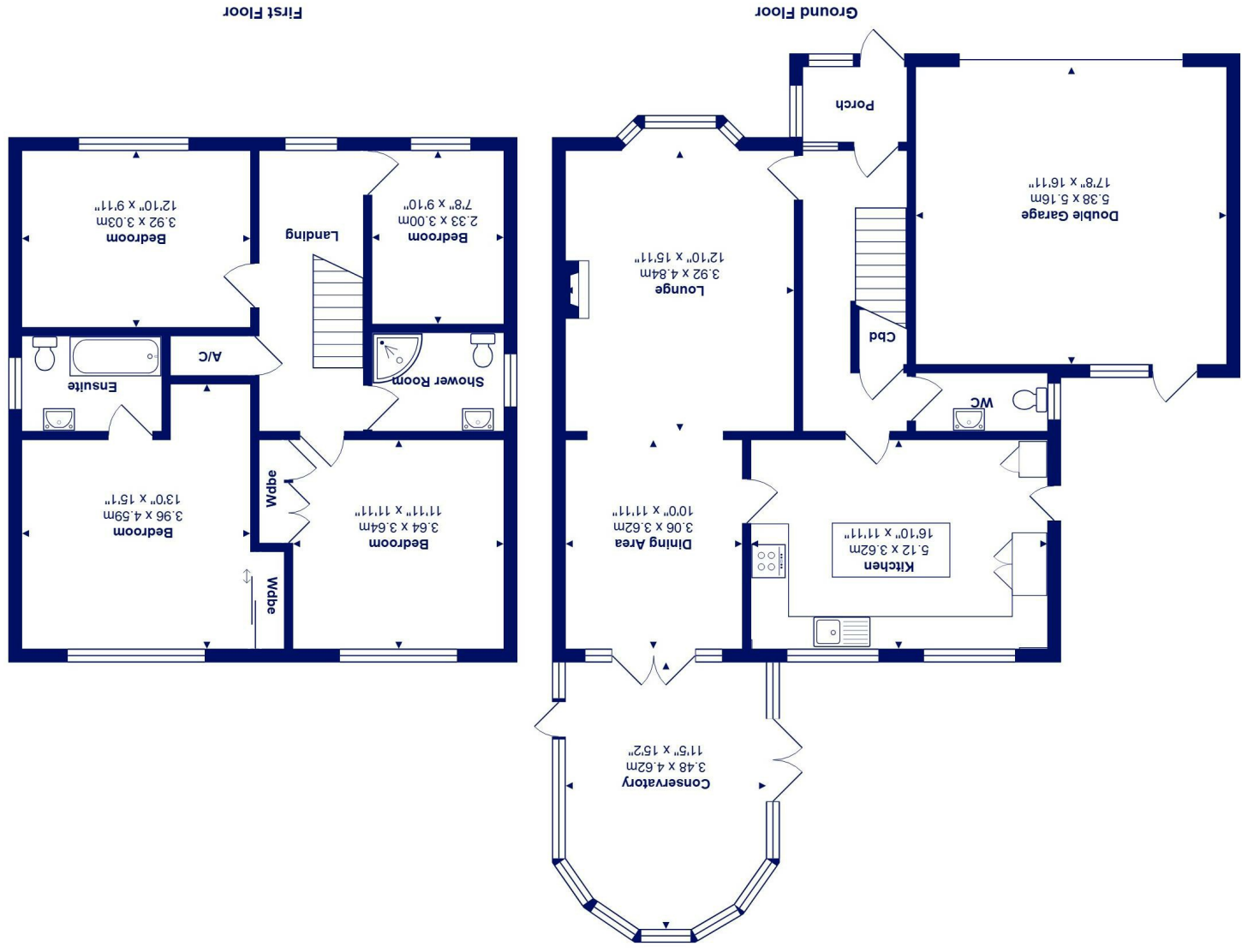

Total Area: 153.9 m² ... 1657 ft² (excluding double garage)
All measurements are approximate and for display purposes only



12 Chewton Lodge, Highcliffe on Sea, BH23 5LQ £925,000

Mitchells
1963 — TODAY

A fabulous, executive style home on the south side of the Lymington Road, forming part of a select development right by Chewton Bunny Nature Reserve which leads to the beach. Standing on arguably the best plot on the road, the gardens are truly special, wrapping around the house with a stunning parklike feel. Immaculate inside and out- a truly outstanding home in a favoured location.

Houses in Chewton Lodge are rarely available and this one is an absolute cracker. The current owners have meticulously refurbished the house and it now offers bright and breezy living space that totals towards 1700 sq ft with stylish fittings, designer bath/shower rooms and a magnificent conservatory extension overlooking the gardens. The position is perfect being quietly tucked away offering excellent privacy and seclusion and is just short stroll through the Nature Reserve to Highcliffe Beach and a level walk to the bustling village centre. If you are a keen gardener, this house is for you- the backdrop and planting is very special indeed.

- Quality detached house of nearly 1700 sq ft presented impeccably with smart decor and fittings
- Four first floor bedrooms with two refitted bath/shower rooms, stylish tiling and sanitary ware
- Newly fitted kitchen with contemporary worktops, quartz tops with a large central island and a view of the gardens
- Bright and airy , through sitting/dining room that leads to the wonderful conservatory extension
- Lovely entrance hall with oak flooring
- Double garage and plenty of parking
- Stunning gardens enjoying all day sunshine, large sandstone sun terrace, tucked away vegetable borders and an array of specimen shrubs and trees
- Prestigious location by the beach and village centre

EPC Rating Band:
Council Tax Band: F
Freehold

Successful buyers will be required to complete online identity checks provided by Lifetime Legal. The cost of these checks is £49 inc. VAT per purchase which is paid in advance, directly to Lifetime Legal. This check verifies your identity in line with our obligations as stipulated by our regulatory body, HMRC

