



55 Oakwood Avenue, New Milton, BH25 5DZ

£550,000

Mitchells
1963 — TODAY



*55 Oakwood Avenue
New Milton
Hampshire
BH25 5DZ*

This highly deceptive chalet bungalow is situated within walking distance of New Milton town centre and Ballard Lake and offers bright and versatile accommodation. The property has recently gone through an extensive extension and partial refurbishment programme and features three ground floor double bedrooms, a ground floor bathroom, an open plan kitchen/living area, a partially completed utility, a pantry and additional bathroom or games room with a first floor study area and fourth bedroom.

- Entrance Hall
- Family Bathroom
- Three Double Bedrooms
- Sitting Room
- Kitchen
- Utility Area
- Pantry
- First Floor Study Area
- First Floor Fourth Bedroom
- Driveway
- Sunny And Secluded Gardens



The Property

Entrance hall with timber effect flooring, central heating controls and recessed ceiling spotlights.

Family bathroom with white suite comprising a panel bath with mixer tap over, an independent thermostatic shower with folding shower screen, wall hung wash hand basin with mixer tap over and storage beneath, a WC, fully tiled walls and tiled flooring.

The kitchen has been beautifully finished with modern grey shaker style wall and base units with a contrasting Quartz worktop, modern vertical radiator, ample space for dining room table and chairs and integrated appliances include an undercounter fridge, a dishwasher, recycle bins, eye level double oven, a ceiling lantern and sliding patio doors onto the rear garden. This also provides access to the pantry has partially finished walls with access through to the additional ground floor bathroom or play area with tiled flooring and a doorway through to the rear lobby.

This opens through to the sitting room which is a bright and spacious room with sliding patio doors onto the rear garden and ample space for furniture and stairs to the first floor.

On the ground floor there are three double bedrooms with bedroom two and three enjoying an outlook to the front.

Utility with wall hung Glow Worm combination boiler and a UPVC double glazed window giving an outlook to the rear garden with space and plumbing for a washing machine and tumble dryer.

On the first floor is a large landing area currently used as a home office with a Velux window, radiator and eaves storage.

This in turn leads through to bedroom four which is a lovely bedroom with a Velux window, a radiator and views over the rear garden.

The property offers an opportunity for the purchaser to complete the remaining unfinished areas to their own specification.





Gardens & Grounds

To the front of the property is a spacious driveway giving off road parking for approximately three vehicles with low level wall and mature hedging.

The rear garden is a particular feature of the this property being extremely spacious, private and secluded with a large area of lawn, a storage shed and double gates giving access to the driveway.

Services

- Mains gas, electricity, drainage and water
- Council Tax Band: D
- Energy Performance Rating: D

Ground Floor

Approx. 115.9 sq. metres (1247.1 sq. feet)

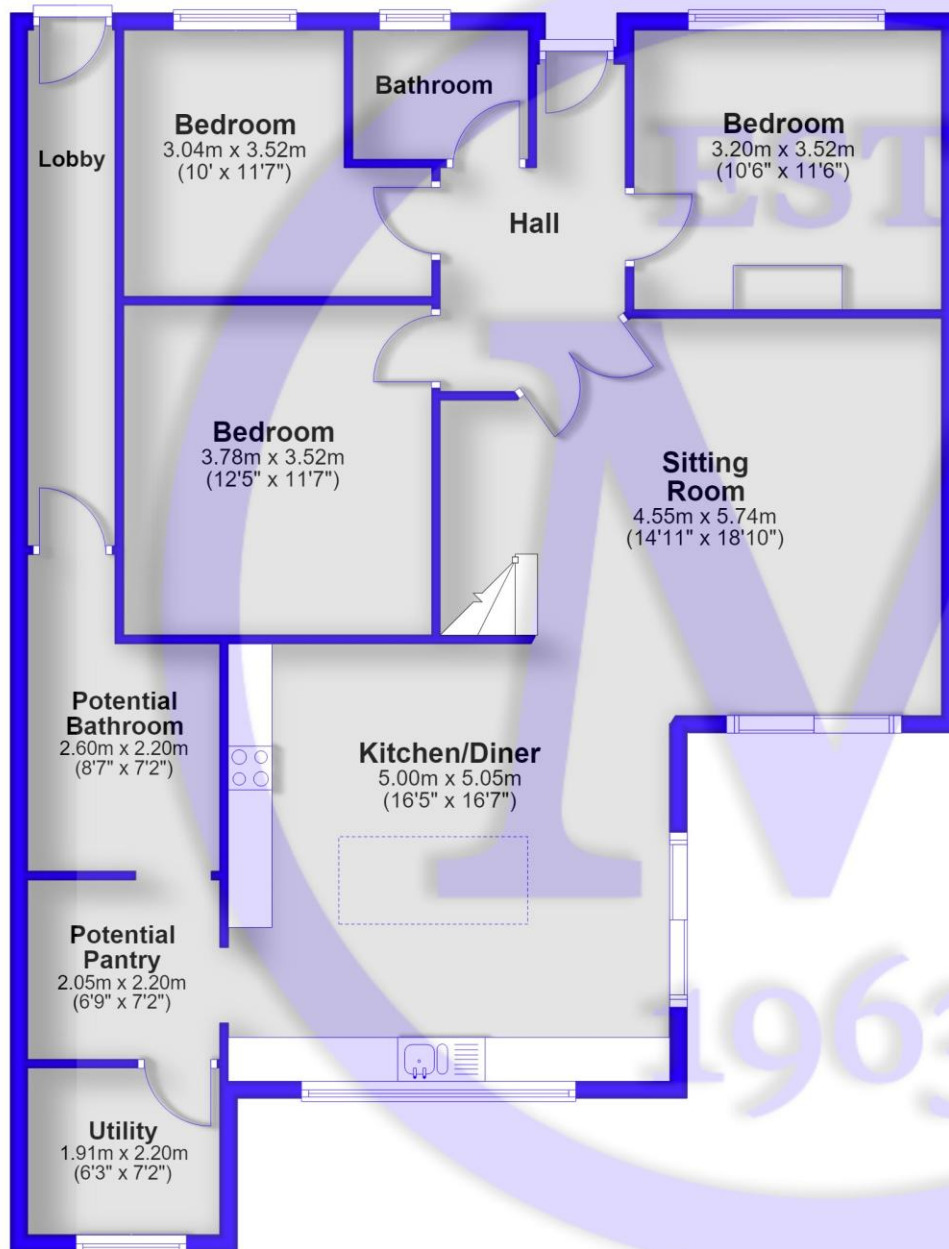

First Floor

Approx. 19.5 sq. metres (210.1 sq. feet)

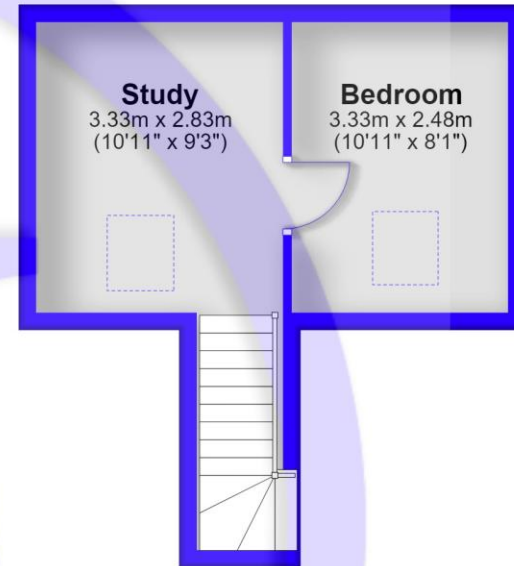

Total area: approx. 135.4 sq. metres (1457.2 sq. feet)

Situation

New Milton is a lively market town on Hampshire's west edge, right by the beautiful Solent coastline. You get amazing views across Christchurch Bay all the way to the Isle of Wight, plus fantastic coastal walks. The town's mainline railway station makes London Waterloo easy to reach in under two hours, perfect for commuters or anyone wanting seaside living. New Milton has great state and private schools, a 27-hole links-style golf course, and the famous Chewton Glen Hotel, making it a top spot for those moving to the coast.

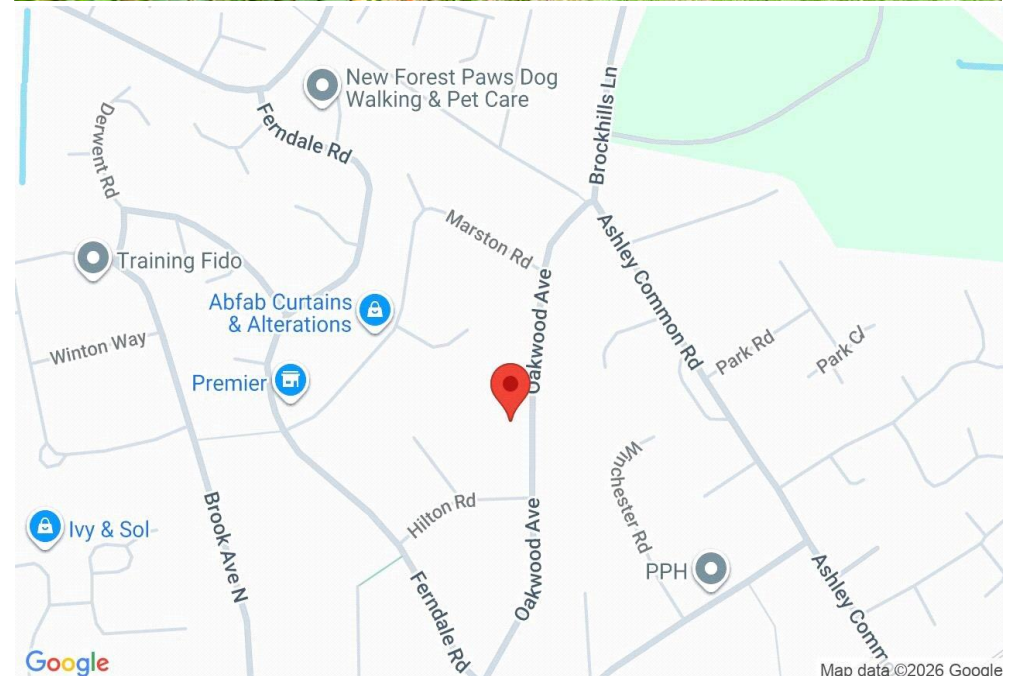



Mitchells.uk.com
info@mitchells.uk.com
01425 616411

Centenary Buildings
8-10 Old Milton Road
New Milton
Hampshire
BH25 6DT

Mitchells
1963 — TODAY

