

All measurements are approximate and for display purposes only.
Total Area: 187.7 m² ... 2020 ft²

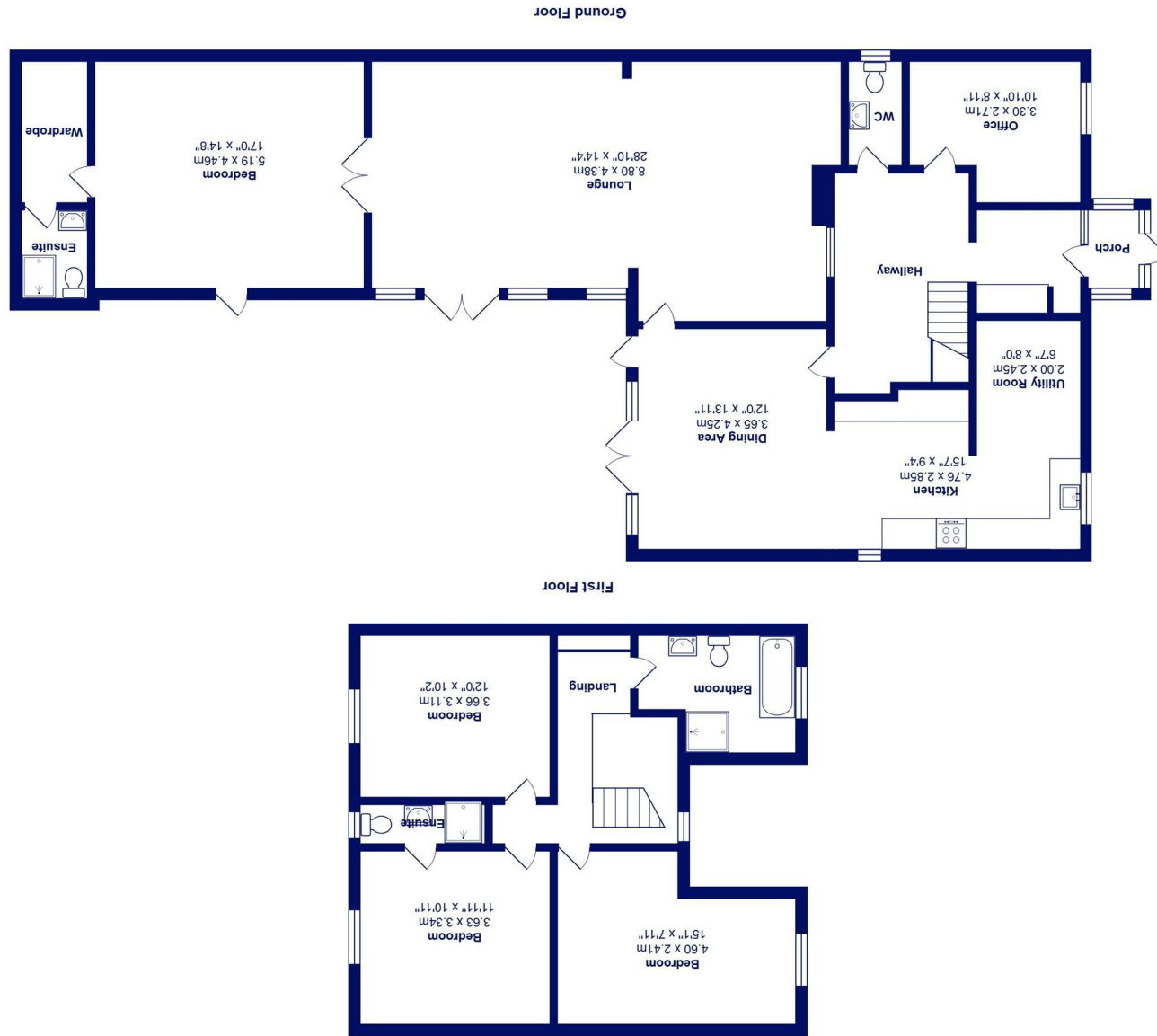

Whispering Oaks, 14 Chewton Common Road, BH23 5LU

£1,075,000

Mitchells
1963 — TODAY

Whispering Oaks is a delightful detached character cottage with late Victorian origins together with later additions making a deceptively spacious home with over 2000 sqft of accommodation and with annexe potential for a dependant relative or similar.

Occupying a wonderful private location, tucked away by Chewton Common, yet only a short stroll to the High Street, with the seafront just a little further on. Featuring a lovely, well stocked, south facing rear garden of about 100 ft, with numerous different seating and entertaining areas, all in total privacy.

- Versatile accommodation with 4/5 bedrooms & 3 bath/shower rooms
- Ground floor master bedroom with ensuite and dressing room
- Annexe or Air B&B potential with separate entrance
- Large lounge, almost 30 ft long
- Stylish, well fitted kitchen with large dining area
- Useful ground floor study/bedroom 5
- An idyllic hidden location yet close to amenities
- Beautiful south facing "old English" style garden
- Plenty of off road parking to the front/in the lane
- Viewing highly recommended to fully appreciate this fine property

EPC Rating Band: C

Council Tax Band: E

Freehold

Successful buyers will be required to complete online identity checks provided by Lifetime Legal. The cost of these checks is £45 inc. VAT per purchase which is paid in advance, directly to Lifetime Legal. This check verifies your identity in line with our obligations as stipulated by our regulatory body, HMRC

