



20 Grange Close, Everton, SO41 0TY

£450,000

Mitchells
1963 — TODAY



*20 Grange Close
Everton
Lymington
Hampshire
SO41 0TY*

This four bedroom, two reception room, semi-detached family house is situated in a highly sought after location within easy reach of Everton Village and Milford on Sea, with its popular facilities including an attractive village green and beach. Other features of this property include a large UPVC double glazed conservatory, an en-suite shower room to the master bedroom, a useful ground floor bedroom four/home office, a modern kitchen, a separate utility room, a sunny rear garden, and no forward chain.

- Porch & Entrance Hall
- Sitting Room & Dining Room
- Conservatory
- Cloakroom & Utility Room
- Kitchen/Breakfast Room
- Ground Floor Bedroom Four/Home Office
- Three First Floor Bedrooms
- En-Suite Bathroom
- Family Shower Room
- Off Road Parking & Private Gardens



The Property

Entrance porch with tiled flooring.

Entrance hall with exposed timber flooring, stairs to the first floor, and an understairs storage cupboard.

Spacious sitting room with a feature bay window overlooking the back garden and a recessed fireplace with a timber mantle, tiled hearth, and wood burning stove.

Separate dining room with double glazed sliding doors leading to the large conservatory, constructed of UPVC double glazing with a pitched polycarbonate roof, tiled flooring, and casement doors onto the south facing rear garden.

Modern kitchen/breakfast room fitted with a range of grey wall and base units, a timber worktop and upstand, an inset one and a half bowl sink unit with a mixer tap, a wall mounted Worcester gas fired boiler concealed in a cupboard, a breakfast bar, timber effect flooring, a double aspect, recessed ceiling spotlights, an outlook to the front, and space for a range style cooker with an extractor fan over, an American style larder fridge, and a dishwasher.

Useful separate utility room with space and plumbing for a washing machine, built-in storage, and tile effect flooring.

Ground floor bedroom four/home office with timber effect flooring and an outlook to the front.

Ground floor cloakroom fitted with a white suite.

First floor landing with a trap to the roof space and an airing cupboard.

Three good sized first floor bedrooms, two with built-in wardrobes, with the master bedroom benefiting from a luxury en-suite bathroom fitted with a modern white suite comprising a free standing bath with a mixer tap and shower attachment over, a separate fully tiled shower cubicle, a wash basin with storage beneath, a WC, attractive tiling, an extractor fan, recessed ceiling spotlights, and a chrome ladder style heated towel rail.

Family shower room fitted with a modern white suite comprising a fully tiled corner shower cubicle with a thermostatically controlled shower, a wash basin with storage beneath, a WC, a chrome ladder style heated towel rail, recessed ceiling spotlights, and an extractor fan.





Gardens & Grounds

The front garden has a block paviour driveway with an adjacent shingle area providing good off road parking, and a block paviour pathway leads to the front door.

Adjoining the rear of the property is a useful store room with casement doors onto the rear garden, and an area of textured paved patio leading to a large area of raised timber decking, ideal for outside entertaining, a log store, and a sunny southerly aspect.

Services

- Mains gas, electricity, drainage and water
- Council Tax Band: D
- Energy Performance Rating: D

Ground Floor

Approx. 88.6 sq. metres (953.4 sq. feet)

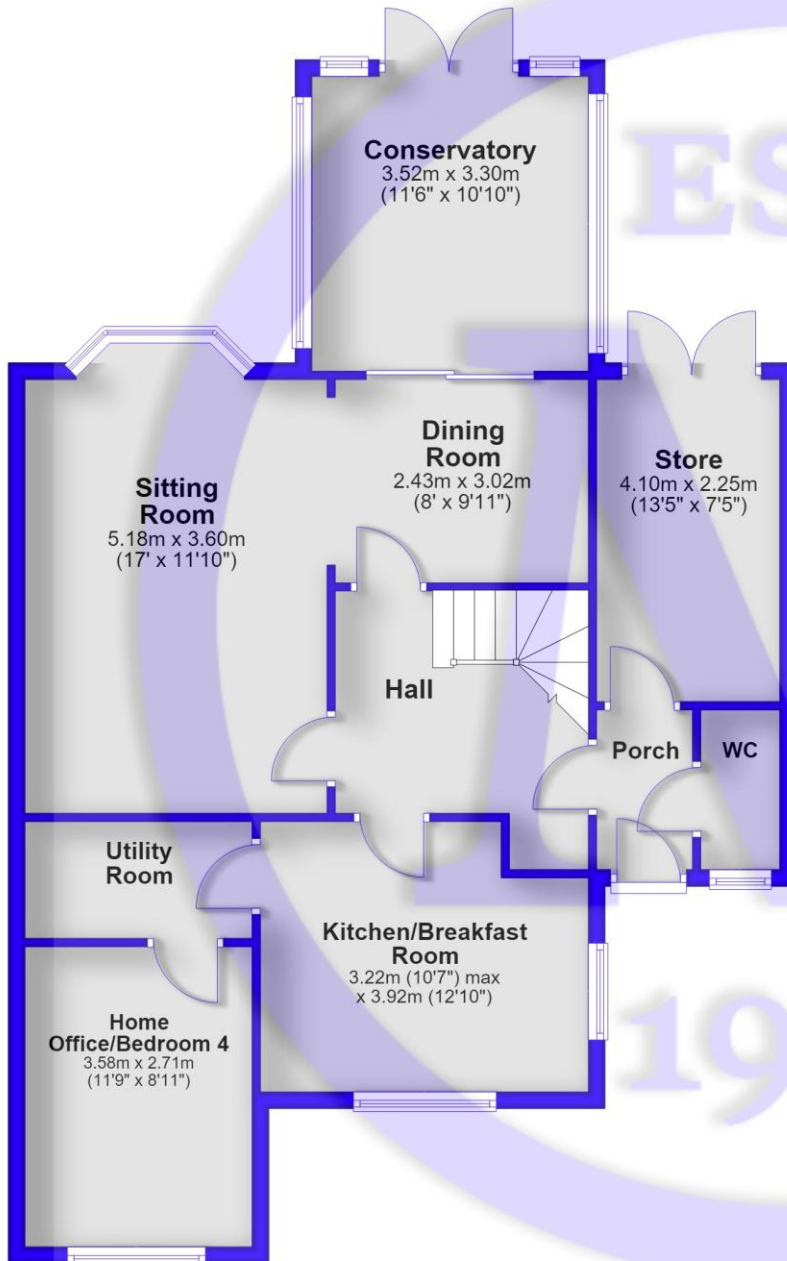

First Floor

Approx. 52.1 sq. metres (560.6 sq. feet)

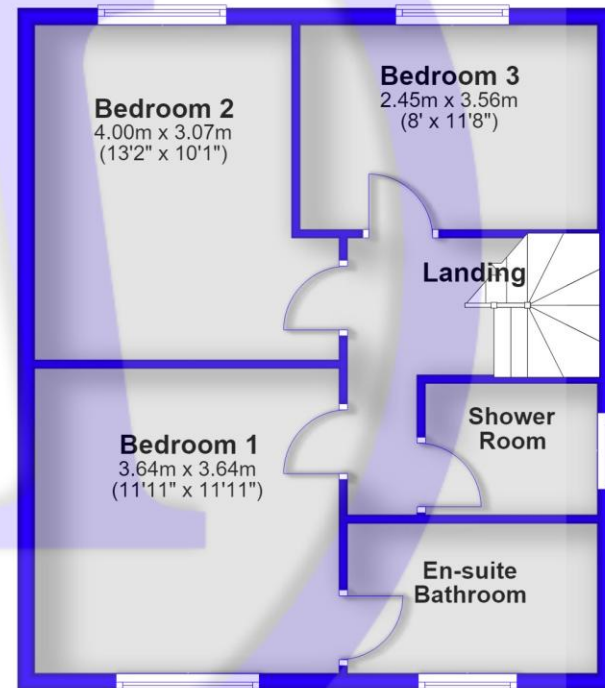

Total area: approx. 140.7 sq. metres (1514.0 sq. feet)

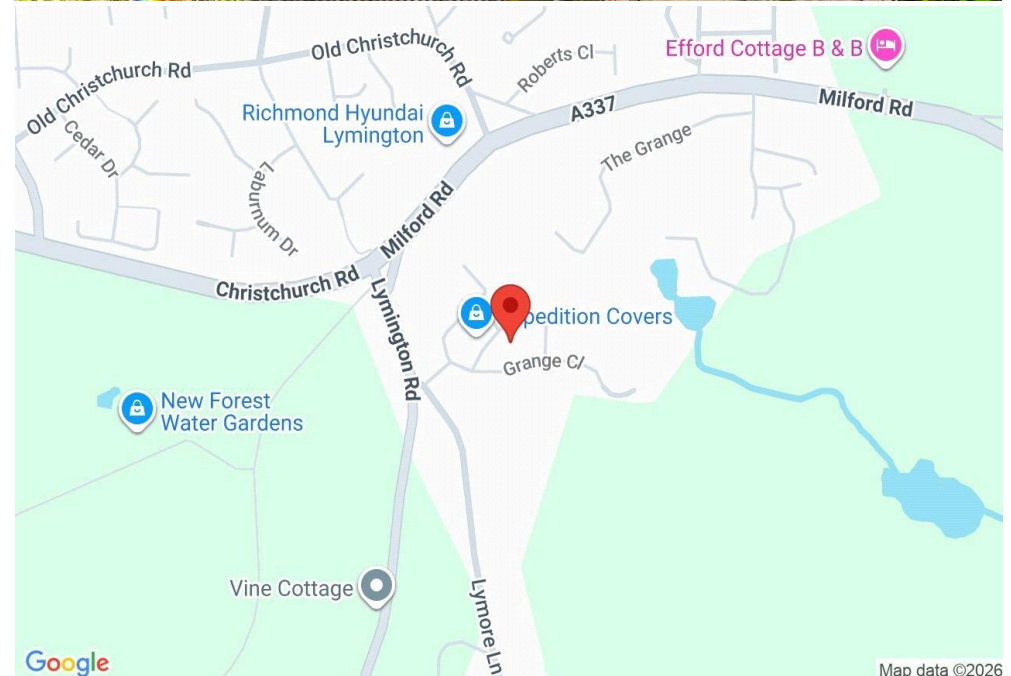

Situation

Everton is a small village between Lymington and New Milton. It has a village pub, store, and recreation ground. You're close to New Milton's railway station, Lymington's scenic quay, great local eateries like The Royal Oak in nearby Downton, the open forest, and Milford on Sea's clifftop beach. Everton is a great choice for a new home in a friendly village setting.



Mitchells.uk.com
info@mitchells.uk.com
01425 616411

Centenary Buildings
8-10 Old Milton Road
New Milton
Hampshire
BH25 6DT

Mitchells
1963 — TODAY

