



16, Fernglade, New Milton, BH25 5NZ

£395,000

Mitchells
1963 — TODAY



*16 Fernglade
New Milton
Hampshire
BH25 5NZ*

This fantastic two double bedroom detached house is ideally situated just a short walk from New Milton town centre and the mainline railway station. The property offers bright and spacious accommodation, with features including two lovely reception rooms, a generous master bedroom with an en-suite, a secluded west facing garden, and a garage.

- Entrance Porch
- Sitting Room
- Dining Room
- Kitchen
- First Floor Landing
- Two Double Bedrooms
- En-Suite Shower Room
- Family Bathroom
- Driveway & Garage
- Secluded West Facing Garden



The Property

Entrance porch with two useful storage cupboards, one with coat hooks and a modern electrical consumer unit.

A glazed door leads through to the sitting room, which features a bright double aspect, a fireplace with a marble hearth and ornate surround, an understairs storage cupboard, and sliding patio doors onto the rear garden.

This opens into the dining room, which has a bright double aspect, a feature bay window to the front, ample space for furniture, and an archway leading through to the kitchen.

The kitchen is fitted with a range of solid wood shaker style wall and base units, a contrasting worktop, a stainless steel one and a half bowl sink with a mixer tap and drainer, a modern Vaillant wall mounted boiler, and a tiled splashback. Integrated appliances include a four burner gas hob with an extractor fan above and an eye level double oven. There is space and plumbing for a washing machine, tumble dryer, and a tall stand up fridge/freezer.

First floor landing with a UPVC window allowing plenty of natural light, an airing cupboard housing the hot water tank with slatted shelves for storage, and a hatch to the loft space.

The master bedroom is a particularly generous room, with a bright double aspect overlooking the rear garden, built-in mirror-fronted wardrobes, and benefits from its own en-suite shower room.

The en-suite comprises a corner shower cubicle with sliding glass doors, a WC, a wash hand basin with storage beneath, part tiled walls, and a shaver point.

Bedroom two is a lovely double situated at the front of the property, with a mirror fronted wardrobe and an attractive bay window.

The family bathroom has been recently refitted with a modern white suite comprising a panelled bath with a mixer tap and independent electric Mira shower attachments, a folding glass shower screen, a WC, a wash hand basin with a mixer tap and storage beneath, a chrome heated towel rail, and a UPVC window.



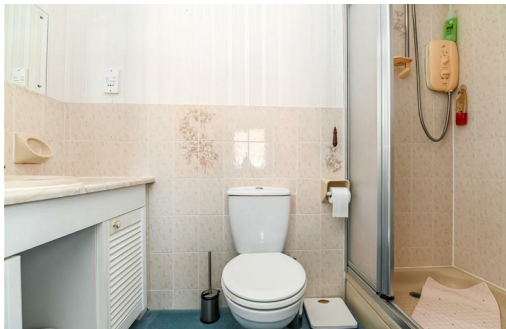

Gardens & Grounds

The rear garden is extremely private and secluded, with a bright, sunny south westerly aspect and a lovely patio area. The remainder of the garden is laid to lawn, with mature and colourful beds, a second patio, and a block paved pathway providing access to the single garage.

The single garage has a side door for access, an up and over door to the front, a window, and a pitched tiled roof.

This property is offered with no forward chain, and a viewing is highly recommended.

Services

Mains gas, electricity, water and drainage

Council Tax Band: D

Energy Performance Certificate (EPC) Rating:

Ground Floor

Approx. 47.3 sq. metres (509.6 sq. feet)

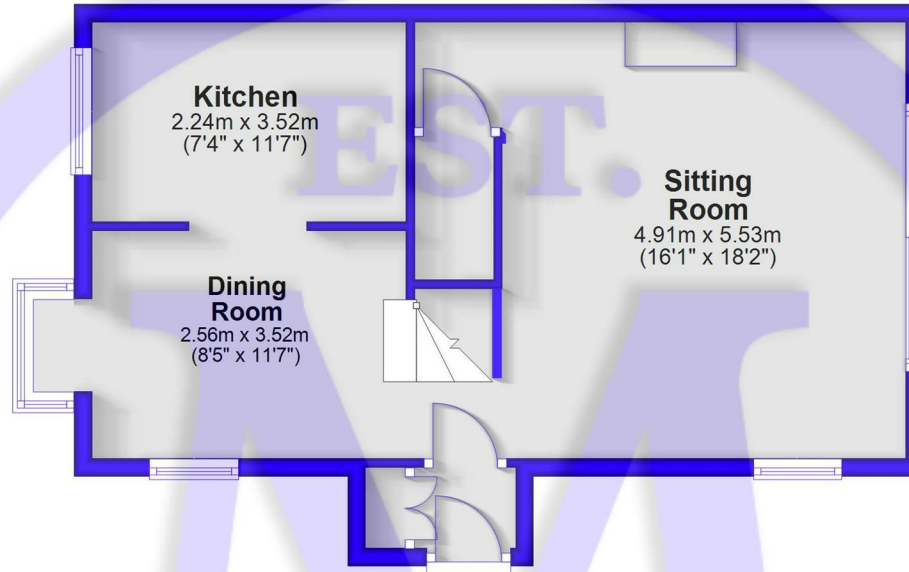

First Floor

Approx. 45.4 sq. metres (489.1 sq. feet)

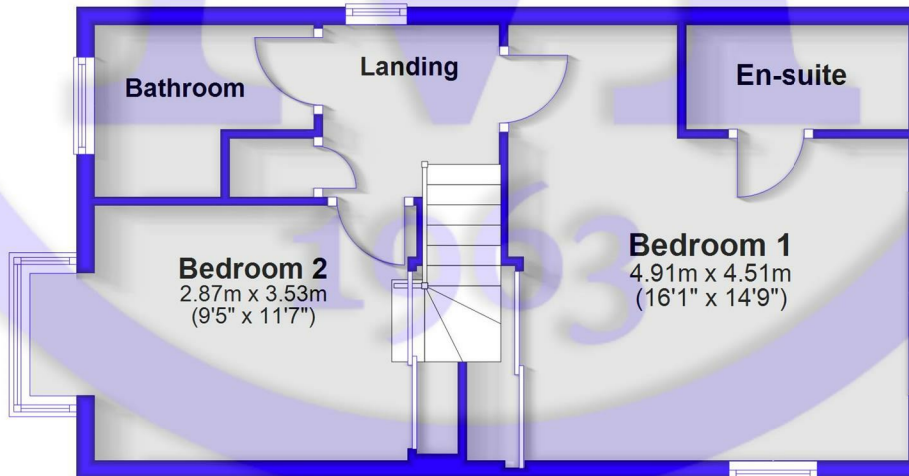

Total area: approx. 92.8 sq. metres (998.7 sq. feet)



Situation

New Milton is a thriving market town situated on the western edge of Hampshire, enjoying a prime location along a picturesque stretch of the Solent coastline. The area offers stunning views across Christchurch Bay to the Isle of Wight and is renowned for its beautiful coastal walks. With a mainline railway station providing direct access to London Waterloo in under two hours, the town is perfectly positioned for commuters and those seeking a coastal lifestyle. New Milton also boasts excellent state and private schools, a 27-hole links-style golf course, and the renowned Chewton Glen Hotel, making it an exceptionally popular destination for those looking to relocate to the coast.



Mitchells.uk.com
info@mitchells.uk.com
01425 616411

Centenary Buildings
8-10 Old Milton Road
New Milton
Hampshire
BH25 6DT

Mitchells
1963 — TODAY

