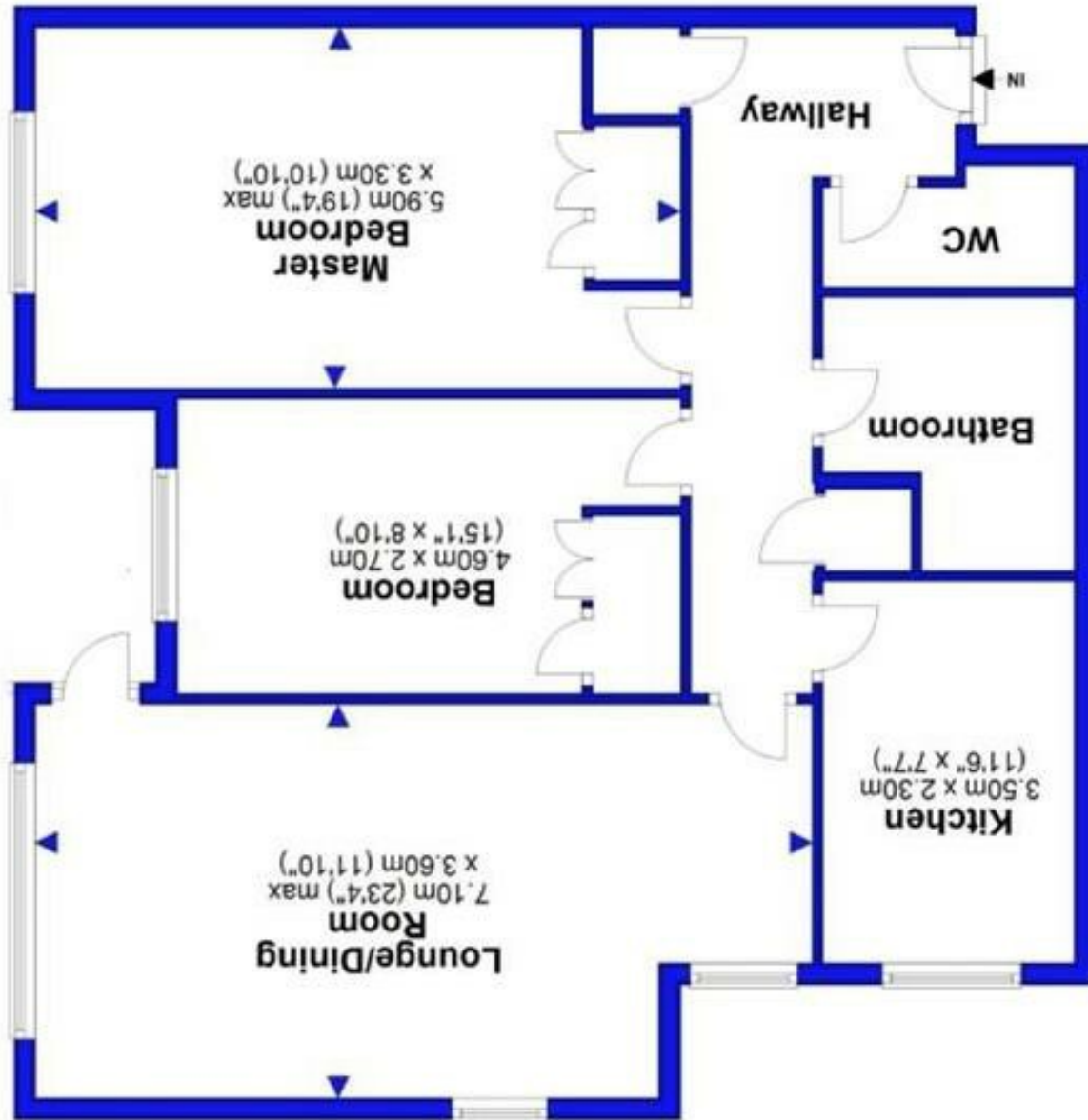

Illustration for identification purposes only; measurements are approximate, not to scale. EPC New Forest
Plan produced using PlanUp.



Approx Area: 83.3 sqm / 896.0 sqft



11 Kingsbere Gardens, Haslemere Ave, BH23 5BQ

£289,950

Mitchells
1963 — TODAY

A rare opportunity to acquire this immaculate ground floor apartment of nearly 900sqft and having been fully refurbished in recent years by the present owners. Being the biggest design in the development it offers large bright rooms and Easterly views over the communal gardens. The property benefits from a private sunny patio area and a short walk to the village centre, cliff top and beach.

- Fantastic condition throughout
- Two large double bedrooms
- Luxury shower room
- Separate wc
- Large double aspect sitting/dining room with access onto the patio
- Stylish brand new fitted kitchen with some integrated appliances
- Upvc double glazing & gas fired central heating
- Sought after location set in beautiful communal grounds and gardens
- Security entry phone system, single garage and casual parking
- Great location within a short walk of the village centre via footpath

EPC Rating Band: C
Council Tax Band: D

