

Total Area: 54.0 m² ... 582 ft²
All measurements are approximate and for display purposes only

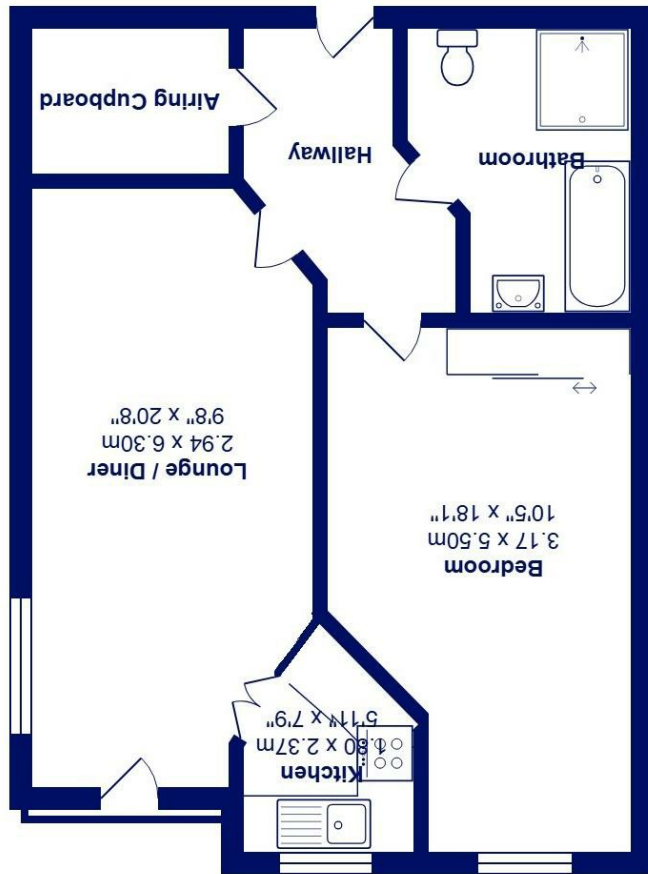

Flat 35, 46, Highview Court Wortley Road, BH23 5GJ

£155,000

Mitchells
1963 — TODAY

A beautifully maintained, southerly facing, one bedroom first floor apartment (with lifts) located within this prestigious development ideally situated within close proximity of Highcliffe village centre and cliff top. Highview Court provides the favoured 'Assisted Living' concept for over 65's with facilities including 24 hour staffing, Careline, security entry system, waitress service restaurant, residents' lounge, guest suite, domestic assistance and laundry.

The property is located within easy reach of some of the area's most beautiful beaches and unspoilt coastline. The nearby towns of New Milton and Christchurch have a wide range of amenities. More extensive facilities can be found further afield at Bournemouth.

- Assisted Living Development - Designed for over 65's
- Ideally located close to village centre/cliff top
- One double bedroom apartment with southerly aspect
- Residents' lounge, Function room, guest suite & restaurant
- 24-hour staffing and residents' parking
- Length of lease: 125 years (108 years remaining)
- Service charge £11,207.58 pa (September 2025)
- Ground rent £435.00 pa as at 21.11.24

EPC Rating Band: C
Council Tax Band: C

