



2, Middleton Mews, Barton on Sea, New Milton, BH25 7HU

£385,000

Mitchells
1963 — TODAY



*2 Middleton Mews
Barton on Sea
New Milton
Hampshire
BH25 7HU*

A rare opportunity to acquire this attractive cottage style, two double bedroom house that is situated in a select development built approximately 25 years ago. It offers bright and spacious accommodation, with features including a kitchen/dining room, a separate sitting room, a master bedroom with an en-suite shower room, parking, a garage, and a secluded garden.

- Entrance Hall
- Ground Floor Cloakroom
- Sitting Room
- Kitchen/Dining Room
- First Floor Landing
- Two Double Bedrms
- Family Bathroom
- En-Suite Shower Room
- Parking & Single Garage
- Secluded Garden



The Property

Entrance hall with stairs leading to the first floor landing, an electrical consumer unit, an understairs storage cupboard, and a central heating thermostat.

Ground floor cloakroom with a suite comprising a WC with a hidden cistern, a wash hand basin with storage beneath, a tiled splashback, and a radiator.

The kitchen/dining room overlooks the front and is fitted with shaker style timber effect wall and base units, a contrasting marble effect worktop, a stainless steel one and a half bowl sink with a mixer tap, a drainer, and a tiled splashback. Integrated appliances include a four burner gas hob with an extractor fan above and an eye level double oven. There is space and plumbing for a washing machine and an undercounter fridge, and a cupboard houses the recently fitted Worcester central heating boiler.

The sitting room is situated at the rear of the property, with an attractive outlook over the garden, double casement doors leading out to the patio, a large UPVC window, and a feature fireplace with a marble surround, marble hearth, and an inset living flame gas fire.

First floor landing with a hatch to the loft space, an airing cupboard housing the modern insulated hot water tank, and an additional storage cupboard.

The master bedroom is a generous double with built-in wardrobes, a walk-in storage cupboard, and an en-suite shower room.

The en-suite comprises a WC with a hidden cistern, a wash hand basin with storage beneath, a walk-in shower with sliding glass doors, fully tiled walls, and tile effect flooring.

Bedroom two is situated at the rear of the property, with two Velux windows with built-in blinds, a TV aerial point, ample plug sockets, and makes a lovely double bedroom.

The family bathroom is fitted with a suite comprising a panel bath with a tiled splashback, a wash hand basin with storage beneath, a WC with a hidden cistern, a UPVC window, a radiator, and a shaver point.





Gardens & Grounds

To the front of the property is a private parking bay.

Nearby is a generous single garage with a pitched tiled roof and parking to the front.

The rear garden is particularly private and secluded, enclosed by high level fencing, and features a generous patio area. The remainder of the garden is laid to lawn with mature beds and a summerhouse.

Services

Mains gas, electricity, water and drainage

Council Tax Band: C

Energy Performance Certificate (EPC) Rating:

Ground Floor

Approx. 44.1 sq. metres (474.3 sq. feet)

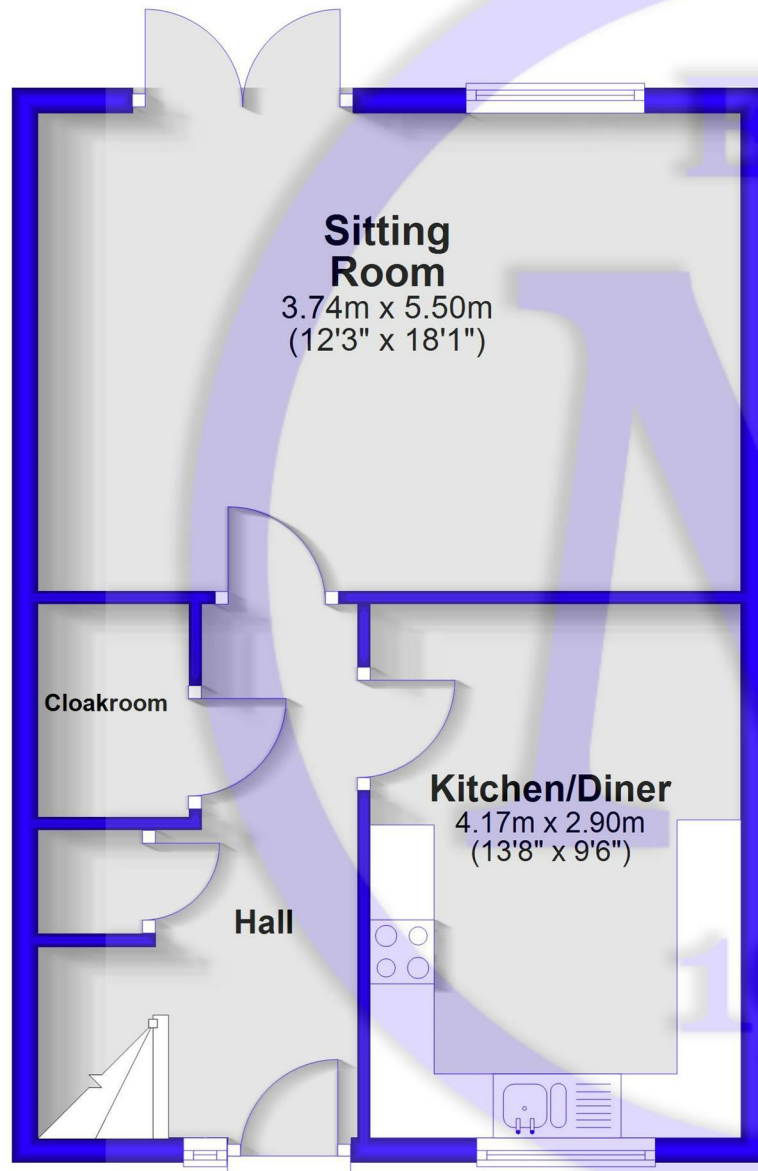

First Floor

Approx. 36.0 sq. metres (387.0 sq. feet)
(excluding Landing)

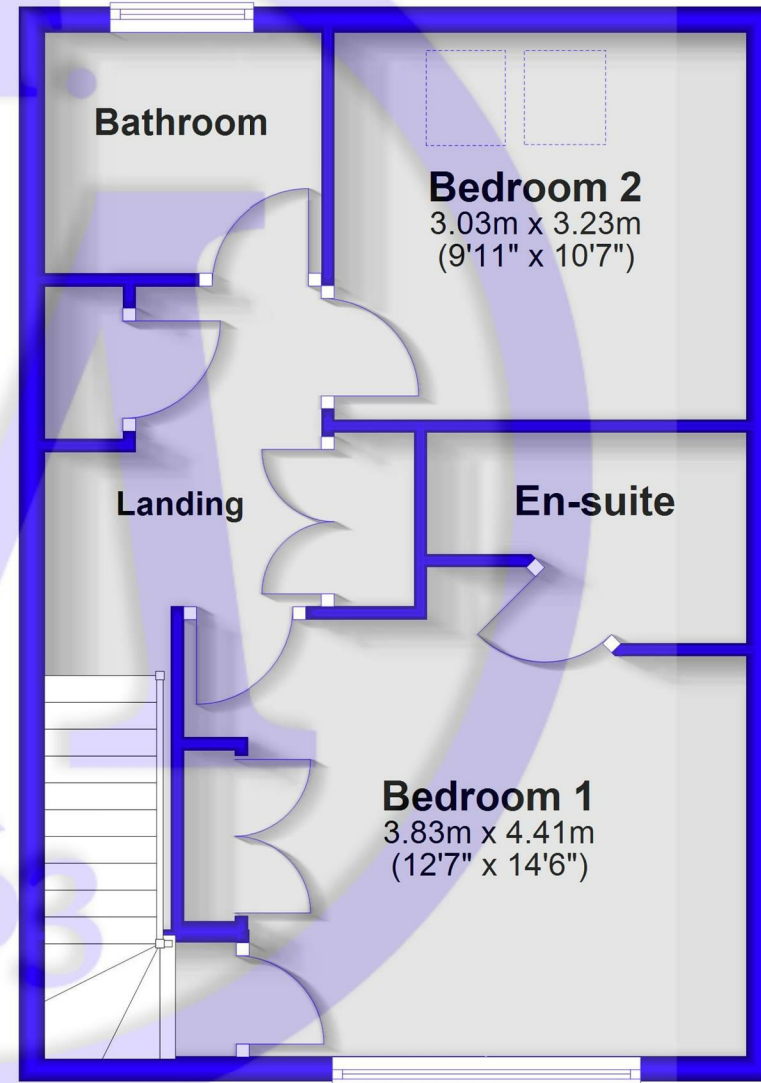

Total area: approx. 80.0 sq. metres (861.3 sq. feet)



Situation

Barton on Sea, a charming suburb of New Milton, enjoys a prime location along a picturesque stretch of the Solent coastline. With sweeping views across Christchurch Bay to the Isle of Wight and access to stunning coastal walks in both directions, it's a haven for nature lovers and outdoor enthusiasts. Its popularity is further enhanced by proximity to the open landscapes of the New Forest National Park, direct mainline rail links to London Waterloo, and a range of high-quality amenities. These include excellent schools, fine dining at the renowned Chewton Glen Hotel and Pebble Beach restaurant, and a 27-hole links-style golf course. Offering a perfect blend of natural beauty, convenience, and luxury, Barton on Sea continues to attract those seeking an exceptional coastal lifestyle.



Mitchells.uk.com
info@mitchells.uk.com
01425 616411

Centenary Buildings
8-10 Old Milton Road
New Milton
Hampshire
BH25 6DT

Mitchells
1963 — TODAY

