

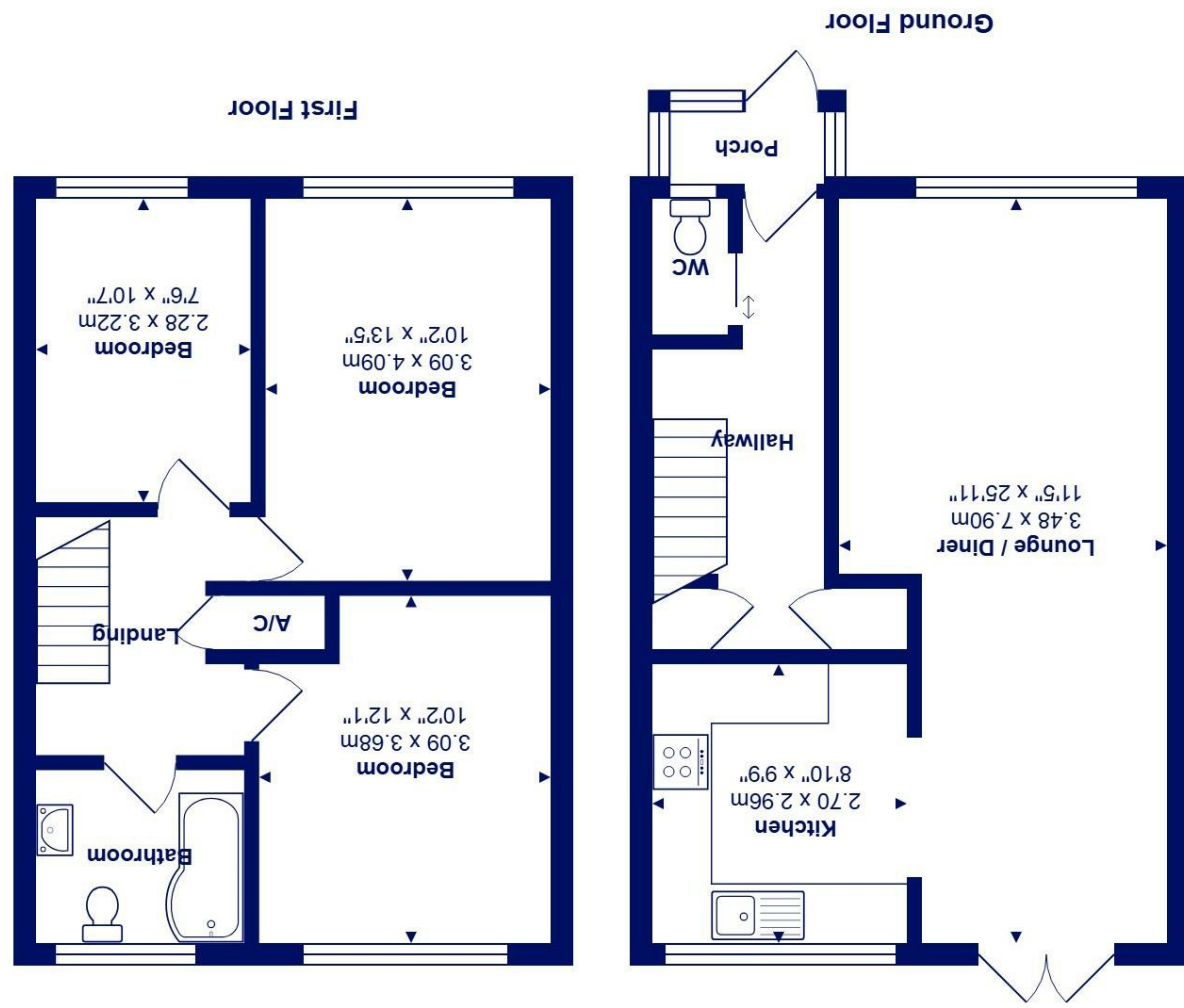

Total Area: 87.8 m² ... 945 ft²
All measurements are approximate and for display purposes only



11 Leyside, Christchurch, BH23 3RE

£365,000

Mitchells
1963 — TODAY

A spacious mid-terrace house of approximately 950 sq. ft., featuring three generous bedrooms, first floor family bathroom, downstairs w/c and open plan living accommodation.

The house is situated in this quiet, convenient position with private gardens to the rear and is within easy reach of the local shops, schools and bus routes.

- Mid-terrace house of approximately 950 sq. ft
- Three generous bedrooms
- Refitted first floor family bathroom
- Entrance hall with downstairs w/c
- Spacious lounge diner with patio doors onto the garden
- Modern open plan kitchen
- Driveway parking
- Private rear garden with storage shed
- Convenient position close to local amenities
- uPVC double glazing and Gas fired central heating

EPC Rating Band: C
Council Tax Band: C
Freehold

Successful buyers will be required to complete online identity checks provided by Lifetime Legal. The cost of these checks is £45 inc. VAT per purchase which is paid in advance, directly to Lifetime Legal. This check verifies your identity in line with our obligations as stipulated by our regulatory body, HMRC

