



*25, Chewton Meadow, Hoburne Naish Holiday*

*£100,000*

**Mitchells**  
1963 — TODAY



*25 Chewton Meadow  
Hoburne Naish Holiday  
Park  
Barton on Sea  
Hampshire  
BH25 7RA*

A fantastic opportunity to acquire this three bedroom, two bathroom holiday home, situated in a quiet cul-de-sac on the ever popular Hoburne Naish Holiday Park, within walking distance of all facilities. The holiday home features a large open plan kitchen and living area, three generously sized bedrooms, with the master benefiting from an en-suite shower room, a Jack and Jill bathroom, south facing decking, and allocated parking.

- License Until 30/11/2042
- 41 x 20 Victory Parkview 2017
- 2026 Site Fees: £9,195.63
- 2026 Rates: £700.31
- Second Home Only, Cannot Be Your Main Residence
- Open Plan Kitchen/Living Area
- Separate Utility
- Three Good Sized Bedrooms
- Family Bathroom & En-Suite Shower Room
- Allocated Parking & South Facing Decking



## The Property

Entrance into the utility room with tile effect flooring, cream wall and base units with a contrasting marble effect worktop, a stainless steel sink unit with a mixer tap and drainer, space for a washing machine, and a cupboard housing the gas fired central heating boiler.

The sitting room is generously sized, featuring its own fireplace with an electric fire, a pleasant dual aspect, and leads through to the kitchen/dining room.

The kitchen/dining room has tile effect flooring, sliding doors onto the south facing decking, a six seater dining table and chairs, a pleasant dual aspect, and a kitchen with modern cream wall and base units offering ample storage, and a contrasting marble effect worktop. There is a one and a half bowl stainless steel sink unit with mixer tap and drainer, a four burner gas hob, a raised electric oven, an integrated microwave and fridge/freezer, and a slimline dishwasher.

Bedroom one is a generous king sized room with matching bedside cabinets, a double wardrobe, dressing area, a wall mounted TV, and a door leading through to the en-suite shower room.

The en-suite has tile effect flooring and a modern white suite comprising a WC, a wash hand basin with a mixer tap over and storage beneath, a mirror fronted medicine cabinet above, an electric shaver point, a shower cubicle with a glass sliding door and a thermostatically controlled hand held shower attachment, and a ladder style heated towel rail.

Bedroom two is laid out as a generous twin room with a double wardrobe, matching chest of drawers, and a door leading through to the Jack and Jill bathroom.

The bathroom features tile effect flooring, a ladder style heated towel rail, a panel bath with a glass shower screen, a mixer tap and shower attachment, a WC, a wash hand basin with a mixer tap over and storage beneath, a wall hung mirror fronted medicine cabinet, and an electric shaver point.

Bedroom three is also arranged as a twin room, with a double wardrobe, a pleasant side facing outlook, a bedside cabinet, and a wall mounted TV aerial point.





## *Gardens & Grounds*

25 Chewton Meadow is just a short walk from the facilities at Hoburne Naish Holiday Park and benefits from two allocated parking spaces, as well as generous south facing decking to the front, providing an ideal area for outdoor entertaining.

## *Site Fees & Charges*

Annual Site Fee:  
Rates:  
Licence Valid Until:

## Floor Plan

Approx. 76.4 sq. metres (822.5 sq. feet)

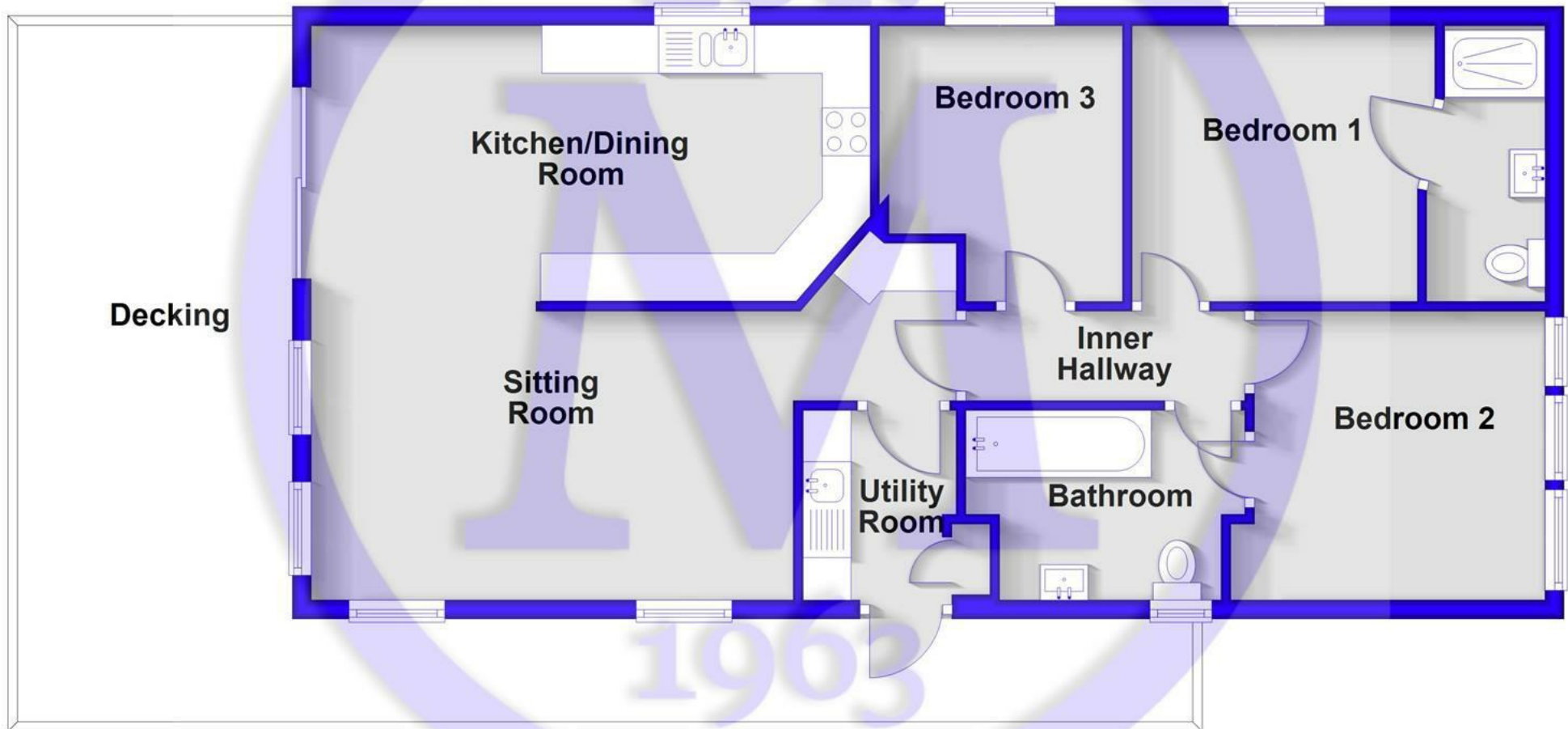

Total area: approx. 76.4 sq. metres (822.5 sq. feet)

## Situation

Hoburne Naish Holiday Park is set in a stunning clifftop location, offering breathtaking views of the Dorset coastline. The park provides direct access to beautiful beaches, scenic coastal walks, and is within easy reach of the picturesque New Forest National Park. On-site, you'll find excellent facilities including a heated indoor and outdoor pool, adventure golf, a fitness suite, a multi-use games area, and a restaurant and bar. The park also hosts a vibrant entertainment complex, offering a variety of events and activities throughout the year. Perfect for those seeking relaxation and adventure, Hoburne Naish offers an exceptional lifestyle in a tranquil yet well-connected setting.

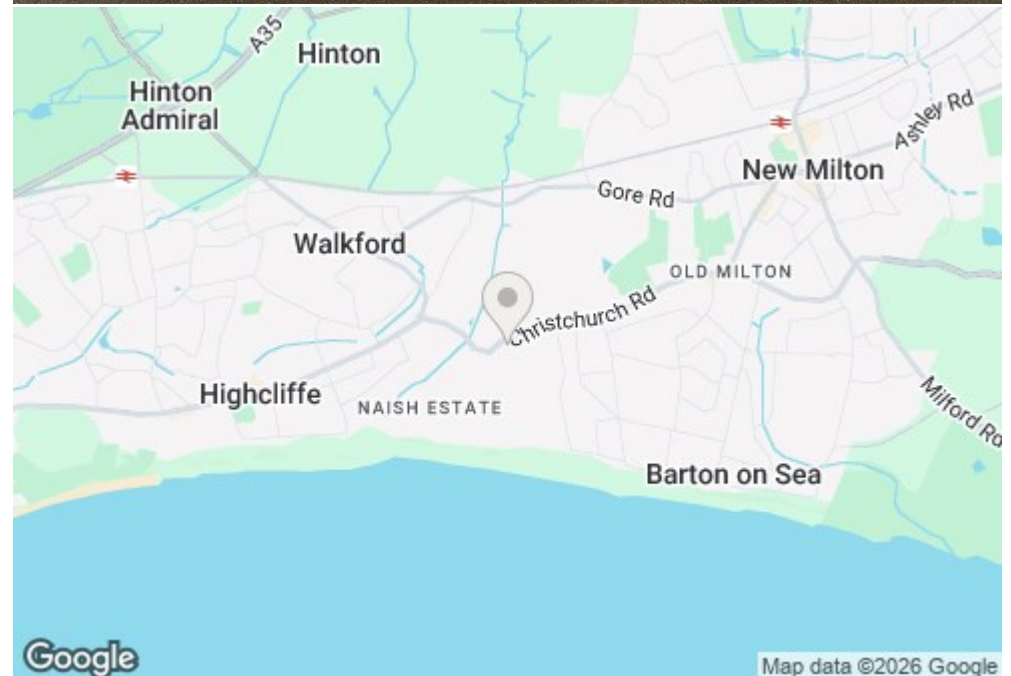



[Mitchells.uk.com](http://Mitchells.uk.com)  
[info@mitchells.uk.com](mailto:info@mitchells.uk.com)  
01425 616411

Centenary Buildings  
8-10 Old Milton Road  
New Milton  
Hampshire  
BH25 6DT

**Mitchells**  
1963 — TODAY

