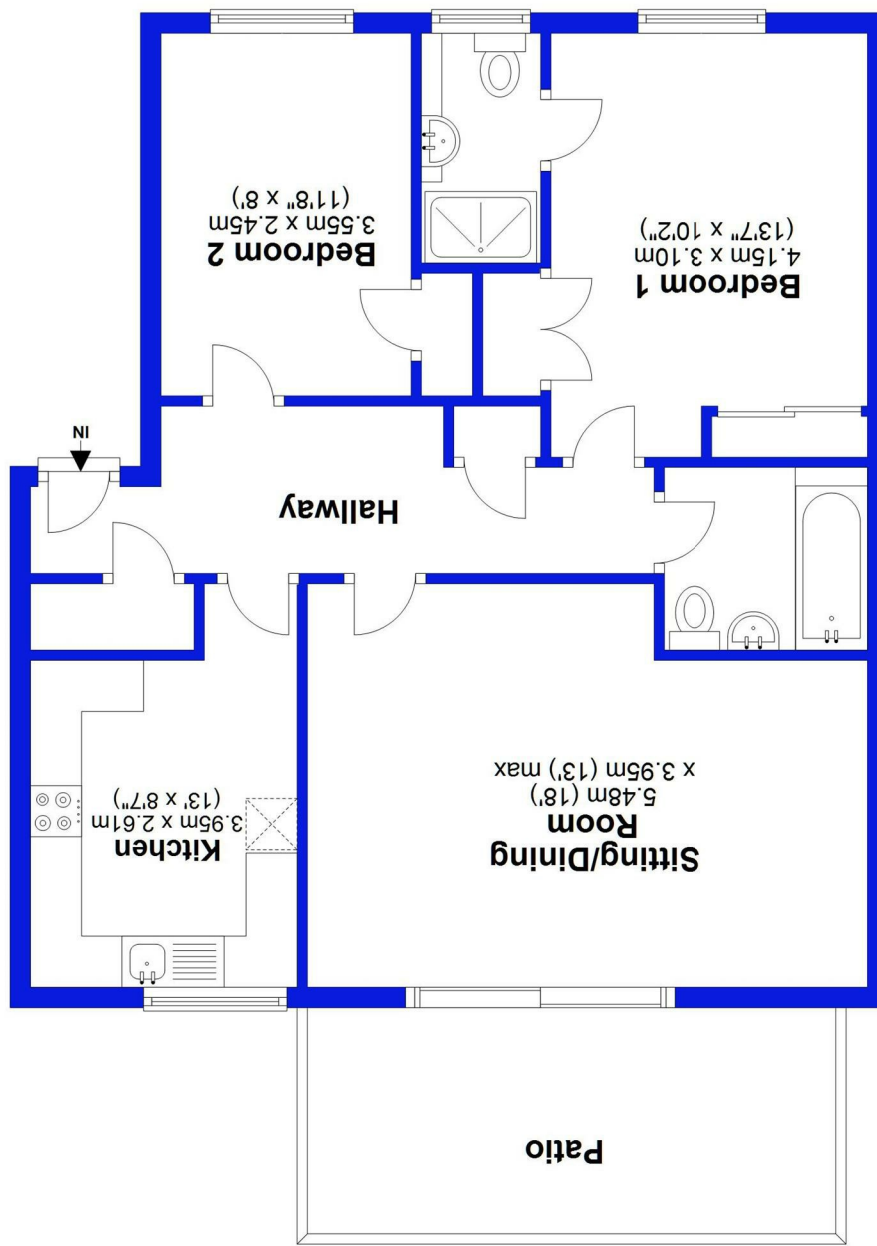

Illustration for identification purposes only; measurements are approximate, not to scale. EPC New Forest
Plan produced using PlanUp.



Ground Floor
Approx. 71.1 sq. metres (764.8 sq. feet)



Waterford Place, Christchurch BH23 5LG

£325,000

Mitchells
1963 — TODAY

Arguably the best position on this highly acclaimed development- a superb GROUND FLOOR APARTMENT with DIRECT ACCESS TO SOUTH FACING GARDENS, approx. 765 sqft of accommodation and in first class condition throughout.

- Purpose built ground floor apartment
- Excellent condition with modern fittings throughout
- Two double bedrooms both with fitted wardrobes
- South facing sitting/dining room with patio doors onto the gardens
- Gas fired central heating and UPVC double glazing
- Garage adjoining the apartment with LIGHT AND POWER, casual parking
- Shared freehold, balance of 999 year lease, service charge £780 per half year
- Wonderful quiet position- an excellent proposition



EPC Rating Band: D

Council Tax Band: C

