



*27 Mundeford Lane, Dorset BH23 3HN*

*£425,000*

**Mitchells**

1963 — TODAY



## *Mudeford Lane, Dorset*

A two bedroom detached bungalow of approximately 745 sq ft located in a highly sought after part of Mudeford, moments from Mudeford Quay, Stanpit Nature Reserve and Avon Beach. This lovely home benefits form a large driveway, south-west facing rear garden and is presented in good order throughout.



## The Property

- Detached two bedroom bungalow of 745 sq ft
- Two double bedrooms
- Modern family bathroom
- Spacious 24ft sitting/dining room with access to the garden
- Fitted kitchen with access to a utility room
- Driveway parking for several cars
- South-west facing rear garden with storage sheds
- Gas fired central heating and uPVC double glazed windows
- Close to Mundeford Quay, Stanpit Nature Reserve, Avon Beach and Christchurch Town Centre
- Vacant possession





Location



# GROUND FLOOR

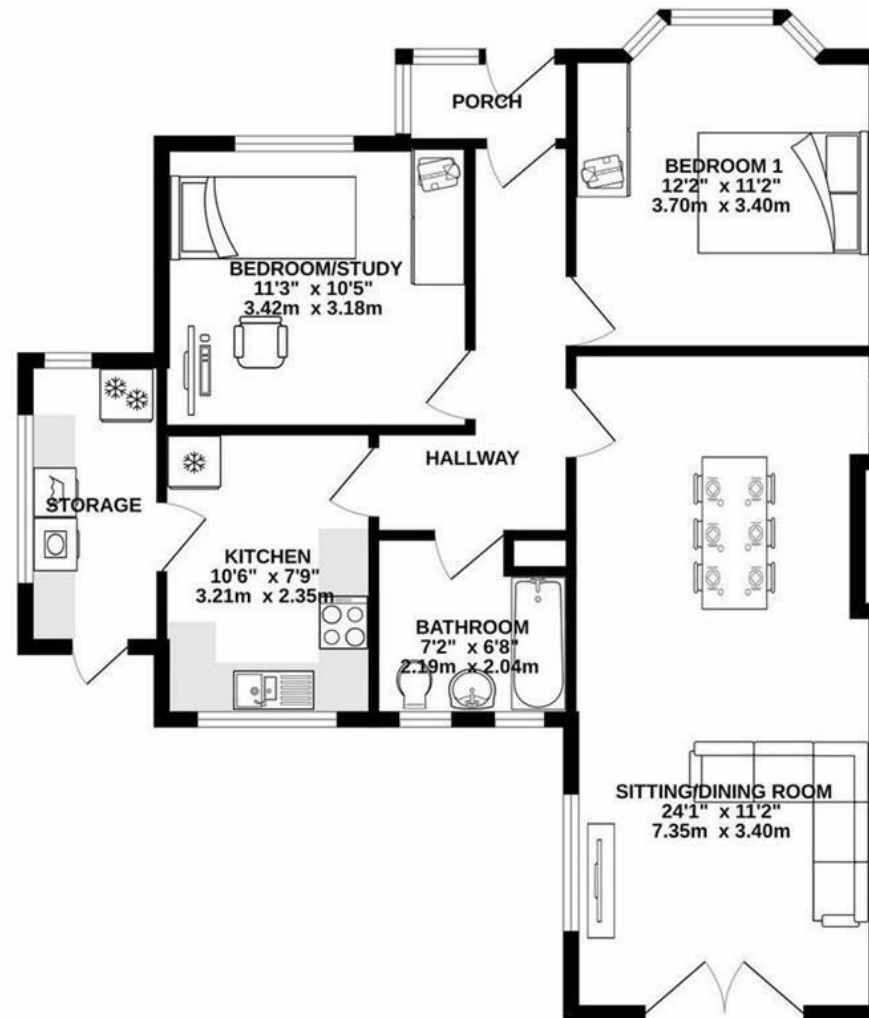

Whilst every attempt has been made to ensure the accuracy of the floorplan contained here, measurements of doors, windows, rooms and any other items are approximate and no responsibility is taken for any error, omission or mis-statement. This plan is for illustrative purposes only and should be used as such by any prospective purchaser. The services, systems and appliances shown have not been tested and no guarantee as to their operability or efficiency can be given.  
Made with Metropix ©2024



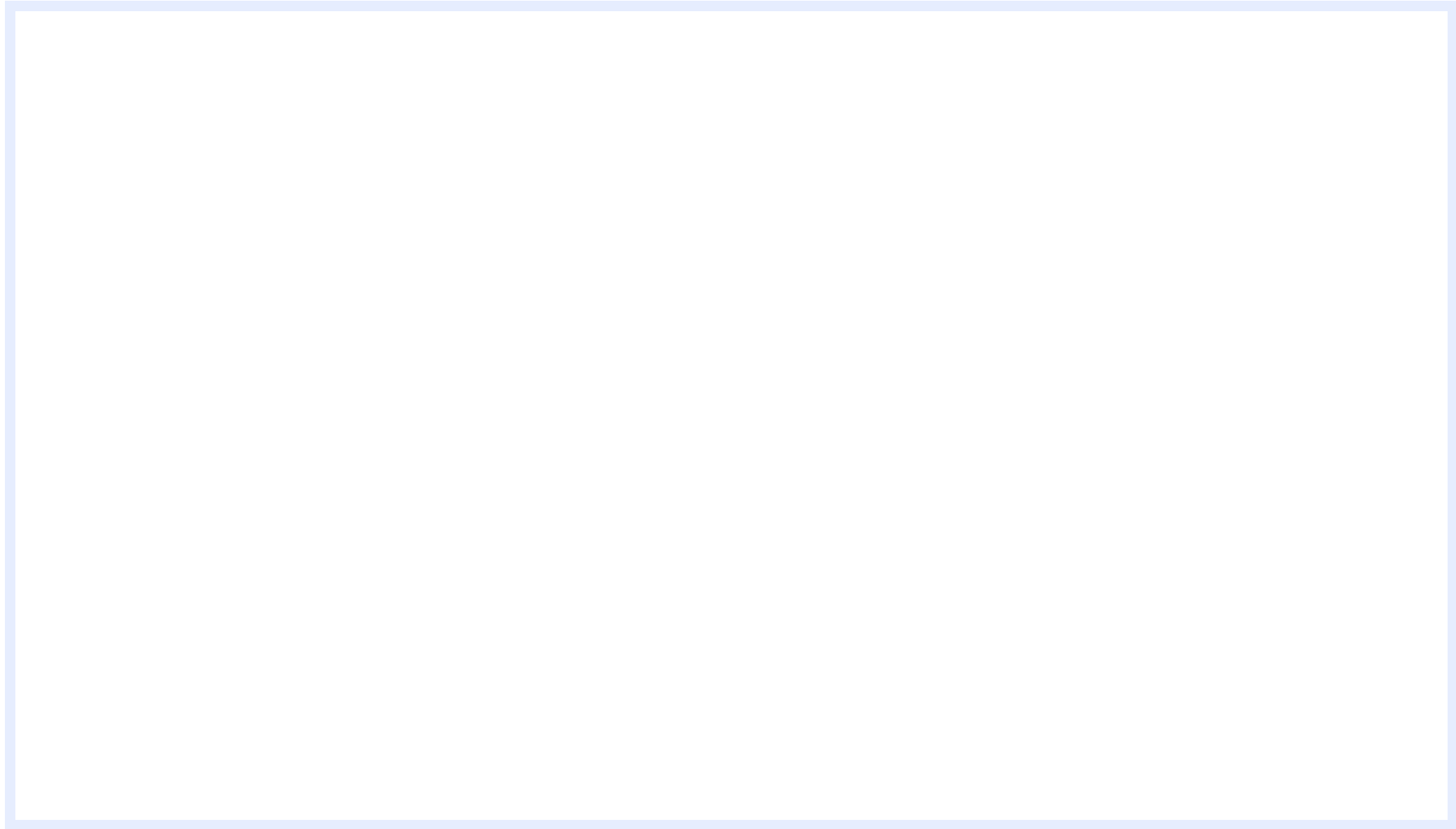

---

[www.mitchells.uk.com](http://www.mitchells.uk.com)  
[Mundeford@mitchells.uk.com](mailto:Mundeford@mitchells.uk.com)  
01202 499295

Mundeford  
112-114 Cambridge House Stanpit  
Christchurch  
BH23 3ND

