

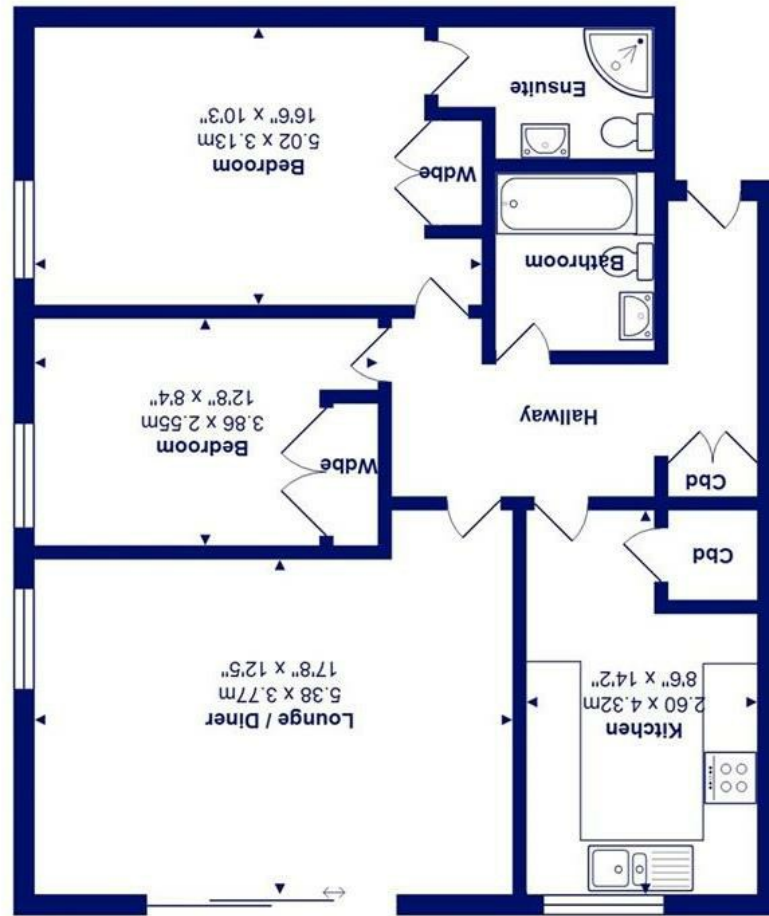

Total Area: 77.2 m² ... 831 ft²
All measurements are approximate and for display purposes only



58 Montagu Park Waterford Place, Highcliffe On Sea BH23

£269,950

Mitchells
1963 — TODAY

This two double bedroom apartment is located on the forever sought after Montagu Park development, superb location within a short level walk of both Highcliffe beach and the high street. This property includes a spacious garage, located near your front door.

- Well presented throughout and kept immaculately
- Two double bedroom first floor apartment
- Two bathrooms, including an en-suite to the master bedroom
- Large lounge with south facing Juliette balcony
- Lots of storage including built in wardrobes in both bedrooms
- Allocated garage and additional communal parking bays
- Short walk to the beach and the shops
- Southerly outlook over the pleasant communal gardens from the principal rooms
- Share of freehold, thus no ground payable
- Maintenance approx £1600pa

EPC Rating Band: C
Council Tax Band: C

