



12 Woodfield Gardens, Christchurch BH23 4QA

£547,000

Mitchells

1963 — TODAY



Woodfield Gardens, Christchurch

An immaculate property that had been thoroughly refurbished/ extended in recent years. The detached bungalow in a smart contemporary style with accommodation approaching 1200sqft.



The Property

- Spacious three bedroom detached bungalow
- Two smart bath/shower rooms
- Stylish open plan kitchen/dining/living room with access onto the garden
- Large second reception room perfect as a another sitting room
- A lovely sunny south facing easily maintained rear garden
- Gas fired central heating & upvc double glazing
- Off road parking for several cars
- Walking distance to Wingfields recreation ground and the local shops at Saulflands
- Hinton Admiral main line railway station is just around the corner
- Highcliffe school catchment area





Location



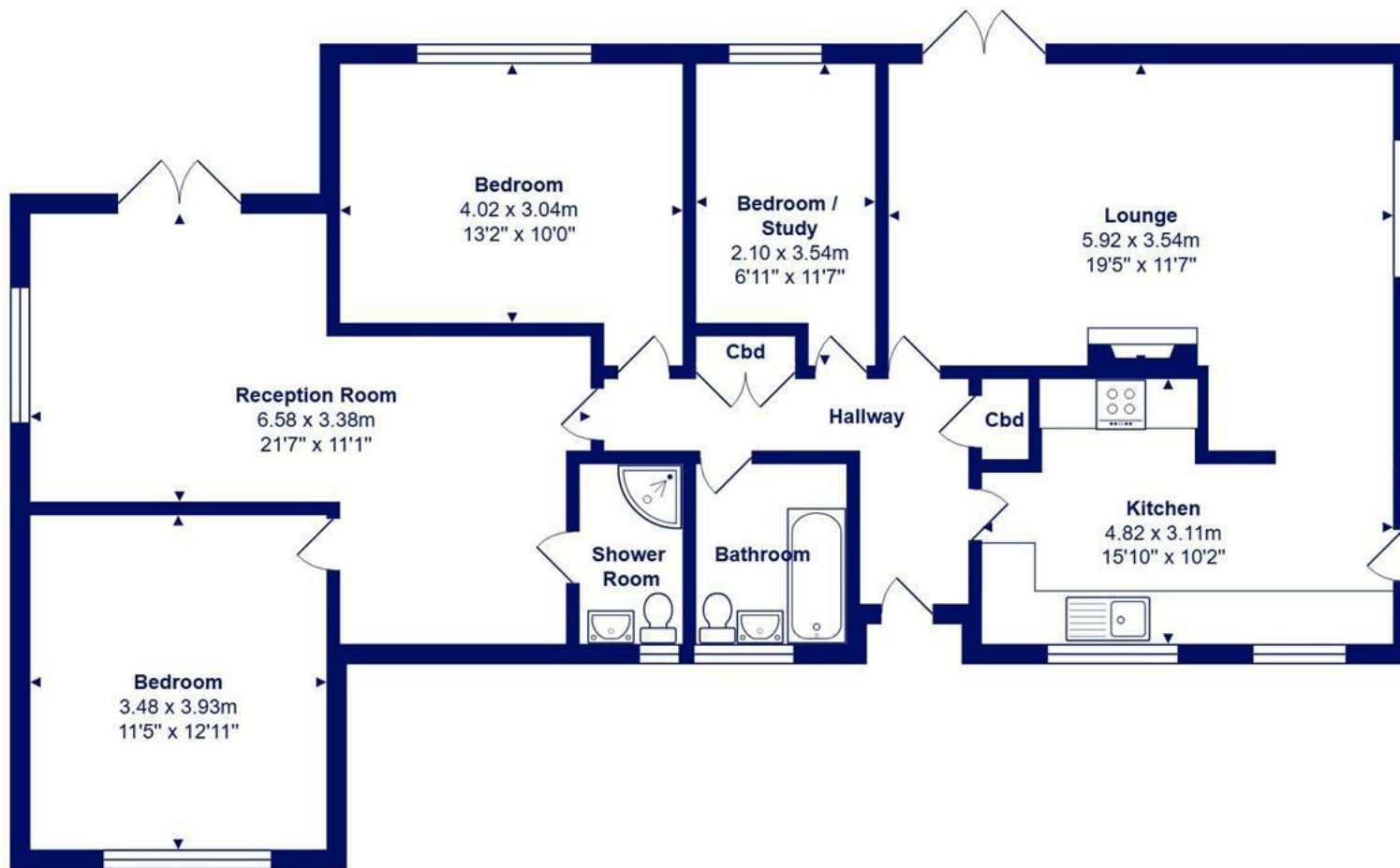

Total Area: 110.2 m² ... 1186 ft²

All measurements are approximate and for display purposes only





www.mitchells.uk.com
Highcliffe@mitchells.uk.com
01425 272206

Highcliffe
284 Lymington Road
Highcliffe
Christchurch
BH23 5ET

