



151 Mundeford Lane, Christchurch BH23 3HR

£199,950

Mitchells

1963 — TODAY



Mundeford Lane, Christchurch

A very smart one bedroom ground floor flat in the heart of Mundeford just a few hundred yards from the historic Mundeford Quay and the beach.



The Property

- Ground floor apartment in superb position
- Double bedroom with fitted wardrobes
- Open plan kitchen/living room with access onto a private patio
- South facing communal grounds and gardens
- Single garage in a block
- Fantastic location right in the heart of this bustling area
- Shared Freehold
- Maintenance approx. £600 per half year
- Security entry phone system
- Offered for sale with no forward chain





Location



Internal Floor Area

Approx. 40.1 sq. metres (431.2 sq. feet)

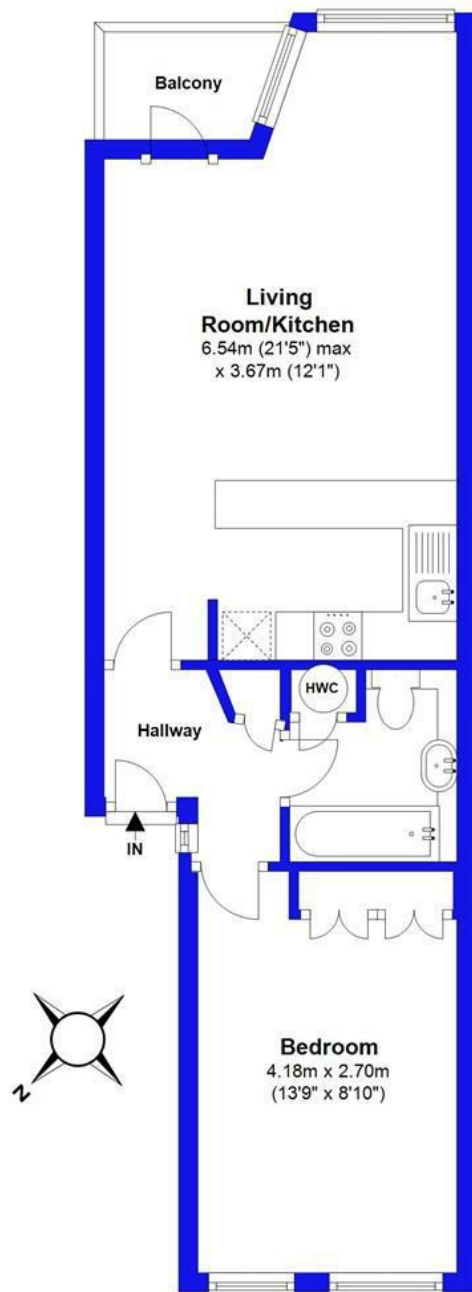

Illustration for identification purposes only; measurements are approximate, not to scale. EPC New Forest Plan produced using PlanUp.





www.mitchells.uk.com
Mundeford@mitchells.uk.com
01202 499295

Mundeford
112-114 Cambridge House Stanpit
Christchurch
BH23 3ND

