

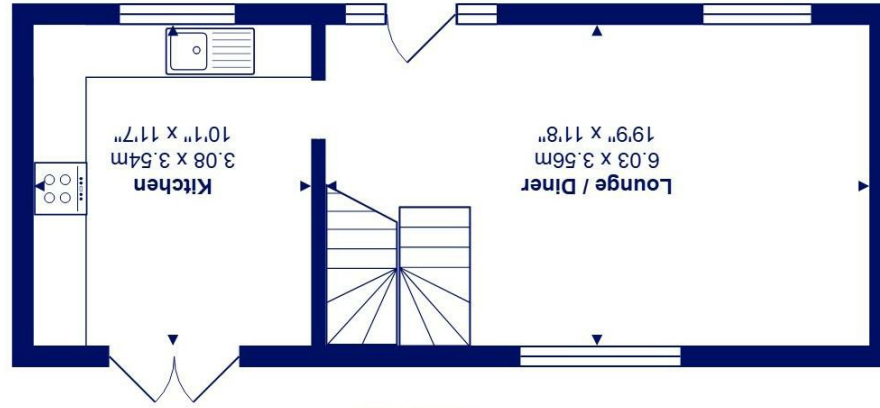

All measurements are approximate and for display purposes only  
Total Area: 70.8 m<sup>2</sup> ... 762 ft<sup>2</sup>



Ground Floor



First Floor

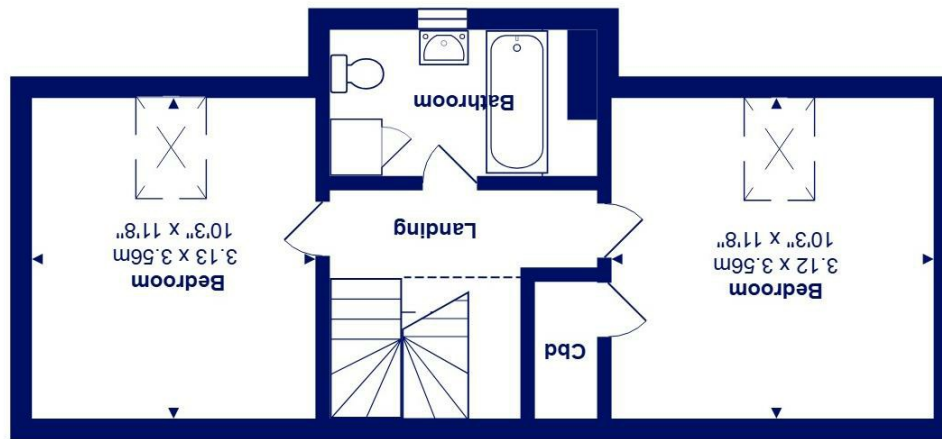

*The Old Dairy, 82 Mudeford, BH23 4AS*

*£475,000*

**Mitchells**  
1963 — TODAY

Part of Mudeford's history! With origins reputedly dating from the 1800s as part of Mudeford Farm, this charming detached character property was professionally converted to residential in 2008 and now offers about 770 sqft of accommodation.

Tucked away in the heart of Mudeford, within a "stone's throw" of the harbour and just a short level walk from the historic quay and the sandy beaches. A very rare opportunity to acquire such an individual property in this fabulous location.

- Charming detached property of approx 770 sqft
- NO FORWARD CHAIN
- Delightful secluded location
- Easily maintained courtyard style rear garden
- Off road parking for 2 / 3 vehicles and or boat storage
- 2 Double bedrooms and modern bathroom
- Attractive brick elevations and slate roof
- Lovely dual aspect living room with feature stairs
- Good size, well fitted kitchen / breakfast room
- Close to local shops

EPC Rating Band: D

Council Tax Band: D

Freehold

Successful buyers will be required to complete online identity checks provided by Lifetime Legal. The cost of these checks is £45 inc. VAT per purchase which is paid in advance, directly to Lifetime Legal. This check verifies your identity in line with our obligations as stipulated by our regulatory body, HMRC

