

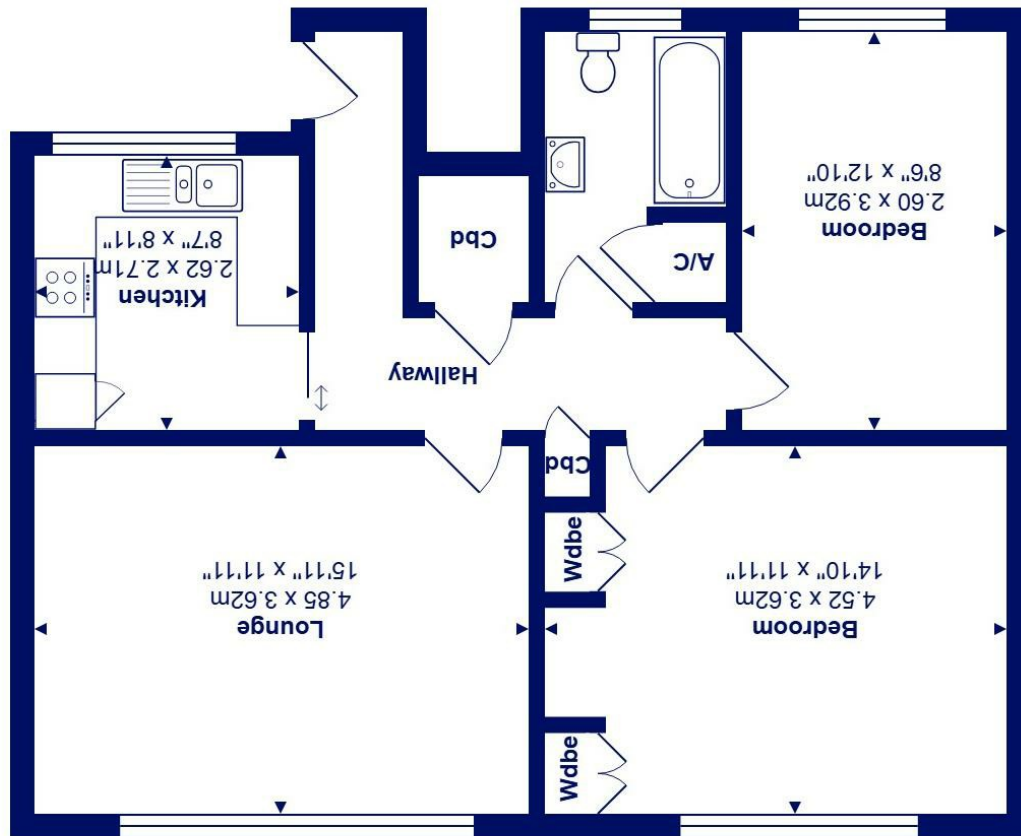

Total Area: 68.7 m² ... 739 ft²
All measurements are approximate and for display purposes only



15 Burnside, Highcliffe on Sea, BH23 4QZ £268,000

Mitchells
1963 — TODAY

An immaculate, ground floor flat with a delightful outlook over the manicured gardens and grounds in a very peaceful location close to the local shops and bus connections. Comprehensively refurbished and offering about 740 sq ft of bright and airy living space, the flat also has an extended lease and a garage.

- Purpose built ground floor flat in a tranquil yet convenient setting
- Two spacious double bedrooms
- Refitted bathroom with quality sanitary ware and designer tiling
- Contemporary refitted kitchen with some integrated appliances
- Large lounge/dining room with picture window overlooking the gardens
- Gas fired central heating and UPVC double glazing
- Casual parking, garage and a short stroll to the local shops
- Balance of 125 year lease, about 109 remaining, service charge £2134 p.a., ground rent £250 p.a.

EPC Rating Band: C
Council Tax Band: B
Leasehold

