



52 Wharncliffe Road, Christchurch BH23 5DF

£295,000

Mitchells

1963 — TODAY



Wharncliffe Road, Christchurch

A superb, top floor (NO LIFT) balcony apartment on the front line at Highcliffe on Sea with stunning coastal views over Christchurch Bay to the Isle of Wight. This is one of the larger designs in Exeter Court with the living space totalling about 870sqft and both the lounge and dining room looking out to sea.



The Property

- Fantastic location on the cliff top, right by the slope that leads down to the beach.
- Short level stroll to the bustling village centre, bus connections, independent shops/restaurants
- Security entry phone system
- Two spacious double bedrooms
- Kitchen big enough to eat in
- South facing living rooms (dining room could be bed 3 if required) and balcony
- Lots of built in storage, parking and a garage
- Service charge £657 per quarter (includes contributions to reserve fund)
- Quick possession available
- Council Tax





Location



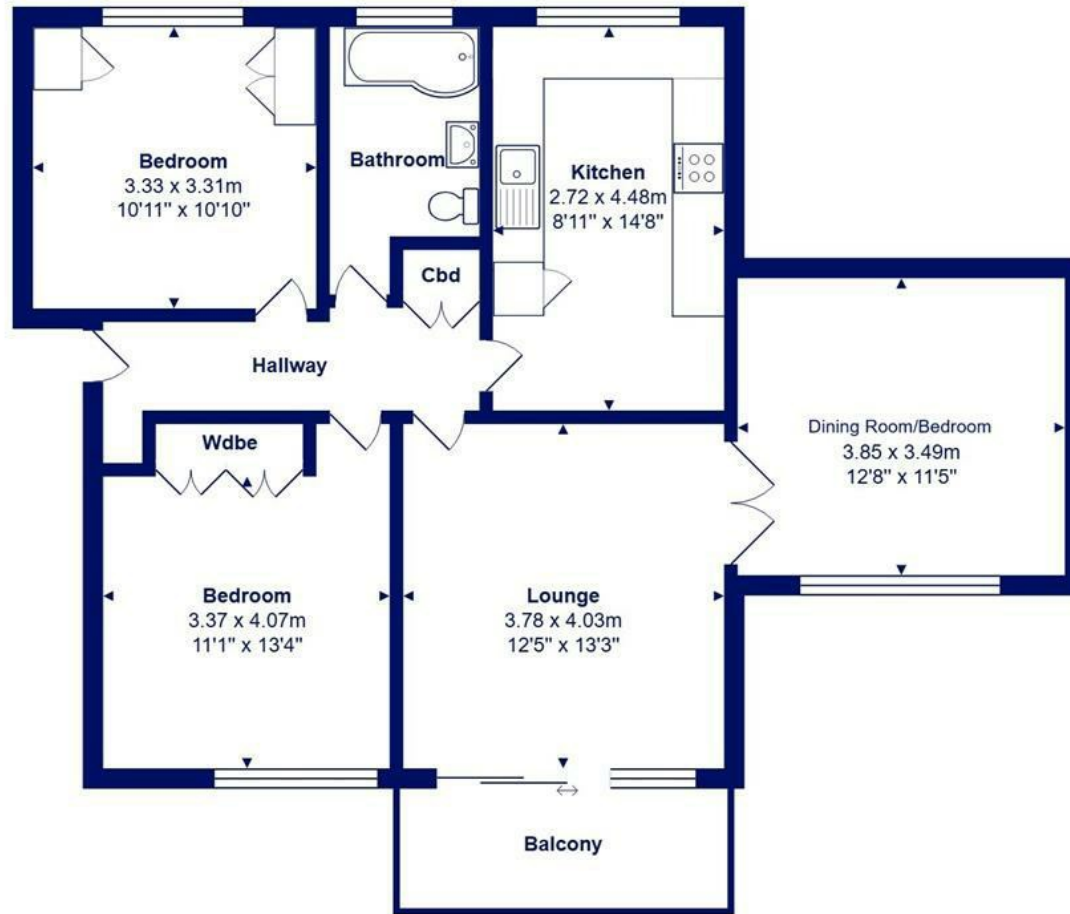

Total Area: 80.5 m² ... 866 ft² (excluding balcony)

All measurements are approximate and for display purposes only







www.mitchells.uk.com
Highcliffe@mitchells.uk.com
01425 272206

Highcliffe
284 Lymington Road
Highcliffe
Christchurch
BH23 5ET

