

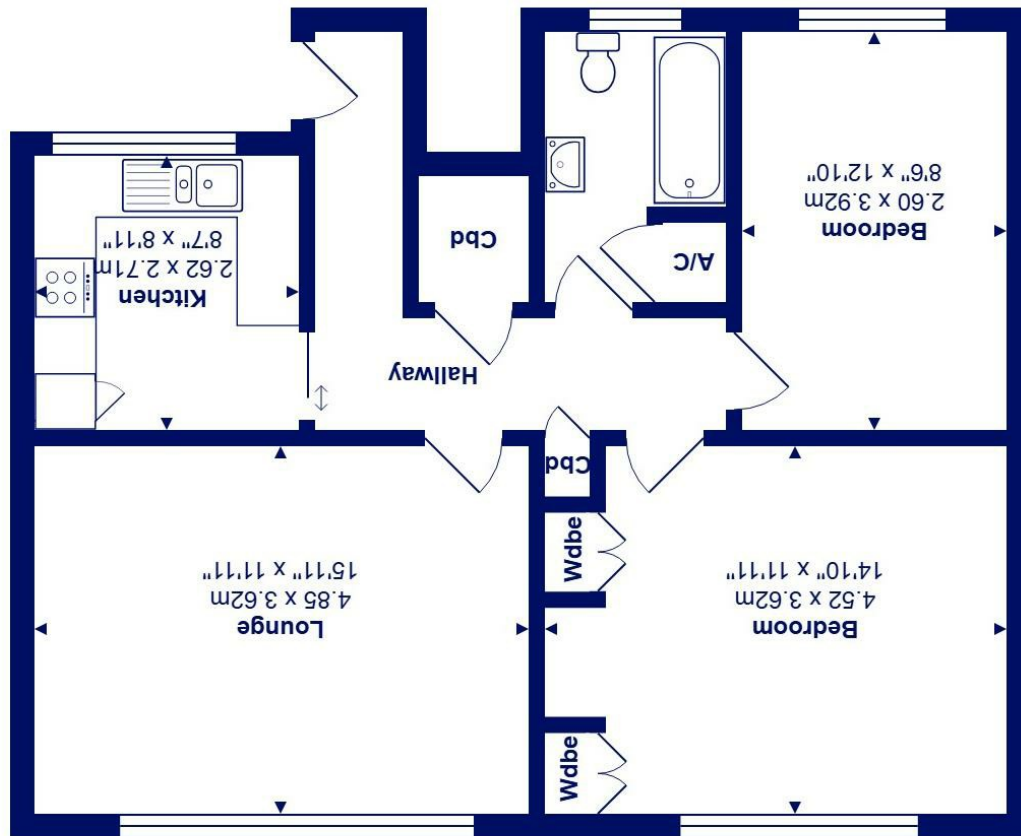

All measurements are approximate and for display purposes only  
Total Area: 68.7 m<sup>2</sup> ... 739 ft<sup>2</sup>



15 Burnside, Highcliffe on Sea, BH23 4QZ £268,000

**Mitchells**  
1963 — TODAY

An immaculate, ground floor flat with a delightful outlook over the manicured gardens and grounds in a very peaceful location close to the local shops and bus connections. Comprehensively refurbished and offering about 740 sq ft of bright and airy living space, the flat also has an extended lease and a garage.

These purpose built flats have always been incredibly popular being in just small blocks of just four, with private entrances. The current owner has carefully updated the flat and it now features stylish fittings and a tasteful decor.

- Purpose built ground floor flat in a tranquil yet convenient setting
- Two spacious double bedrooms
- Refitted bathroom with quality sanitary ware and designer tiling
- Contemporary refitted kitchen with some integrated appliances
- Large lounge/dining room with picture window overlooking the gardens
- Gas fired central heating and UPVC double glazing
- Casual parking, garage and a short stroll to the local shops
- Balance of 125 year lease, about 109 remaining, service charge £2134 p.a., ground rent £250 p.a.

EPC Rating Band: C  
Council Tax Band: B  
Leasehold

Successful buyers will be required to complete online identity checks provided by Lifetime Legal. The cost of these checks is £45 inc. VAT per purchase which is paid in advance, directly to Lifetime Legal. This check verifies your identity in line with our obligations as stipulated by our regulatory body, HMRC

