

All measurements are approximate and for display purposes only

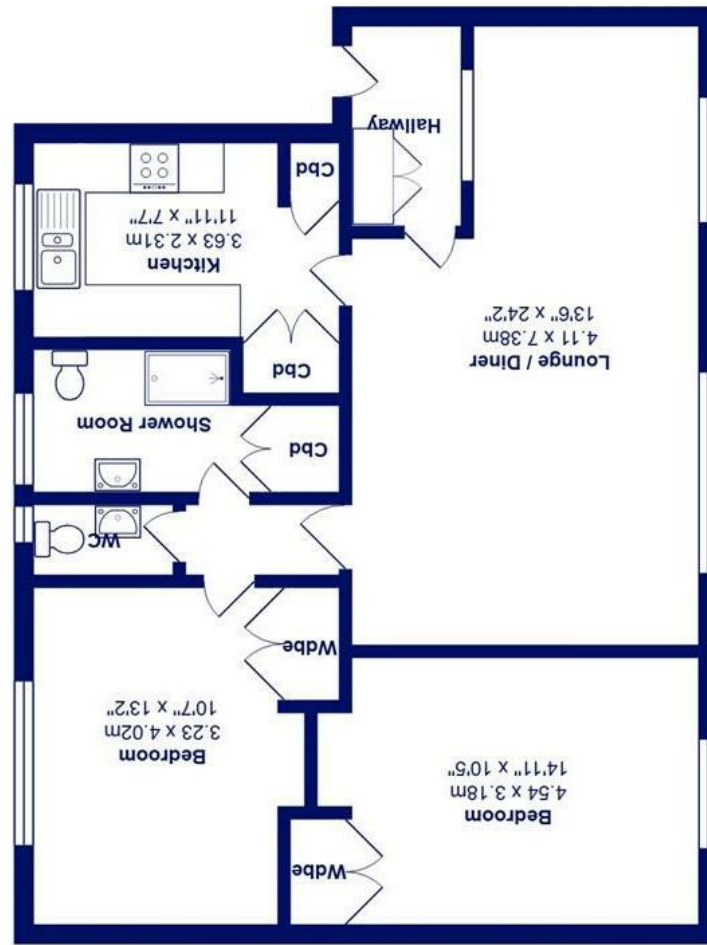

Total Area: 79.4 m² ... 855 ft²



24 High Pines, St Georges Close, BH23 4LN

£239,000

Mitchells
1963 — TODAY

A well presented ground floor flat with a lovely west facing, raised balcony, offered for sale with no forward chain and an extended lease. The accommodation extends to about 860 sq ft with a spacious living room and two double bedrooms. Quick possession available.

- Purpose built, ground floor flat of about 860 sq ft
- Two spacious double bedrooms both with fitted wardrobes
- West facing living room with access to the raised balcony
- Shower room with w/c and separate w/c
- Modern kitchen and electric heating
- Access to the communal gardens
- Lease- about 135 years remaining, expires 24th Dec 2160, service charge £1980.44 p.a, ground rent £150 p.a.
- No forward chain

EPC Rating Band: D

Council Tax Band: C

Leasehold

Successful buyers will be required to complete online identity checks provided by Lifetime Legal. The cost of these checks is £45 inc. VAT per purchase which is paid in advance, directly to Lifetime Legal. This check verifies your identity in line with our obligations as stipulated by our regulatory body, HMRC

