



All measurements are approximate and for display purposes only
Total Area: 99.0 m² ... 1065 ft²



Ground Floor



First Floor

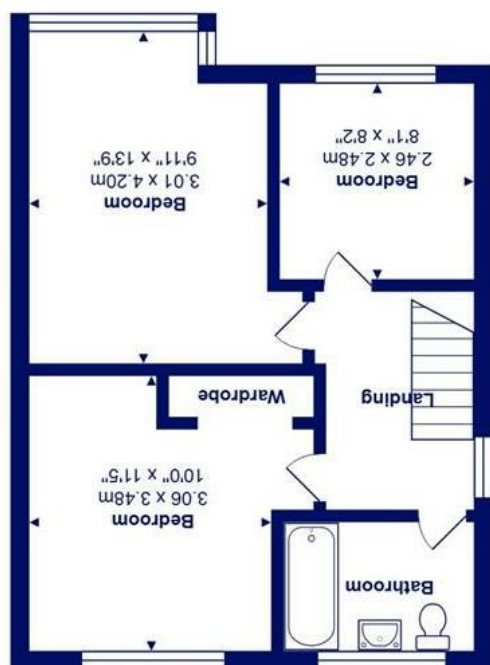

27 Blackberry Lane, Christchurch, BH23 3QZ

£399,950

Mitchells
1963 — TODAY

A very smart and extended, semi-detached freehold house of about 1065 sq ft featuring a lovely kitchen/dining room, modern family bathroom and three double bedrooms.

Quietly situated with a lovely garden and no passing traffic, the house is just a short stroll from the excellent local schools with local shops just around the corner.

- Excellent family home in superb condition
- Three first floor double bedrooms
- Modern family bathroom
- Stylish and recently fitted open plan kitchen/dining/utility room with access onto the garden
- Extended lounge with bay window
- Good size rear garden
- Gas central heating and uPVC double glazing
- Catchment area for both Mudeford Infant and Junior Schools
- Plenty of casual parking nearby

EPC Rating Band: C
Council Tax Band: C
Freehold

