

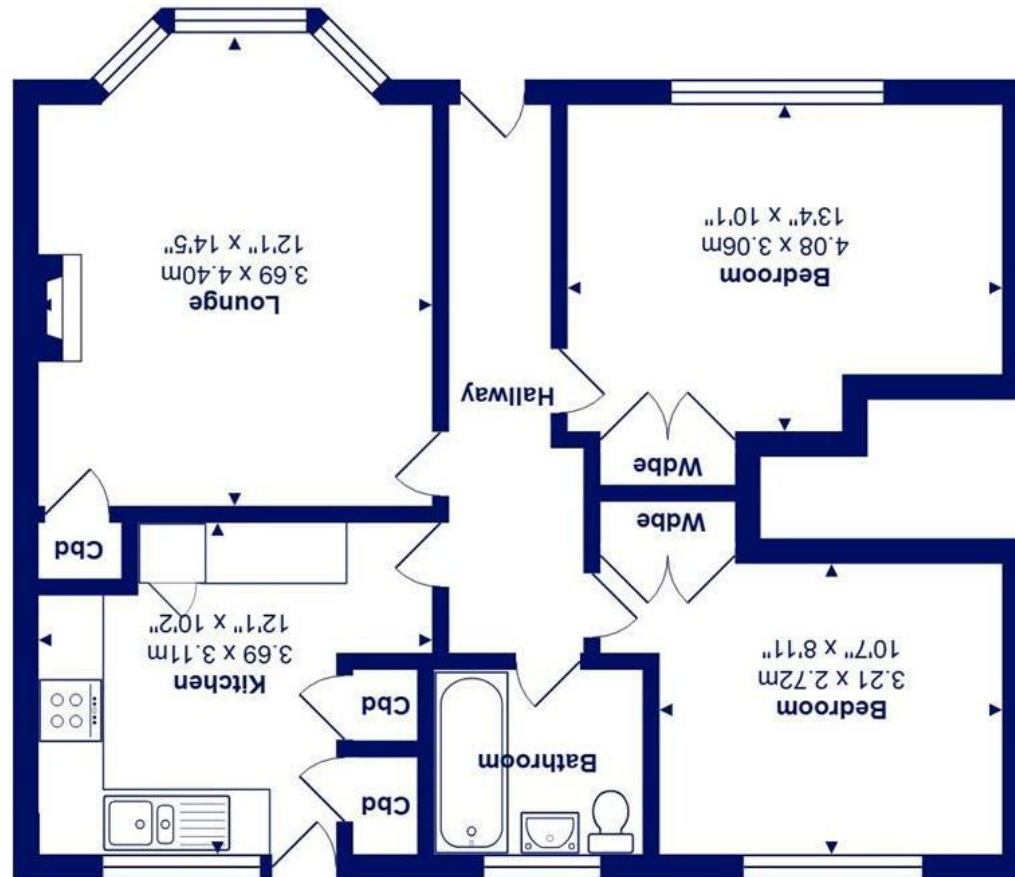

All measurements are approximate and for display purposes only  
Total Area: 60.9 m<sup>2</sup> ... 656 ft<sup>2</sup>



130 Lymington Road, Highcliffe On Sea, BH23 4JZ

£269,000

**Mitchells**  
1963 — TODAY

A large and unique ground floor garden apartment of approximately 650sqft with its own private front entrance, rear access from the kitchen and a private, sunny south facing front garden and a share of the freehold.

- Two double bedrooms both with fitted storage
- Private front and rear entrance
- Kitchen with some integrated appliances and room for table & chair
- Good size lounge with attractive outlook
- Fully tiled bathroom
- South facing private front garden
- Garage in a block
- Two workshop/sheds
- Situated in this fantastic location just a short walk to beach via footpaths, the village centre is approx half a mile with a variety of shops and eateries
- Maintenance charge £655 per 1/2 year inc reserve fund

EPC Rating Band: D  
Council Tax Band: B  
Share of Freehold

