

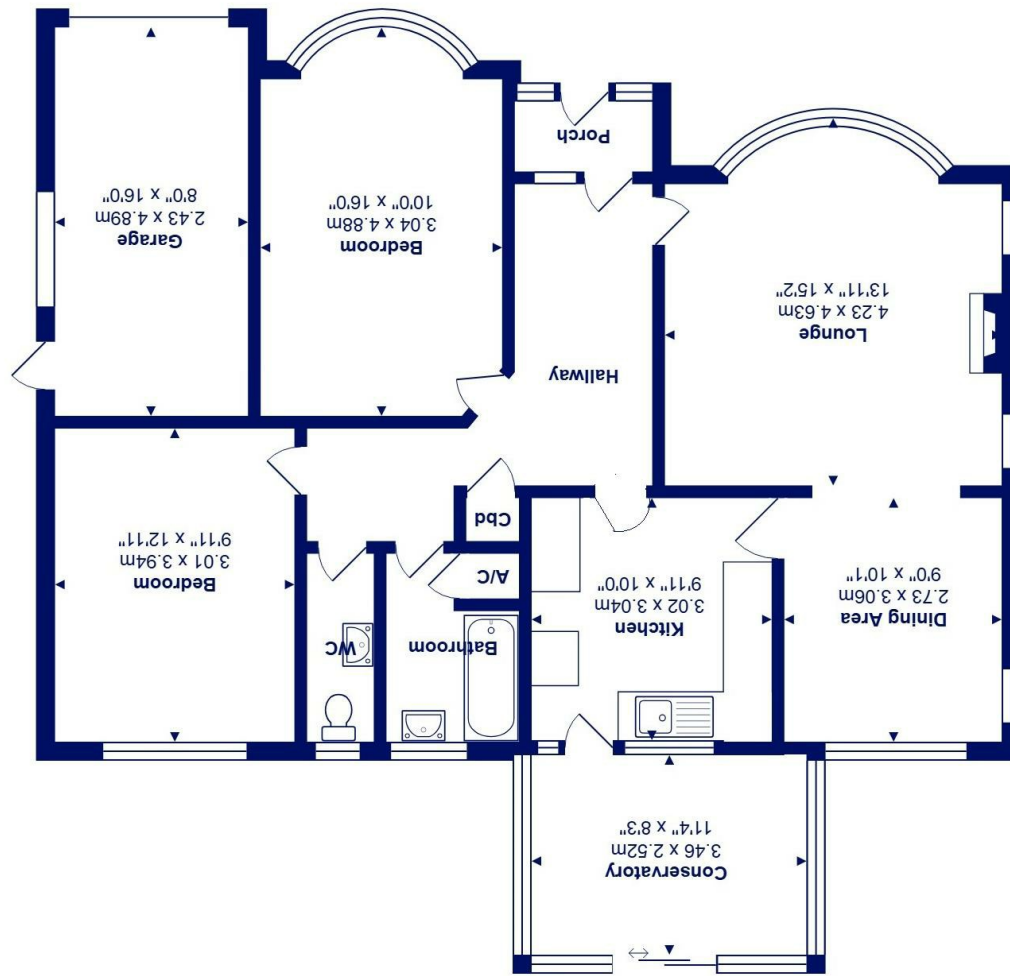

Total Area: 93.1 m² ... 1002 ft² (excluding garage)
All measurements are approximate and for display purposes only



6 Ridgfield Gardens, Highcliffe On Sea, BH23 4QG

£464,500

Mitchells
1963 — TODAY

A delightful two double bedroom detached character bungalow of just over 1000sqft, with pleasing facing brick elevations, located in this sought after residential area.

- Dual aspect though sitting/dining room
- Feature fireplace
- UPVC conservatory extension
- Modern Kitchen & bathroom
- Gas CH & UPVC double glazing
- Garage and off-road parking
- Well stocked gardens with some mature shrubs
- South facing suntrap rear garden
- Large loft space
- Potential to improve/extend/personalise

EPC Rating Band: D
Council Tax Band: D
Freehold

