



*3 Sycamore, Hoburne Bashley Holiday Park, BH25 5QR*

*£88,500*

**Mitchells**  
1963 — TODAY



*3 Sycamore  
Hoburne Bashley  
Holiday Park  
New Milton  
Hampshire  
BH25 5QR*

A beautifully presented two bedroom Carnaby Glenmore, situated on an exceptional pitch within the popular Hoburne Bashley Holiday Park. This holiday home features two decking areas, including a hot tub with views over the adjoining paddocks, a spacious open plan kitchen and living area, two generous bedrooms, bedroom one benefiting from an en-suite, a family bathroom, two allocated parking spaces, and a long remaining license.

- 2022 Carnaby Glenmore 40x13
- License Ends 31/10/2042
- Second Home Only
- Cannot Be Main Residence
- 2026 Site Fees: TBC
- 2026 Rates: TBC
- Open Plan Kitchen/Living Room
- Two Generous Bedrooms
- Two Shower Rooms
- Two Parking Spaces
- Hot Tub With Views Over Paddocks



## The Property

Entrance into the open plan kitchen/living room featuring a modern kitchen with a generous range of wall and base units and a contrasting marble effect worktop. It includes a slimline dishwasher, a four burner gas hob with an extractor fan, an undercounter oven, a fridge/freezer, and a four seater dining table with chairs.

The sitting room benefits from a pleasant triple aspect, with double casement doors opening onto the decking, a feature fireplace with an electric fire, and a corner sofa.

Bedroom one is a large king sized room with matching furniture, including a double wardrobe, bedside cabinets, a chest of drawers, and a dressing table. A door leads through to the en-suite shower room, which has a modern suite comprising a WC, a wash hand basin with a mixer tap, and a shower cubicle with a sliding door.

Bedroom two is a generous twin room with a fitted wardrobe.

The family shower room has tile effect flooring, a UPVC double glazed window, a radiator, and a suite comprising a WC, a wash hand basin with a mixer tap over and storage beneath, a wall hung mirror fronted storage, and a shower cubicle with a sliding door.





## *Gardens & Grounds*

3 Sycamore benefits from two parking spaces alongside the holiday home and a generous area of decking.

To the front is a west facing deck, and to the rear is another decked area with a hot tub and views over nearby paddocks.

## *Services*

- Mains gas, electricity, drainage and water
- Council Tax Band: NA
- Energy Performance Rating: NA

EST.

### Floor Plan

Approx. 47.3 sq. metres (509.1 sq. feet)

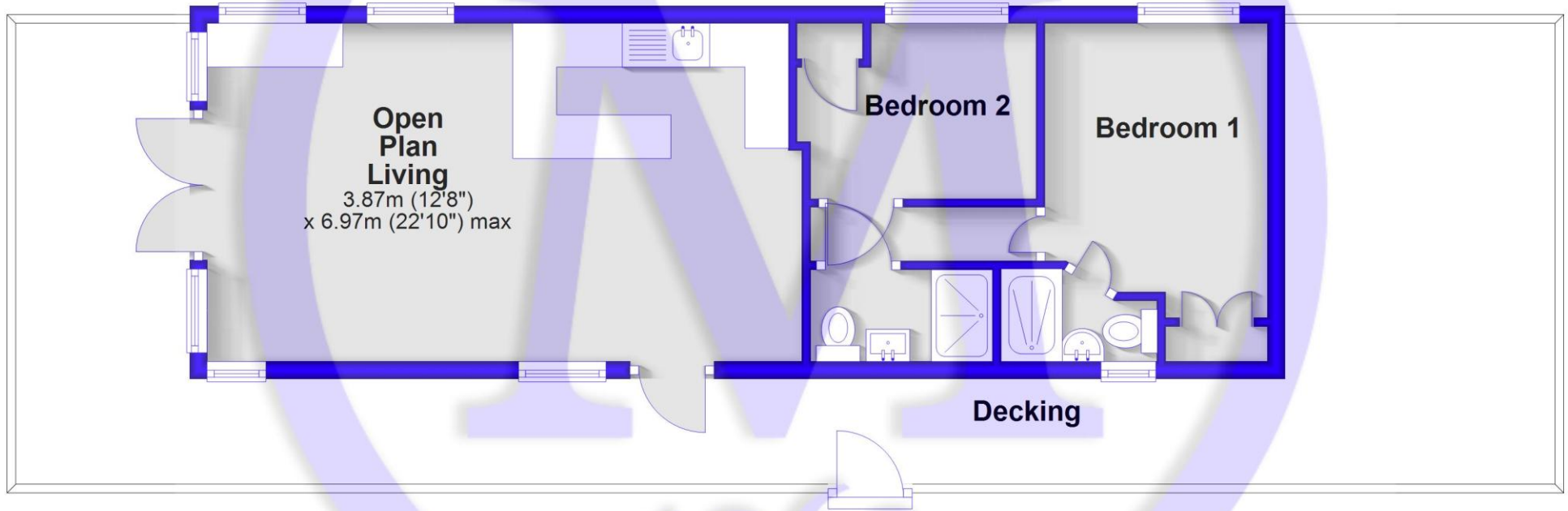

1963

Total area: approx. 47.3 sq. metres (509.1 sq. feet)



## Situation

Nestled in the heart of the enchanting New Forest, Hoburne Bashley is a magical retreat, offering easy access to the New Forest National Park, the clifftop and beach at Barton on Sea, and the bustling high street of New Milton. The park offers a wide range of impressive facilities, including an entertainment complex, a 9-hole golf course, heated pools, a café and brasserie, a convenience store, a multi-use games area, and a brand-new dog wash area. Residents also enjoy exclusive owner events throughout the year, and the park benefits from 24/7 on-site security for added peace of mind.



### Park map

- 1 Reception & entertainment complex
- 2 The Venue
- 3 Café h
- 4 Beauty h
- 5 Brasserie 1932
- 6 Lounge bar
- 7 Indoor pool
- 8 Outdoor pool
- 9 Adventure playground
- 10 Crazy golf
- 11 Multi-use sports court
- 12 Holiday home showground
- 13 Holiday home sales office
- 14 Laundrette
- 15 Park shop
- 16 Woodland h
- 17 Toddler's play area
- 18 Outdoor café
- 19 Archery tunnel
- 20 Woodland Activity Area
- 21 Accessible Woodland Walks, Fairy Trail and Picnic Areas
- 22 Recycling
- 23 Nature trail





[Mitchells.uk.com](http://Mitchells.uk.com)  
[info@mitchells.uk.com](mailto:info@mitchells.uk.com)  
01425 616411

Centenary Buildings  
8-10 Old Milton Road  
New Milton  
Hampshire  
BH25 6DT

**Mitchells**  
1963 — TODAY

