



BURE HOMAGE GARDENS, MUDEFORD, DORSET BH23 4DR

Mitchells
1963 — TODAY



This well-presented four bedroom semi-detached home of 1360 sq ft, offering generous and flexible living accommodation, spacious bedrooms and a large south facing rear garden. Set within a quiet residential location, the property benefits from an attached garage, driveway parking, and a bright conservatory

Located in this tucked away position, just a short stroll from the sandy beaches at Friars Cliff, Mudeford Quay and within the catchment area of the local schools. Partially refurbished by the current owners but still offering scope for extension/modernisation.

FOUR BEDROOMS • FAMILY SHOWER ROOM • KITCHEN • DINING ROOM

SEPARATE LOUNGE • CONSERVATORY • UTILITY ROOM

DOWNSTAIRS W/C • COVERED STORAGE AREA

GARDEN • GARAGE • DRIVEWAY PARKING



The Property

- Semi detached home of approximately 1360 sq ft
- Four well proportioned bedrooms on the first floor
- Spacious sitting room with conservatory extension to the rear
- First floor shower room
- Practical kitchen and separate dining room
- Covered storage area, utility room and downstairs w/c
- Large, south facing rear garden
- Garage and driveway parking
- Ideal location with beaches a short walk away
- Gas central heating and uPVC double glazing
- Council Tax Band 'D' - £2,327.29
- EPC rating 'C'





Location

Mudeford began as a small fishing village close to the entrance of Christchurch Harbour which still sees fishing boats landing their catch today. The area enjoys award winning sandy beaches at Avon beach and plenty of wildlife activity on Hengistbury Head and Stanpit Marsh Nature Reserve. The popular Mudeford Sandbank attracts visitors every year to the private beach huts with the Harbour providing a sheltered environment for water sports activities. With a friendly, community feel, it is no wonder Mudeford is a popular choice for relocation.



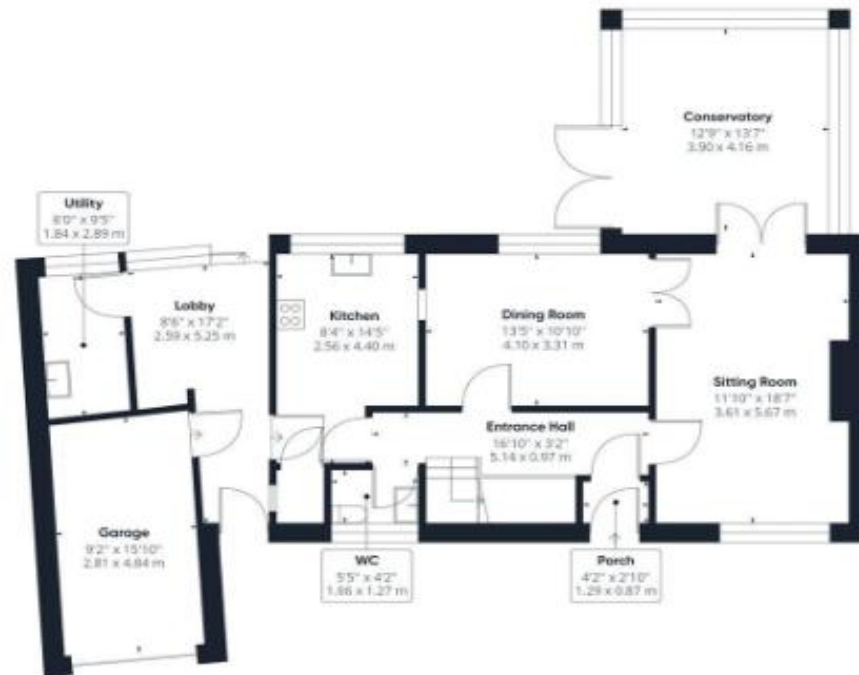

Ground Floor Building 1







mitchells.uk.com
mudeford@mitchells.uk.com
01202 499295

Mudeford
Cambridge House
112-114 Stanpit
BH23 3ND

