



23 Bradley Road, Milford on Sea, SO41 0AZ

£385,000

Mitchells
1963 — TODAY



*23 Bradley Road
Milford on Sea
Lymington
Hampshire
SO41 0AZ*

A superbly presented three bedroom end of terrace house, situated on a modern development in a fantastic position within easy reach of the village green, local schools and the beach. The property was constructed by the well regarded local developer, Pennyfarthing Homes, and other features include a good sized rear garden, a ground floor cloakroom, two allocated car parking spaces and a lovely sitting room with a casement door leading onto the garden. An internal viewing is strongly recommended.

- Entrance Hall
- Sitting/Dining Room
- Kitchen
- Cloakroom
- Landing
- Three Bedrooms
- Bathroom
- Allocated Parking
- Private Gardens



The Property

Entrance hall with attractive timber effect flooring, stairs to the first floor and a double glazed front door.

Superb sitting/dining room with a contemporary flame effect electric fire set into a feature wall, an understairs storage cupboard, a casement door opening onto the rear garden, attractive timber effect flooring and a dedicated home office area.

Kitchen fitted with a range of white wall and base units with a contrasting dark grey worktop and an inset one and a half bowl sink unit with mixer tap over. Integrated appliances include an electric oven, gas hob and extractor. There is space for a tall fridge/freezer and a washing machine, along with a wall mounted Worcester gas fired boiler concealed within a cupboard, tile effect flooring and an outlook over the front courtyard.

Ground floor cloakroom fitted with a modern white suite.

First floor landing with a trap to the roof space and an airing cupboard.

Three first floor bedrooms.

Family bathroom fitted with a modern white suite comprising a panelled bath with mixer tap and shower attachment over, a glass shower screen, a wash basin, a WC, tile effect flooring, an extractor fan and a chrome ladder style heated towel rail.





Gardens & Grounds

The front garden is laid mainly to decorative stone for ease of maintenance, with block paved pathways leading to the front door and a side timber gate. There is a useful storage shed and two allocated parking spaces.

The rear garden is larger than average for this type of property and features a textured paved patio area leading onto a lawn, which in turn extends to a second patio area at the rear of the garden. The remainder is laid mainly to lawn.

Services

- Mains gas, electric, drainage and water
- Council Tax Band D
- Energy Performance Rating B

Ground Floor

Approx. 32.7 sq. metres (351.5 sq. feet)

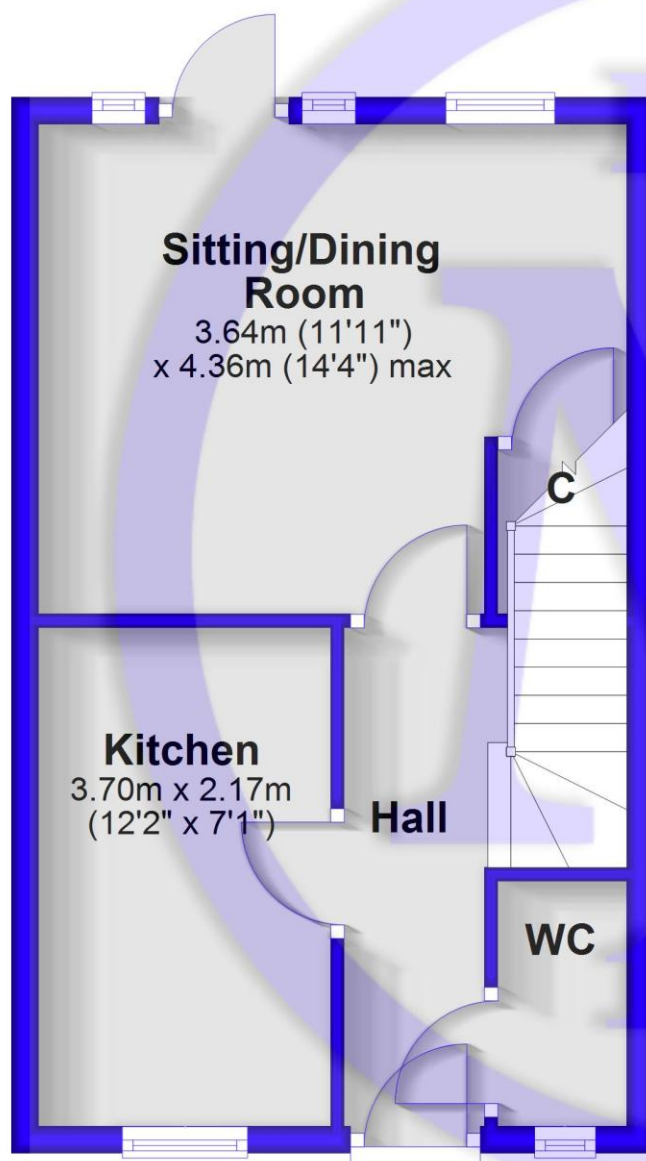

First Floor

Approx. 32.7 sq. metres (351.6 sq. feet)

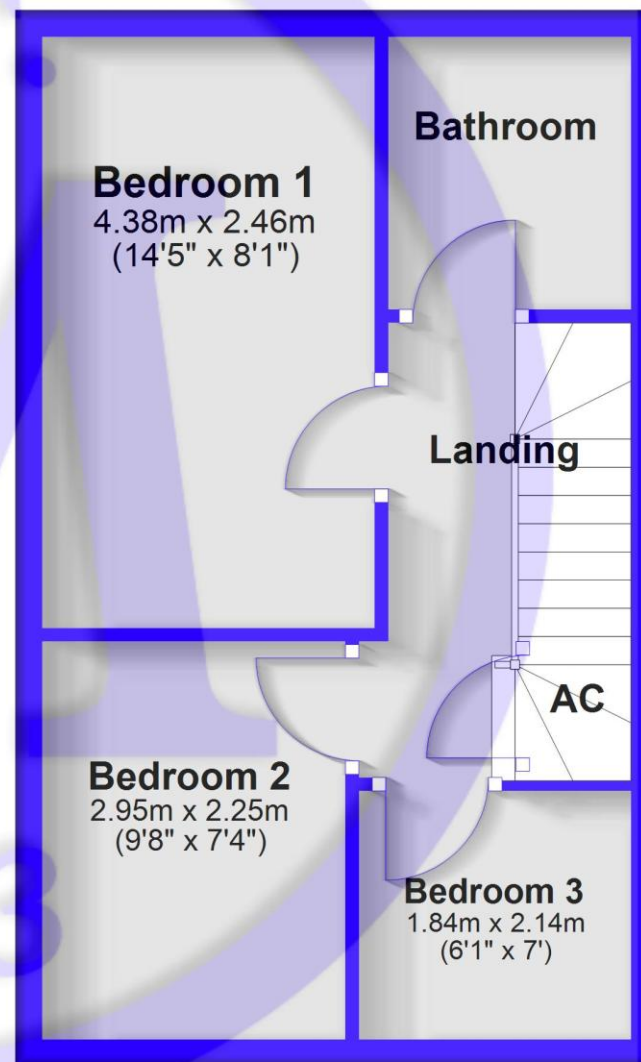

Total area: approx. 65.3 sq. metres (703.1 sq. feet)

Situation

Milford on Sea is a thriving coastal village located between Barton on Sea and the Georgian market town of Lymington. It offers a range of amenities, including top-tier restaurants, three pubs, a superb tennis and squash club, and an attractive village green. With its picturesque coastal setting, lovely beaches, proximity to the New Forest National Park, and the nearby Keyhaven Sailing Club, Milford on Sea is one of the most desirable locations on the south coast.

Directions

From Mitchells, turn right at the traffic lights and proceed along Station Road. At the roundabout, continue straight ahead into Milford Road. Continue past the village green and take the second turning on the right into Bradley Road. Take the first turning on the left, where the property will be found on the left hand side.

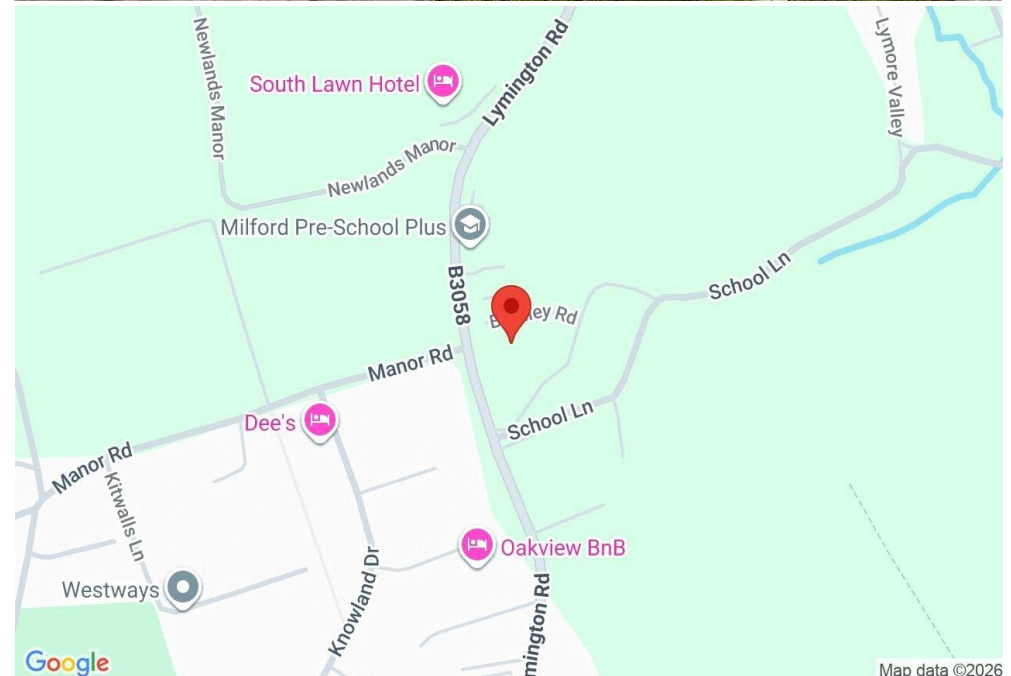



Mitchells.uk.com
info@mitchells.uk.com
01425 616411

Centenary Buildings
8-10 Old Milton Road
New Milton
Hampshire
BH25 6DT

Mitchells
1963 — TODAY

