



Harell Cottage, The Square, Pennington, SO41 8GN

£329,950

Mitchells
1963 — TODAY



Harell Cottage
The Square
Pennington
Lymington
Hampshire
SO41 8GN

A characterful two bedroom semi-detached cottage situated in a convenient location in the centre of the village, with all of the local amenities on hand. The property is offered with no forward chain, and features include a modern kitchen and bathroom, as well as off road parking.

- Entrance Hall
- Sitting/Dining Room
- Kitchen
- Bathroom
- Landing
- Two Bedrooms
- Off Road Parking
- Private Gardens



The Property

Entrance hall with a UPVC double glazed front door and timber effect flooring.

Good sized, double aspect sitting/dining room with an outlook to the front, a timber fire surround with a recessed fire, and stairs leading to the first floor.

The kitchen is fitted with a range of cream wall and base units with timber worktops, an inset one and a half bowl sink unit with mixer tap, and integrated appliances including an electric oven, gas hob, extractor, and slimline dishwasher. There's space for a washing machine and tall fridge/freezer, along with a wall mounted Ideal gas fired boiler, part tiled walls, and timber effect flooring.

The bathroom is fitted with a white suite comprising a panelled bath with a Mira shower over, wash basin, WC, part tiled walls, and timber effect flooring.

First floor landing with trap to the roof space.

Two first floor bedrooms, one with a corner hand basin.





Gardens & Grounds

There is a small area of garden to the front, with twin gates providing access to the driveway, offering off road parking for one vehicle.

The rear garden is laid mainly to lawn, with timber fencing, a timber garden shed, and a sunny aspect.

Services

- Mains gas, electric, drainage and water
- Council Tax Band C
- Energy Performance Rating To be confirmed

Ground Floor

Approx. 33.3 sq. metres (358.0 sq. feet)

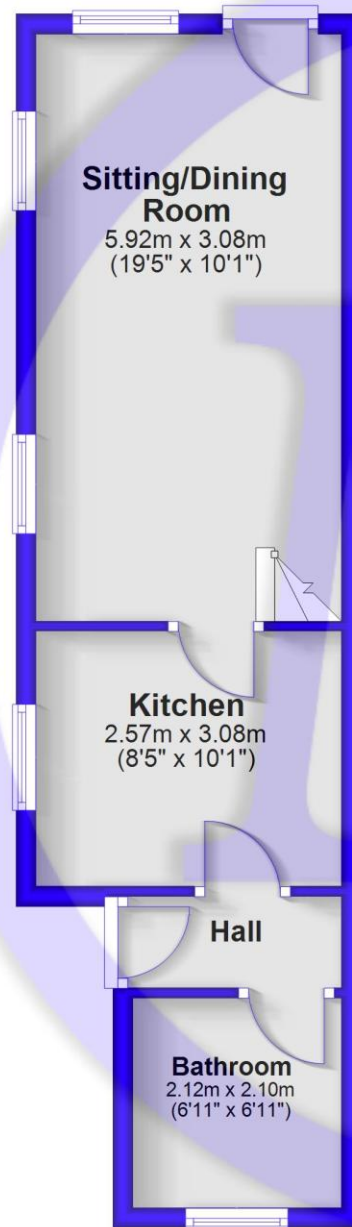

First Floor

Approx. 18.2 sq. metres (195.5 sq. feet)

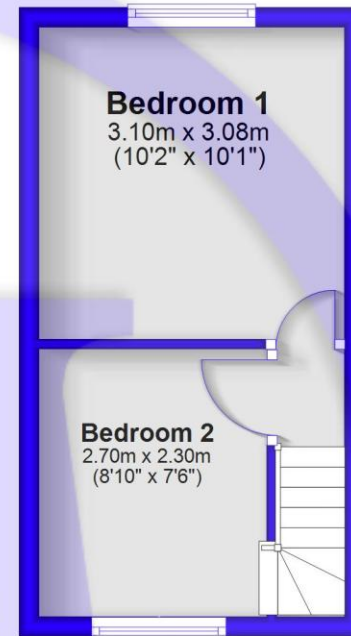

Total area: approx. 51.4 sq. metres (553.5 sq. feet)

Situation

Pennington is a charming village situated just on the outskirts of the highly sought-after Georgian town of Lymington. Known for its vibrant Saturday market, picturesque harbour, and a wide range of independent shops, cafes, and restaurants, Lymington is a thriving town with much to offer. Pennington benefits from its proximity to the New Forest National Park, providing easy access to scenic countryside walks, cycling trails, and outdoor activities. With excellent local amenities, good transport links, and a peaceful village atmosphere, Pennington offers the perfect balance of rural charm and town convenience.

Directions

From Mitchells, turn right at the traffic lights and proceed along Station Road. At the roundabout, turn left onto Lymington Road and continue straight across at the next roundabout. Travel for approximately six miles. Upon reaching the village of Pennington, turn left into South Street and continue into the square, where the property will be found on the left hand side.

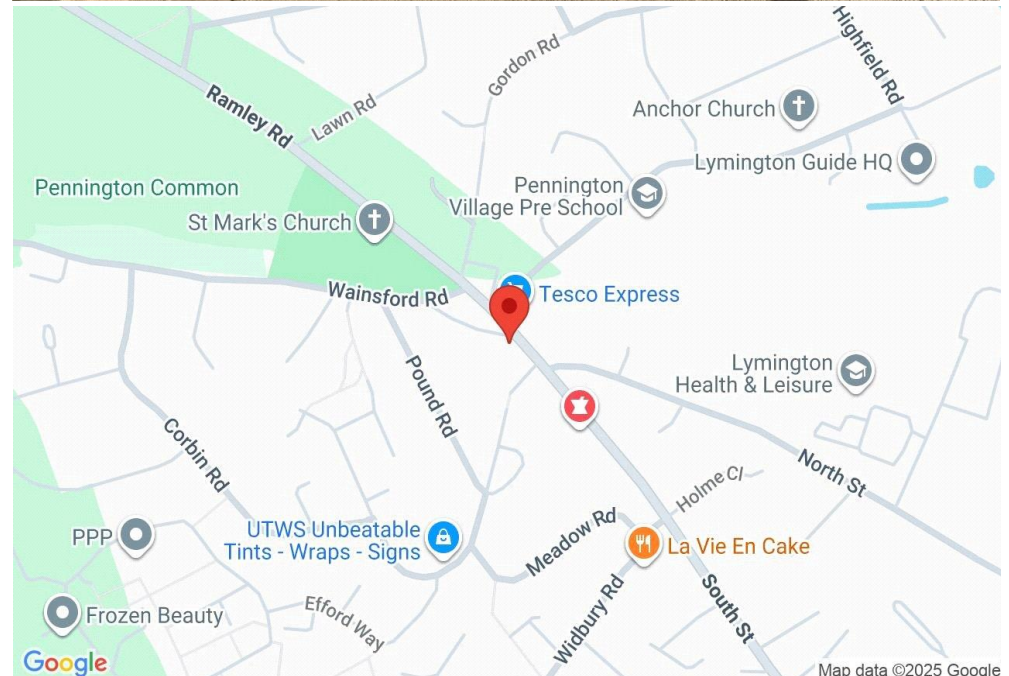



Mitchells.uk.com
info@mitchells.uk.com
01425 616411

Centenary Buildings
8-10 Old Milton Road
New Milton
Hampshire
BH25 6DT

Mitchells
1963 — TODAY

