



41 Chewton Meadow, Hoburne Naish Holiday Park, BH25 7RE

£115,000

Mitchells
1963 — TODAY



*41 Chewton Meadow
Hoburne Naish
Holiday Park
Barton On Sea
Hampshire
BH25 7RE*

A fantastic opportunity to purchase this three bedroom, two bathroom holiday home situated in a quiet cul de sac location on the ever popular Hoburne Naish Holiday Park. Features of the property include a large open plan kitchen/living area, three good sized bedrooms with bedroom one benefitting from an en-suite shower room, a Jack and Jill bathroom, a south facing decking and an allocated parking space.

- License Until 30/11/2043
- 2018 40 x 20 Victory Parkview
- Kitchen/Dining Room
- Sitting Room
- Separate Utility
- Bedroom One With En-Suite
- Two Additional Twin Bedrooms
- Jack & Jill Family Bathroom
- Allocated Parking
- South Facing Decking



The Property

Entrance into the utility room with tile effect flooring, cream wall and base units with a contrasting marble effect worktop, stainless steel sink unit with mixer tap over and drainer, space for washing machine.

The sitting room is an impressive size with wall mounted TV, three piece suite and double aspect.

Kitchen/dining room with tile effect flooring, sliding doors onto the south facing decking, six seater dining table and chairs, pleasant dual aspect and kitchen with modern cream wall and base units with a contrasting marble effect worktop, one and a half bowl stainless steel sink unit with mixer tap over and drainer, four burner gas hob, raised electric oven, integrated microwave, integrated fridge/freezer and a slimline dishwasher.

Bedroom one is a generous king sized room with matching bedside cabinets, double wardrobe, dressing area, wall mounted TV and a door leading through to the en-suite shower room with tile effect flooring and a modern white suite comprising a WC, wash hand basin with mixer tap over, storage beneath, electric shaver point and a shower cubicle with glass sliding door and thermostatic controlled hand held shower attachment, and a ladder style heated towel rail.

Bedroom two is laid out as a generous twin room with a double wardrobe, matching chest of drawers and door leading through to the Jack and Jill bathroom.

Bedroom three is also laid out as a twin room with a double wardrobe, pleasant outlook to the side, bedside cabinet and wall mounted TV aerial point.

Family bathroom with tile effect flooring, ladder style heated towel rail, panel bath with glass shower screen, mixer tap over and shower attachment above, WC, wash hand basin with mixer tap over and storage beneath.





Gardens & Grounds

41 Chewton Meadow enjoys a wider than normal area of decking making an ideal area of outside entertaining. Situated within a quiet cul de sac the holiday home is also only a short walk to all the facilities. There is an allocated parking space adjoining the property.

Services

- Mains gas, electric, drainage and water
- Council Tax Band N/A
- Energy Performance Rating N/A

Floor Plan

Approx. 76.4 sq. metres (822.5 sq. feet)

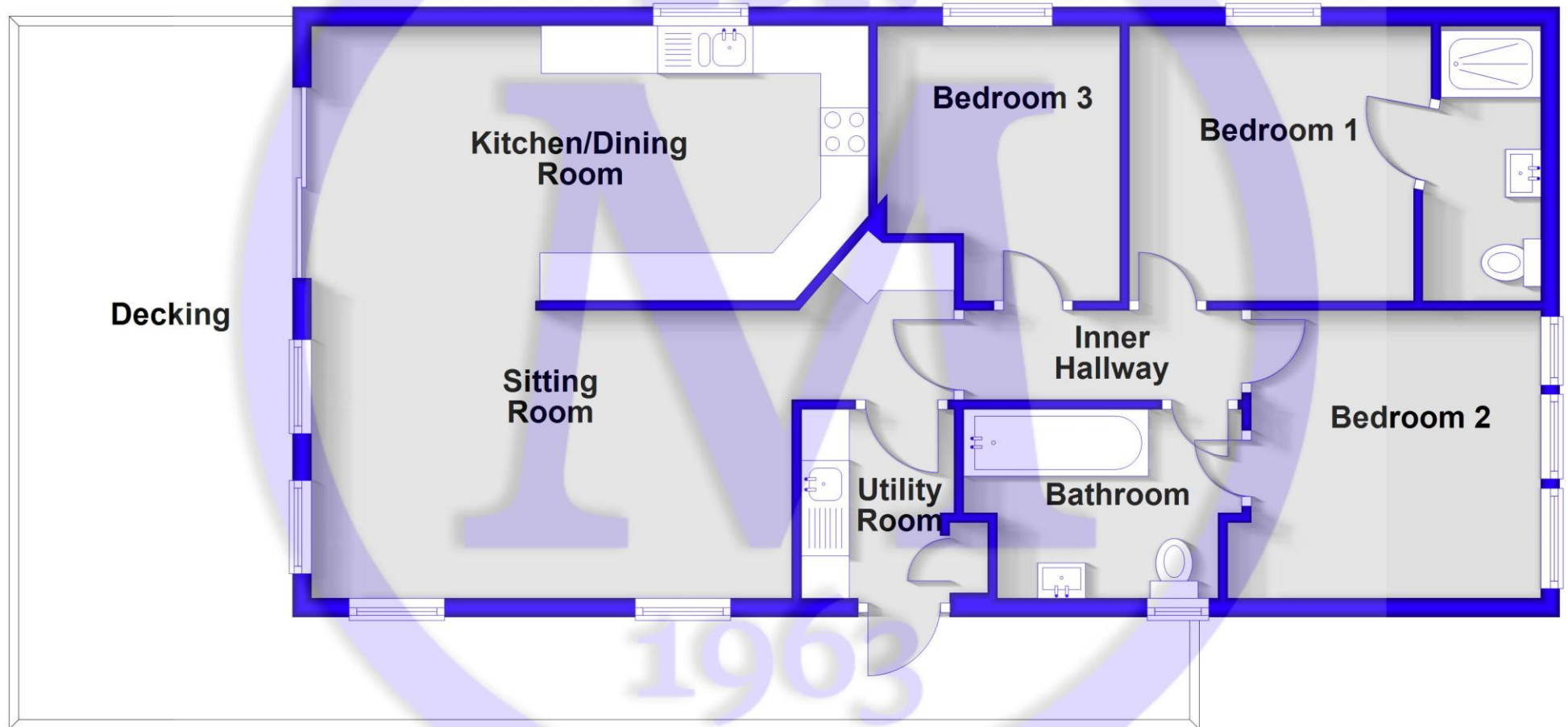

Total area: approx. 76.4 sq. metres (822.5 sq. feet)



Situation

Superb clifftop location with easy access to the beautiful beaches, the stunning clifftop walks, the open forest of the New Forest National Park and the nearby towns of Highcliffe on Sea and New Milton. Facilities include an impressive entertainment complex, heated pools, adventure golf, fitness suite, multi-use games area, brasserie and café among others.

Directions

From Mitchells proceed along Old Milton Road and upon reaching the T junction turn right onto Christchurch Road. After approximately one and a half mile Hoburne Naish Holiday Park will be found on the left hand side.





Mitchells.uk.com
info@mitchells.uk.com
01425 616411

Centenary Buildings
8-10 Old Milton Road
New Milton
Hampshire
BH25 6DT

Mitchells
1963 — TODAY

