



WINSFORD CLOSE, HIGHCLIFFE ON SEA, DORSET

**Mitchells**  
1963 — TODAY







A very spacious, bright and airy detached house of about 1870 sq ft situated in a quiet cul de sac and close to the Comprehensive school and train station. The property is in excellent condition and decorated neutrally with large bedroom sizes and excellent living space. Offered with a double length garage, lovely garden and no forward chain. An excellent family home. The property has been recently redecorated and had two brand new bath/shower rooms fitted, The three bedrooms upstairs are comfortable doubles and there is also a ground floor bedroom facility and adjacent shower room and is ready to move into straight away.

**FOUR BEDROOMS • TWO BATH/SHOWER ROOMS**

**KITCHEN/DINER • LOUNGE • CONSERVATORY**

**GARDEN • GARAGE**

**OFF ROAD PARKING**



## The Property

- Individual detached house with a generous garden and plenty of off road parking
- Three large first floor bedrooms and refitted family bathroom, lots of fitted wardrobes/storage
- Spacious open plan kitchen/dining room that leads onto the uPVC conservatory extension
- Separate lounge, ground floor bedroom and separate utility/ground floor shower room
- Immaculate décor, gas fired central heating (new boiler) and A+ quality double glazing installed May 2025 with a 10 year warranty
- Double length garage
- Space and scope to extend
- A great family house In catchment for both Primary and Comprehensive schools
- Council Tax Band 'F' - £3,304.60
- EPC rating 'D'







## Location

Highcliffe is a small village in the borough of Christchurch, Dorset. The village lies on a picturesque stretch of Solent coastline with views over Christchurch Bay to the Isle of Wight. Fuelled by its enviable location, coastal walks, main line railway links to London (in under two hours) excellent schools and the popularity of the Chewton Glen Hotel, the Highcliffe Golf Course and the Nature Reserve at Steamer Point, Highcliffe is a popular area for those relocating to the coast

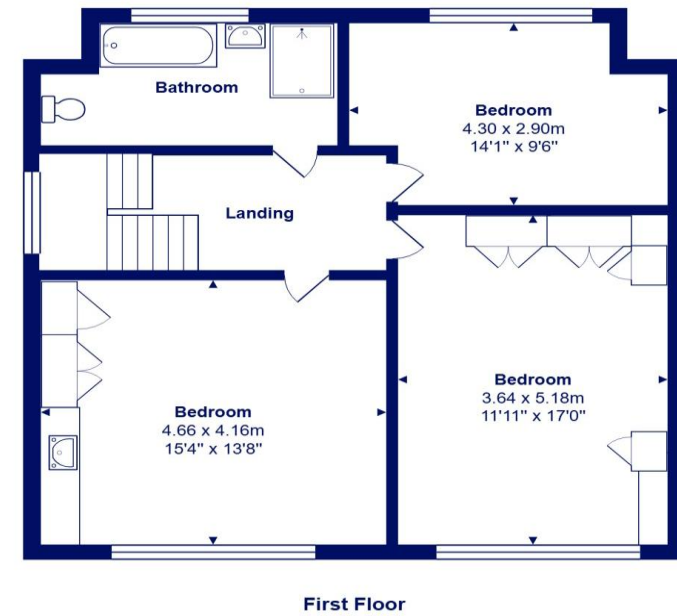
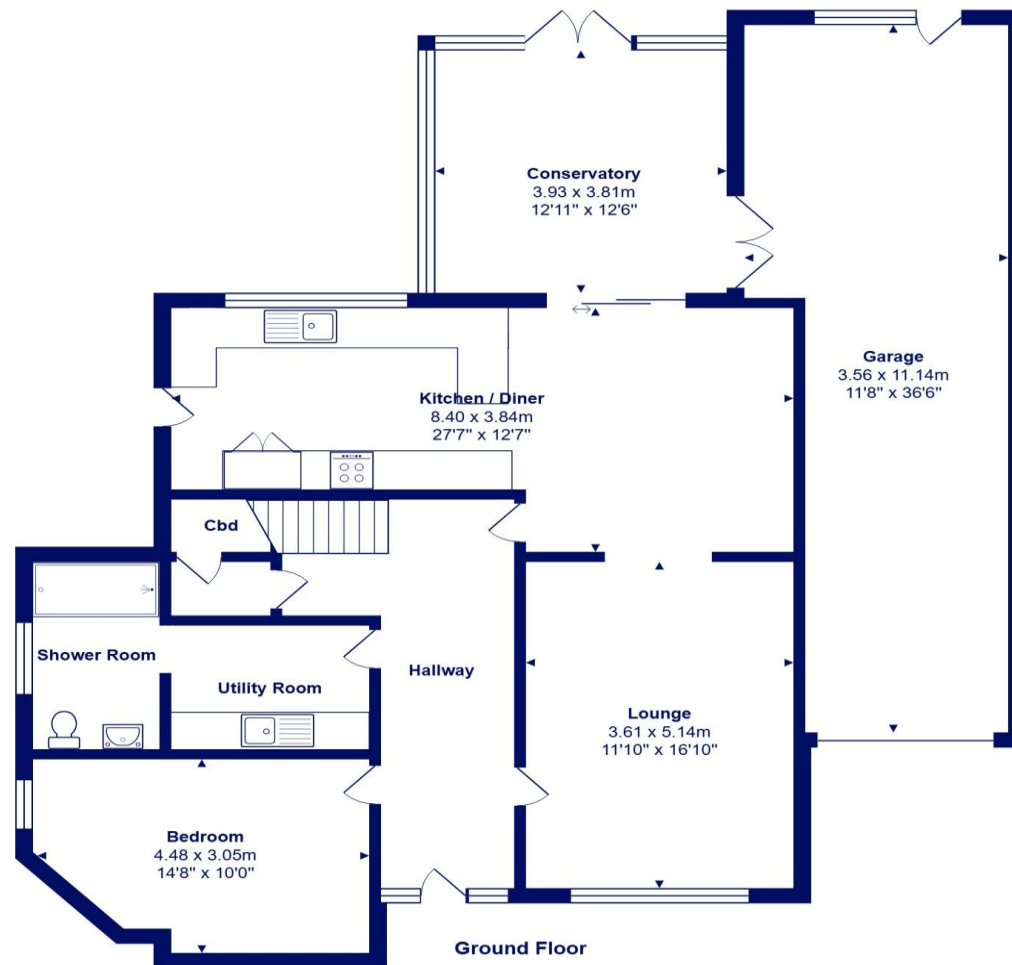

Total Area: 173.7 m<sup>2</sup> ... 1869 ft<sup>2</sup> (excluding garage)

All measurements are approximate and for display purposes only











[mitchells.uk.com](http://mitchells.uk.com)  
[highcliffe@mitchells.uk.com](mailto:highcliffe@mitchells.uk.com)  
01425 272206

Highcliffe  
284 Lymington Road  
Highcliffe  
BH23 5ET

