



8 Beacon Court, Beacon Drive, Highcliffe, BH23 5BY

£315,000

Mitchells
1963 — TODAY



Beacon Drive, Highcliffe on Sea

A delightful sea front two double bedroom ground floor apartment approaching 800sqft, right on the cliff top with lovely sea views across Christchurch Bay to the Isle of Wight. From the nearby cliff top there is a path giving easy access directly to the beach and the High Street shopping centre is just a short stroll away. Whilst the property has been well maintained, having been in the same family since new, it does offer scope and potential for further improvement.

- TWO BEDROOMS • KITCHEN/DINING ROOM • SHOWER ROOM • SEPARATE WC • LOUNGE/DINER • SINGLE GARAGE • COMMUNAL GROUNDS & GARDENS

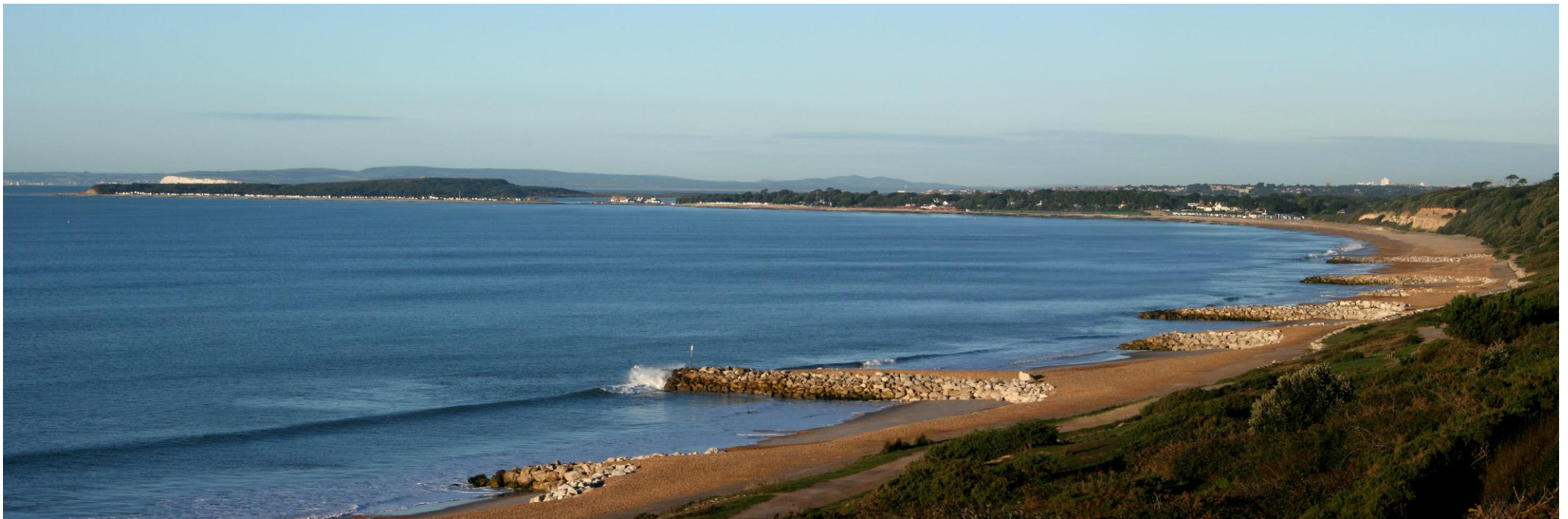

The Property

- South facing sitting room with access to the grounds and cliff top
- Good size well fitted kitchen / diner
- Gas central heating
- UPVC double glazing
- Garage in nearby block
- Plenty of casual car parking
- Communal grounds and gardens
- 999 year lease from 24 June 2003
- Shared freehold thus no ground rent
- Maintenance charge TBC
- NO FORWARD CHAIN
- Council Tax D '£2287.80
- EPC 'D'





Location

Highcliffe is a small village in the borough of Christchurch, Dorset. The village lies on a picturesque stretch of Solent coastline with views over Christchurch Bay to the Isle of Wight. Fuelled by its enviable location, coastal walks, main line railway links to London (in under two hours) excellent schools and the popularity of the Chewton Glen Hotel, the Highcliffe Golf Course and the Nature Reserve at Steamer Point, Highcliffe is a popular area for those relocating to the coast.



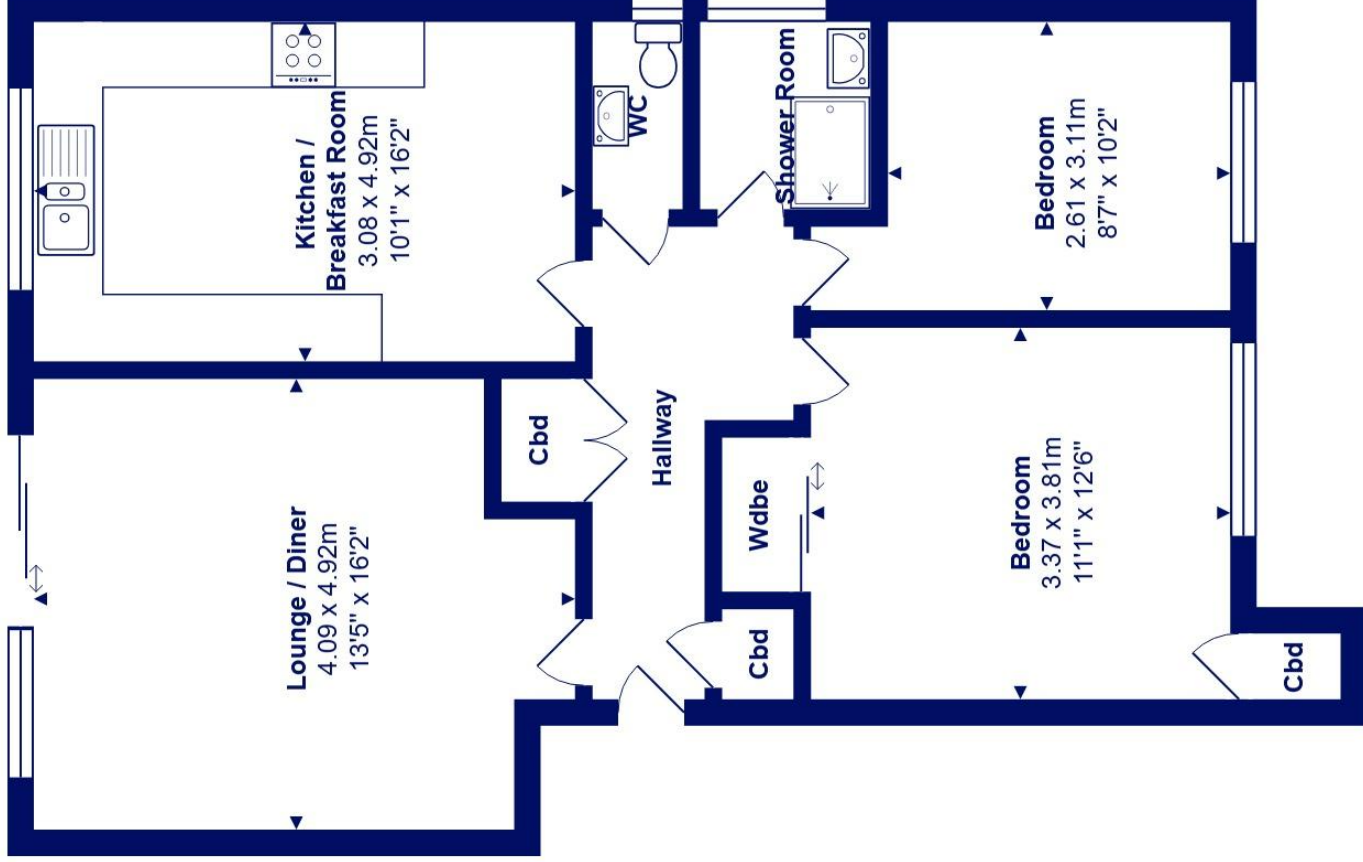

Total Area: 72.5 m² ... 781 ft²

All measurements are approximate and for display purposes only







mitchells.uk.com
highcliffe@mitchells.uk.com
01425 272206

Highcliffe on Sea
284 Lymington Road
Highcliffe on Sea
BH23 4TH

