



123 Smugglers Lane North, Highcliffe on Sea, BH23 4NW

£739,950

Mitchells
1963 — TODAY



Smugglers Lane North, Highcliffe on Sea

A well presented detached chalet bungalow of approximately 1800sqft. The property features a spacious open plan kitchen/conservatory, a lovely large sitting room, four double bedrooms and two bath/shower rooms. Situated in this quiet location within the Highcliffe Schools catchment area and just over a mile from Highcliffe village. Hinton Admiral main line railway station is just around the corner.

- FOUR BEDROOMS • TWO BATH/SHOWER ROOMS • KITCHEN/CONSERVATORY • UTILITY ROOM • LOUNGE • GARAGE • GARDENS



The Property

- Detached chalet bungalow of approx 1800sqft
- Four double bedrooms
- Two bath/shower rooms (one ground floor)
- Lovely large open plan kitchen/conservatory & adjoining utility room with access onto the oversized garage and gardens
- Sitting room with wood burner and outlook to the front
- Gas fired central heating & upvc double glazing
- Easily maintained rear garden with large area of patio ideal for entertaining and potting shed measuring 10'0 x 8'0
- Single oversized garage and plenty of off-road parking
- Short walk to local amenities
- Council Tax 'F' £3304.60
- EPC 'D'





Location

Highcliffe is a small village in the borough of Christchurch, Dorset. The village lies on a picturesque stretch of Solent coastline with views over Christchurch Bay to the Isle of Wight. Fuelled by its enviable location, coastal walks, main line railway links to London (in under two hours) excellent schools and the popularity of the Chewton Glen Hotel, the Highcliffe Golf Course and the Nature Reserve at Steamer Point, Highcliffe is a popular area for those relocating to the coast.



Ground Floor

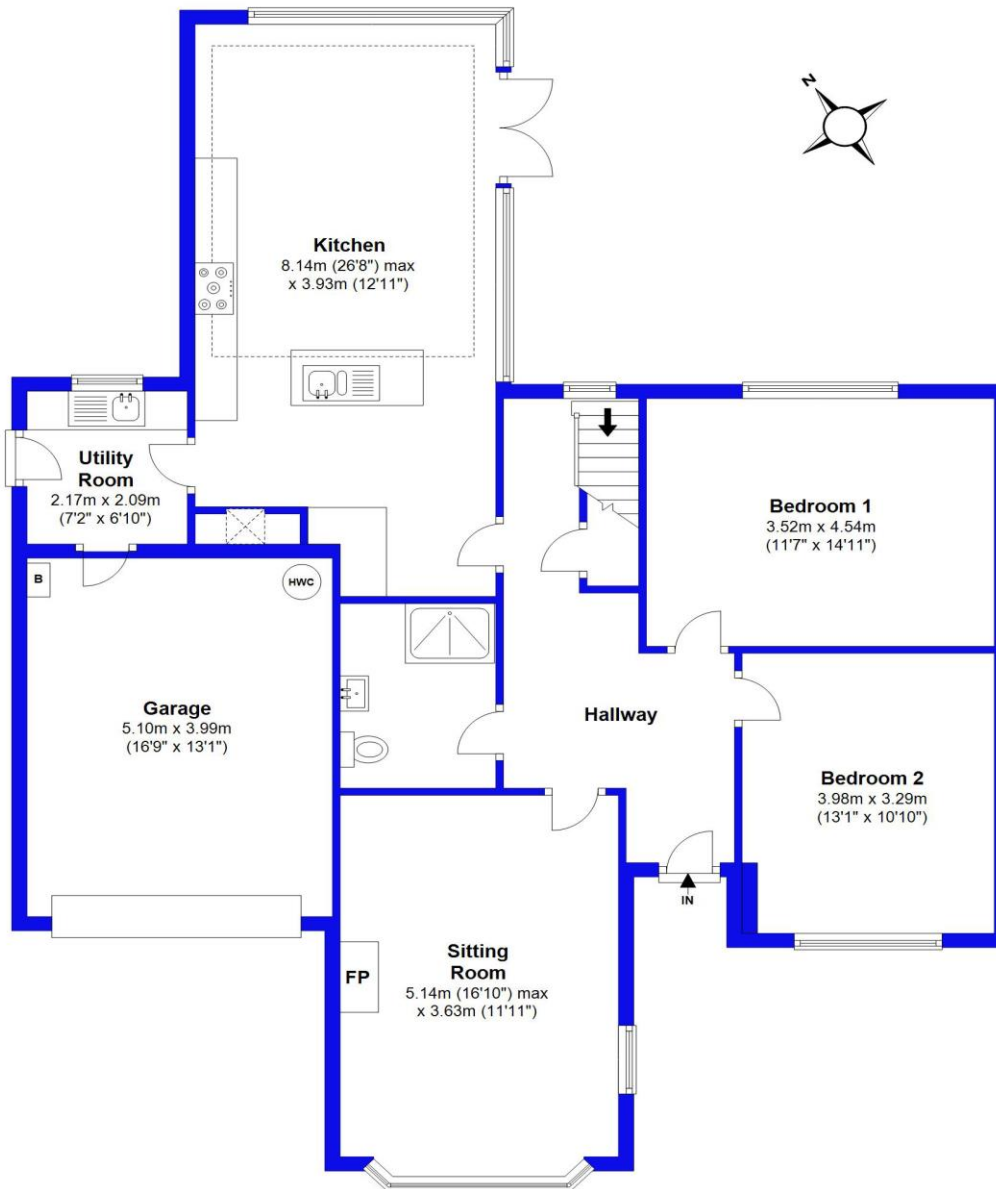

Approx Gross Internal Area: 147.0 sqm / 1581.7 sqft

Garage: 21.3 sqm / 229.3 sqft

Total Approx Gross Area: 168.3 sqm / 1811.0 sqft

First Floor



Illustration for identification purposes only; measurements are approximate, not to scale. EPC New Forest Plan produced using PlanUp.





mitchells.uk.com
highcliffe@mitchells.uk.com
01425 272206

Highcliffe on Sea
284 Lymington Road
Highcliffe on Sea
BH23 4TH

