



H24 Shorefield, Shorefield Country Park, SO41 0LH

£60,000

Mitchells
1963 — TODAY



*H24 Shorefield
Shorefield Country Park
Downton
Hampshire
SO41 0LH*

A beautifully presented two bedroom, two shower room holiday home situated in a fantastic, quiet cul de sac location on the popular Shorefield Country Park. Features of the holiday home include a spacious open plan living area with a modern kitchen, a dining area and a triple aspect sitting room, two good sized bedrooms with bedroom one benefitting from an en-suite shower room, a family shower room, a private area of decking, two allocated parking spaces and an internal viewing is highly recommended.

- 2021 Willerby Waverley
- 40 x 14
- Entrance Hall
- Kitchen/Dining Room
- Sitting Room
- Two Bedrooms
- En-Suite Shower Room
- Family Shower Room
- Spacious Decking
- Second Home Only
- Cannot Be Main Residence



The Property

Entrance hall with useful coat hooks, bench and a storage area.

Kitchen/dining room with wood effect flooring, a generous range of wood shaker style wall and base units with a contrasting marble effect worktop, integrated appliances including a washing machine, five burner gas hob with undercounter double electric oven, full sized integral dishwasher, tall fridge/freezer and a microwave, sink unit with mixer tap over and drainer, breakfast bar and a four seater dining table and chairs.

The sitting room is a particular feature of the property with a pleasant triple aspect, sliding doors onto the decking, feature fireplace with electric inset fire, and vaulted ceilings.

Family bathroom with tile effect flooring and a modern suite comprising a WC, wash hand basin with mixer tap over and storage beneath and mirror fronted medicine cabinet above, shaving point, separate shower cubicle with thermostatic controlled shower attachments and a folding glass shower door, extractor fan and a chrome ladder style heated towel rail.

Bedroom one is a generous size with built in wardrobes, bench area enjoying a pleasant outlook over the rear, built in dressing area, matching bedside cabinets, large feature window and a door leading through to the en-suite shower room with a suite comprising a WC, wash hand basin with mixer tap over and storage beneath, wall hung mirror fronted medicine cabinet, shower cubicle with glass folding shower door and thermostatic controlled shower attachments, and a cupboard housing the Valliant central heating boiler.

Bedroom two is laid out as a twin bedroom with two single beds, double wardrobe, matching dressing area with mirror above, shelving and a pleasant outlook to the side.





Gardens & Grounds

To the front of the holiday home is two allocated parking spaces and a spacious area of decking which wraps around to the side of the property providing excellent space for outside entertaining.

The holiday home is situated in a lovely quiet cul de sac location within level walking distance of the outside pool and only a short walk away from the rest of the facilities at Shorefield Country Park.

Services

At Shorefield Country Park the site fees run from November to October and the rates charge runs April to March. These can be paid over six or twelve months. The gas and electricity are metered and billed in May and November. The park is open from 10th February to 5th January.

Ground Floor

Approx. 50.3 sq. metres (541.2 sq. feet)

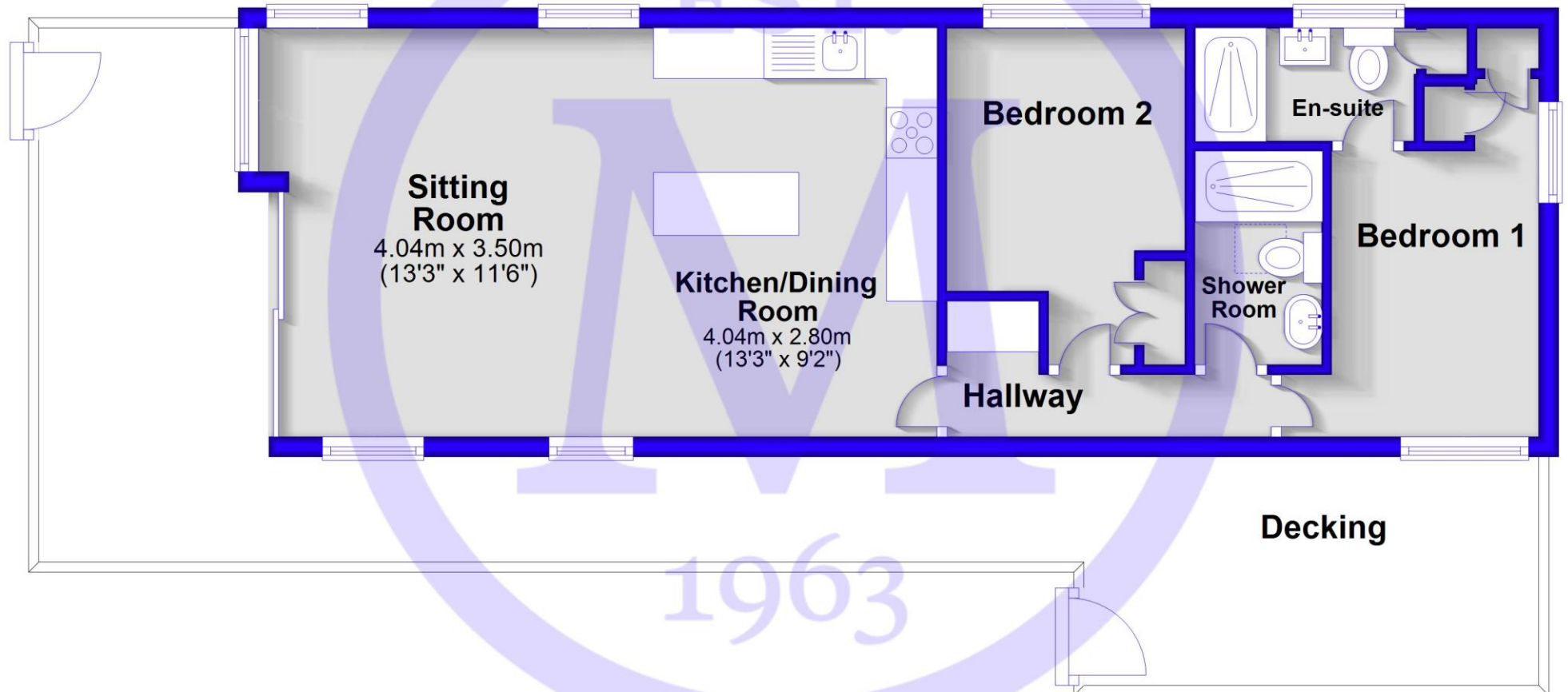

Total area: approx. 50.3 sq. metres (541.2 sq. feet)

Situation

Situated on the southern edge of the New Forest National Park, and just a short stroll away from the shingled shores of the beach at Milford on Sea, the award winning Shorefield Country Park is a fantastic position to own the ultimate bolthole. Facilities include heated indoor and outdoor pools, gym and day spa, bars, restaurant, fishing lake, pet friendly areas, play areas, tennis courts and live family entertainment.

Directions

From Mitchells turn right at the traffic lights and proceed down Station Road. Across at the roundabout onto Milford Road and continue for approximately one and a half miles. Turn left into Downton Lane, right into Shorefield Park, passing the clubhouse on the left and as you approach the barriers turn left at the roundabout and follow signage to H24.





Mitchells.uk.com
info@mitchells.uk.com
01425 616411

Centenary Buildings
8-10 Old Milton Road
New Milton
Hampshire
BH25 6DT

Mitchells
1963 — TODAY

