



2 Barton Meadow, Hoburne Naish Holiday Park, BH25 7RE

£169,995

Mitchells
1963 — TODAY



*2 Barton Meadow
Hoburne Naish
Holiday Park
Barton On Sea
Hampshire
BH25 7RE*

A fantastically positioned three bedroom, two bathroom holiday home situated a short level walk from all the facilities at Hoburne Naish Holiday Park. Features of the holiday home include three large bedrooms with bedroom one benefitting from its own en-suite shower room, a spacious sitting room with a pleasant double aspect, a kitchen/dining room with sliding doors onto the south facing decking, a family bathroom, a separate utility and allocated parking.

- 2019 Victory Parkview 41 x 20
- License Ends 30/11/2044
- Utility Room
- Sitting Room
- Kitchen/Dining Room
- Three Bedrooms
- Bedroom One With En-Suite Shower Room
- Jack & Jill Family Bathroom
- South Facing Decking
- Allocated Parking
- Holiday Home Only
- Can Not Be Main Residence



The Property

Entrance into the useful utility room with an extractor fan, wood effect flooring, modern cream units with a contrasting marble effect worktop, stainless steel sink unit with mixer tap over and drainer, cupboard housing the central heating boiler system and a washing machine.

Sitting room with a pleasant dual aspect enjoying a south and eastly aspect and feature fireplace with inset flame effect electric fire.

Kitchen/dining room with sliding doors onto the south facing decking, timber effect flooring and a modern kitchen with gloss wall and base units with a contrasting marble effect worktop, stainless steel one and a half bowl sink unit with mixer tap over and drainer, large American style fridge/freezer and integrated appliances including an eyelevel electric oven, eyelevel microwave, five burner gas hob and full sized Biko dishwasher.

Bedroom one is a generous king sized room with matching furniture including a dressing table with mirror above, triple wardrobe, matching bedside cabinets and door leading through to the en-suite shower room with timber effect flooring and suite comprising a WC, ladder style heated towel rail, shower cubicle with thermostatic shower attachments, wash hand basin with mixer tap over, storage beneath, a mirror fronted wall hung medicine cabinet above and electric shaver points.

Bedroom two is a generous twin sized room with two single beds, matching chest of drawers, a double wardrobe and a door leading through to the Jack and Jill family bathroom.

Family bathroom with timber effect flooring and suite comprising a WC, wash hand basin with mixer tap over, storage beneath and mirror fronted medicine cabinet above, electric shaver points, ladder style heated towel rail, panel bath with mixer tap over and wall mounted shower attachment, modern tile effect splashback and extractor fan.





Gardens & Grounds

2 Barton Meadow enjoys a beautiful position on the park enjoying a sunny aspect to the large area of decking, a pleasant area of lawn surrounding the holiday home, hedging providing privacy from the road and an allocated parking space.

Services

- Mains gas, electric, drainage and water

Floor Plan

Approx. 76.4 sq. metres (822.5 sq. feet)

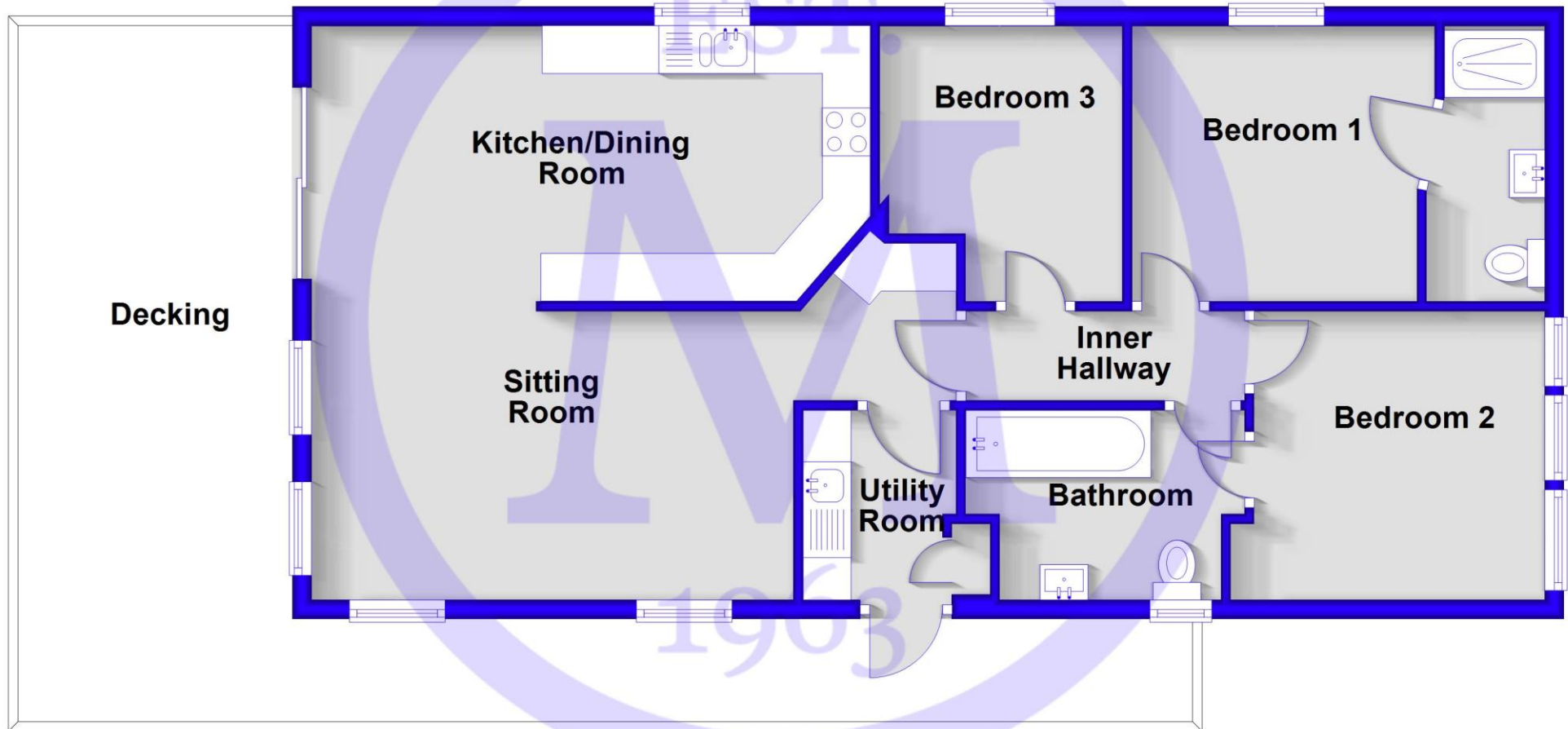

Total area: approx. 76.4 sq. metres (822.5 sq. feet)

'Whilst every attempt has been made to ensure the accuracy of this floor plan, the measurements of doors, windows, rooms and any other items are approximate and no responsibility is taken for any error, omission or mis-statement. This plan is for illustrative purposes only and should be used as such by any prospective purchaser.'

Plan produced using PlanUp.



Situation

Superb clifftop location with easy access to the beautiful beaches, the stunning clifftop walks, the open forest of the New Forest National Park and the nearby towns of Highcliffe on Sea and New Milton, Facilities include an impressive entertainment complex, heated pools, adventure golf, fitness suite, multi-use games area, brasserie and café among others.

Directions

From Mitchells proceed along Old Milton Road and upon reaching the T junction turn right onto Christchurch Road. After approximately one and a half miles Hoburne Naish Holiday Park will be found on the left hand side.

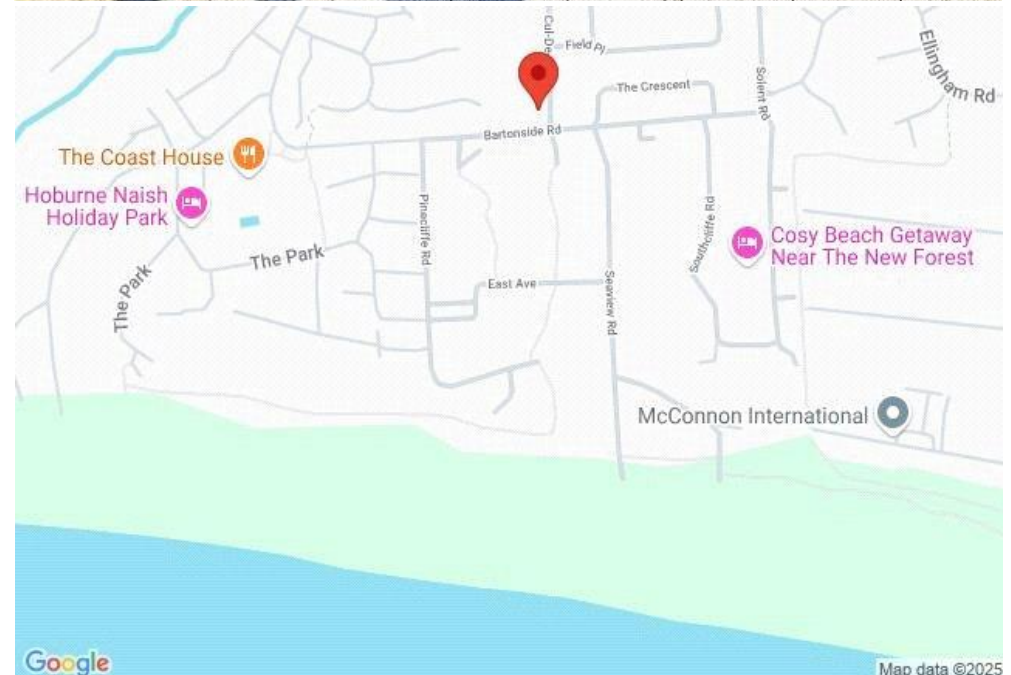



Mitchells.uk.com
info@mitchells.uk.com
01425 616411

Centenary Buildings
8-10 Old Milton Road
New Milton
Hampshire
BH25 6DT

Mitchells
1963 — TODAY

