



22, Keysworth Avenue, Barton on Sea, BH25 7HY

£875,000

Mitchells
1963 — TODAY



*22 Keyworth Avenue
Barton on Sea
New Milton
Hampshire
BH25 7HY*

An impressive three/four bedroom refurbished and extended bungalow, situated in a fantastic location within walking distance of the local shop and Barton on Sea clifftop and beach. The property has been finished to a high specification and offers a spacious living area with bi-fold doors opening onto the landscaped rear garden, a modern bathroom, three double bedrooms with an en-suite to the master bedroom, a home office/bedroom four, a separate utility room, off road parking for multiple vehicles, and a garage.

- High Specification Refurbished Bungalow
- Impressive Open Plan Kitchen/Living Area
- Three Double Bedrooms
- Home Office/Bedroom Four
- Beautiful Modern Bathroom
- En-Suite To Bedroom One
- Separate Utility Room
- Driveway & Garage
- Secluded Landscaped Rear Garden
- Vendor Suited



The Property

Entrance porch with a UPVC front door and side window, tiled flooring, and a large Crittall door leading to the entrance hall.

Entrance hall with timber effect tiled flooring, a modern radiator, and storage cupboards.

Open plan kitchen/living area with timber effect tiled flooring, bi-fold doors opening onto the rear garden, and two sky lanterns providing an excellent amount of natural light. The modern kitchen includes a great range of shaker style wall and base units with a stone worktop, space and plumbing for an American style fridge/freezer, an inset sink unit with mixer tap, a range style cooker with gas hob and extractor fan above, a large corner larder cupboard, and an integrated dishwasher and bin drawer.

Sitting area with a feature media wall, an inset electric flame effect fire, and two floor to ceiling windows overlooking the patio.

Separate utility room with a door leading towards the garage, space and plumbing for a washing machine, an additional worktop, and storage.

Family bathroom with fully tiled flooring and walls, an extractor fan, and a suite comprising a freestanding bath with wall mounted taps and waterfall shower attachments, a WC, a ladder style heated towel rail, a wall hung mirror, and a wash hand basin with a mixer tap over and storage beneath.

Bedroom one is a large king size room with fitted wardrobes and a view over the front of the property, with a door leading through to the en-suite shower room. The modern en-suite comprises a large walk-in shower with a glass shower screen, a ladder style heated towel rail, and a wall hung wash hand basin with a mixer tap.

Two further double bedrooms, with bedroom two benefiting from a fitted wardrobe and an outlook to the front of the property.

The home office features a large UPVC double glazed window to the side of the bungalow and could easily be used as an additional double bedroom if required.





Gardens & Grounds

To the front of the property, a block paved driveway leads to the garage, which features an electric roller door, power, and lighting. A large area of decorative stone provides additional off road parking for three vehicles, while a mature hedge and timber fence offer privacy from the road.

The rear garden benefits from a fantastic degree of privacy and seclusion and has been beautifully landscaped. It includes a large porcelain patio area leading to an outdoor seating space, an additional patio area with a timber pergola, a timber garden shed, and a pathway providing access down the side of the property.



Services

Mains gas, electricity, water and drainage

Council Tax Band: D

Energy Performance Certificate (EPC) Rating: D

Floor Plan

Approx. 168.1 sq. metres (1809.5 sq. feet)

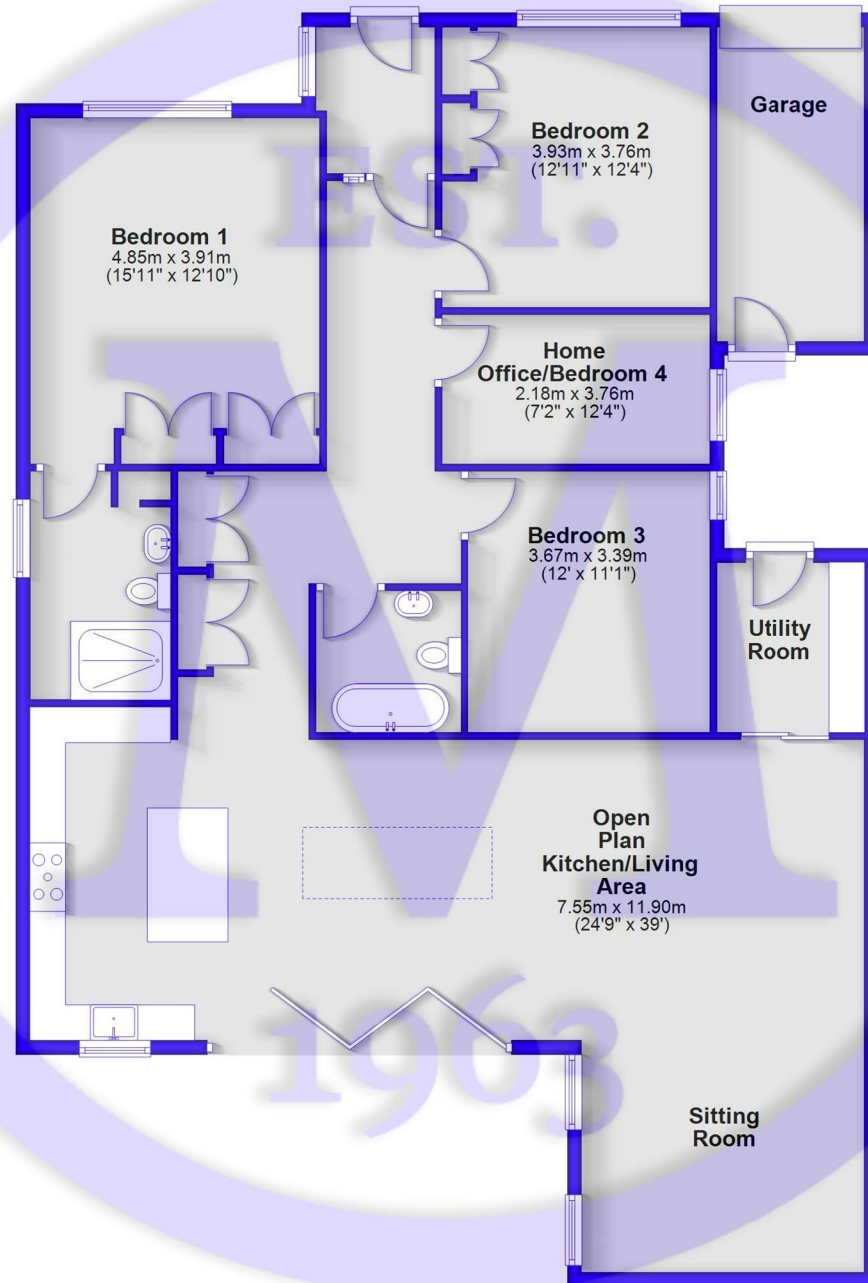

Total area: approx. 168.1 sq. metres (1809.5 sq. feet)

Situation

Barton on Sea, a charming suburb of New Milton, enjoys a prime location along a picturesque stretch of the Solent coastline. With sweeping views across Christchurch Bay to the Isle of Wight and access to stunning coastal walks in both directions, it's a haven for nature lovers and outdoor enthusiasts. Its popularity is further enhanced by proximity to the open landscapes of the New Forest National Park, direct mainline rail links to London Waterloo, and a range of high-quality amenities. These include excellent schools, fine dining at the renowned Chewton Glen Hotel and Pebble Beach restaurant, and a 27-hole links-style golf course. Offering a perfect blend of natural beauty, convenience, and luxury, Barton on Sea continues to attract those seeking an exceptional coastal lifestyle.





Mitchells.uk.com
info@mitchells.uk.com
01425 616411

Centenary Buildings
8-10 Old Milton Road
New Milton
Hampshire
BH25 6DT

Mitchells
1963 — TODAY

