



*2 Aspen, Hoburne Bashley Holiday Park, BH25 5QR*

£62,500

**Mitchells**  
1963 — TODAY







*2 Aspen  
Hoburne Bashley  
Holiday Park  
New Milton  
Hampshire  
BH25 5QR*

An immaculately presented two bedroom two bathroom holiday home situated in a popular area within Hoburne Bashley Holiday Park. The property offers bright and spacious accommodation with features including an open plan kitchen/living area with doors onto the decking, two generous bedrooms with bedroom one benefitting from an en-suite shower room, a family shower room, ample storage, two allocated parking spaces and a license until November 2038.

- Entrance Hall
- Open Plane Kitchen/Living Area
- Two Bedrooms
- En-Suite Shower Room
- Family Shower Room
- Bespoke Design
- Two Allocated Parking Spaces
- 2017 Prestige Forester 42x14
- License Until November 2038
- Second Home Only
- Can't Be A Main Residence



## The Property

Entrance hall with wood effect flooring, cupboard housing the gas fired central heating and useful coat hooks.

The kitchen offers a generous range of shaker style wall and base units with a contrasting wood effect worktop, four burner gas hob with electric undercounter oven, integrated appliances include a fridge/freezer, slimline dishwasher, washing machine and a one and half bowl ceramic sink with mixer tap over and drainer.

The sitting/dining area is a bright triple aspect room with two casement doors onto the decking and ample space for all furniture including a four seater dining table and chairs.

Bedroom one is a good sized double bedroom with a built in wardrobe, dressing table with matching bedside units and door leading through to the en-suite shower room with wood effect flooring, part tiled walls and suite comprising a WC, wash hand basin with mixer tap over and storage beneath, chrome ladder style heated towel rail and shower cubicle with thermostatic shower attachments and glass shower door.

Bedroom two is currently laid out a twin room with two single beds and a large built in wardrobe.

Family bathroom with wood effect flooring, part tiled walls and a suite comprising a WC, wash hand basin with mixer tap over and storage beneath, chrome ladder style heated towel rail, window, electric shaving point and a shower cubicle with thermostatic shower attachments and glass shower door.







## *Gardens & Grounds*

2 Aspen benefits from an extended decking with two gates providing great access, a barbeque area to the rear and two allocated parking spaces.

The holiday home is situated in a quiet, modern cul de sac close to all the facilities.

## *Services*

- Mains gas, electric, drainage and water
- Council Tax Band N/A
- Energy Performance Rating N/A

## Floor Plan

Approx. 49.5 sq. metres (532.5 sq. feet)

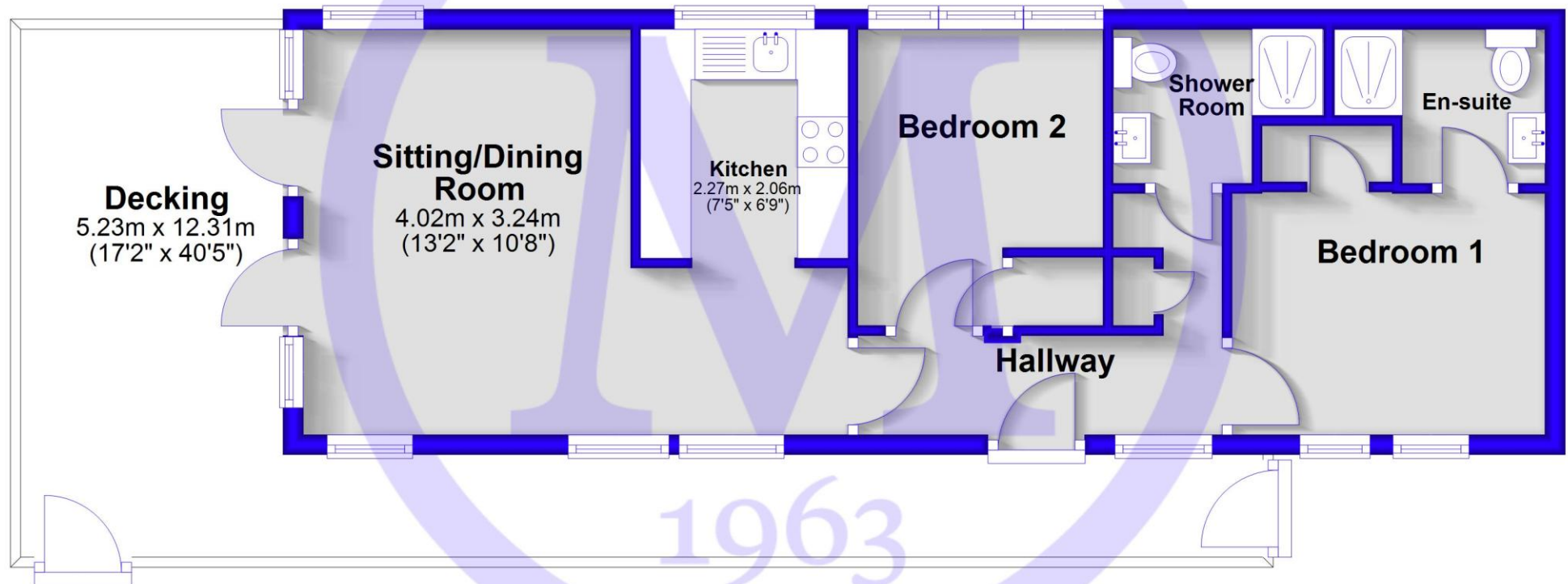

Total area: approx. 49.5 sq. metres (532.5 sq. feet)

'Whilst every attempt has been made to ensure the accuracy of this floor plan, the measurements of doors, windows, rooms and any other items are approximate and no responsibility is taken for any error, omission or mis-statement.

This plan is for illustrative purposes only and should be used as such by any prospective purchaser.'

Plan produced using PlanUp.





## Situation

In the heart of the enchanting New Forest Hoburne Bashley is a magical place to escape to with the open forest of the New Forest National Park, Barton on Sea clifftop and beach and New Milton high street all within easy reach. Facilities on offer at the park include an impressive entertainment complex, 9 hole golf course, heated pools, café and Brasserie, convenience store and a multi-use games area.

## Directions

From Mitchells turn left at the traffic lights and proceed over the railway bridge. Upon reaching the roundabout turn right onto Sway Road. After 500 yards turn left into Hoburne Bashley and take the first turning left. Follow the road round to the left where the property will be found after a short distance.



### Park map

- 1 Reception & entertainment complex
- 2 The Venue
- 3 Café h
- 4 Beauty h
- 5 Brasserie 192
- 6 Lounge bar
- 7 Indoor pool
- 8 Outdoor pool
- 9 Adventure playground
- 10 Crazy golf
- 11 Multi-use sports court
- 12 Holiday home sales office
- 13 Laundryette
- 14 Park shop
- 15 Woodland h
- 16 Toddler's play area
- 17 Outdoor café
- 18 Archery tunnel
- 19 Woodland Activity Area
- 20 Accessible Woodland Walks, Fairy Trail and Picnic Areas
- 21 Recycling
- 22 Nature trail







[Mitchells.uk.com](http://Mitchells.uk.com)  
[info@mitchells.uk.com](mailto:info@mitchells.uk.com)  
01425 616411

Centenary Buildings  
8-10 Old Milton Road  
New Milton  
Hampshire  
BH25 6DT

**Mitchells**  
1963 — TODAY

