



9 Danehouse Lodge, 8 Wortley Road, Highcliffe, BH23 5DT £525,000

Mitchells
1963 — TODAY



Danehouse Lodge, Wortley Road, Highcliffe on Sea

A stunning three bedroom, two bathroom top floor penthouse apartment of about 1200sqft, built by Pennyfarthing Homes to their usual high standard and specification and featuring excellent and versatile living accommodation together with a dressing room to bedroom two and a west facing sun balcony from the master bedroom suite. The penthouse can be accessed by either stairs or an automatic passenger lift. Situated in this prestige block right in the centre of Highcliffe, close to all the shops and amenities and just a short stroll from the sea front.

- **THREE BEDROOMS • DRESSING ROOM • TWO BATH/SHOWER ROOMS (ONE EN-SUITE) • KITCHEN • SITTING/DINING ROOM • SUN BALCONY • GARAGE • ALLOCATED PARKING SPACE**

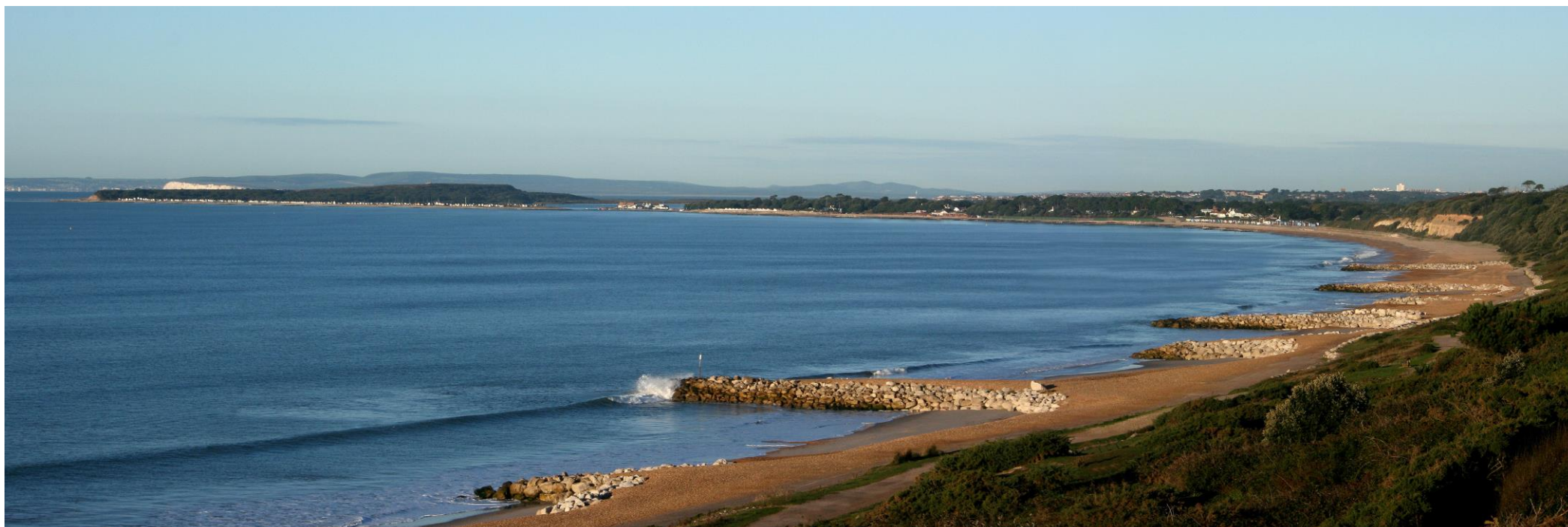

The Property

- A beautifully presented top floor luxury penthouse apartment of approx. 1200sqft
- Three bedrooms, one with dressing room
- Two recently fitted brand new bath/shower rooms (one en-suite)
- Lovely large sitting/dining room
- West facing sun balcony
- Attractive, well maintained communal areas with stairs and automatic passenger lift
- Beautifully tended communal grounds and gardens
- Single garage in a block
- Most convenient location, just to the south of the main high street and only a short walk from the cliff top and beach
- Hinton Admiral main line railway station is just over a mile distant
- Maintenance charge: approx. £800 per half year
- Shared freehold, balance of 125 year lease from 01/12/1999, about 100 years remaining
- No ground rent payable
- Council Tax band 'E' £2658.58
- EPC rating 'C'





Location

Highcliffe is a small village in the borough of Christchurch, Dorset. The village lies on a picturesque stretch of Solent coastline with views over Christchurch Bay to the Isle of Wight. Fuelled by its enviable location, coastal walks, main line railway links to London (in under two hours) excellent schools and the popularity of the Chewton Glen Hotel, the Highcliffe Golf Course and the Nature Reserve at Steamer Point, Highcliffe is a popular area for those relocating to the coast.



Internal Floor Area
Approx. 109.9 sq. metres (1183.3 sq. feet)

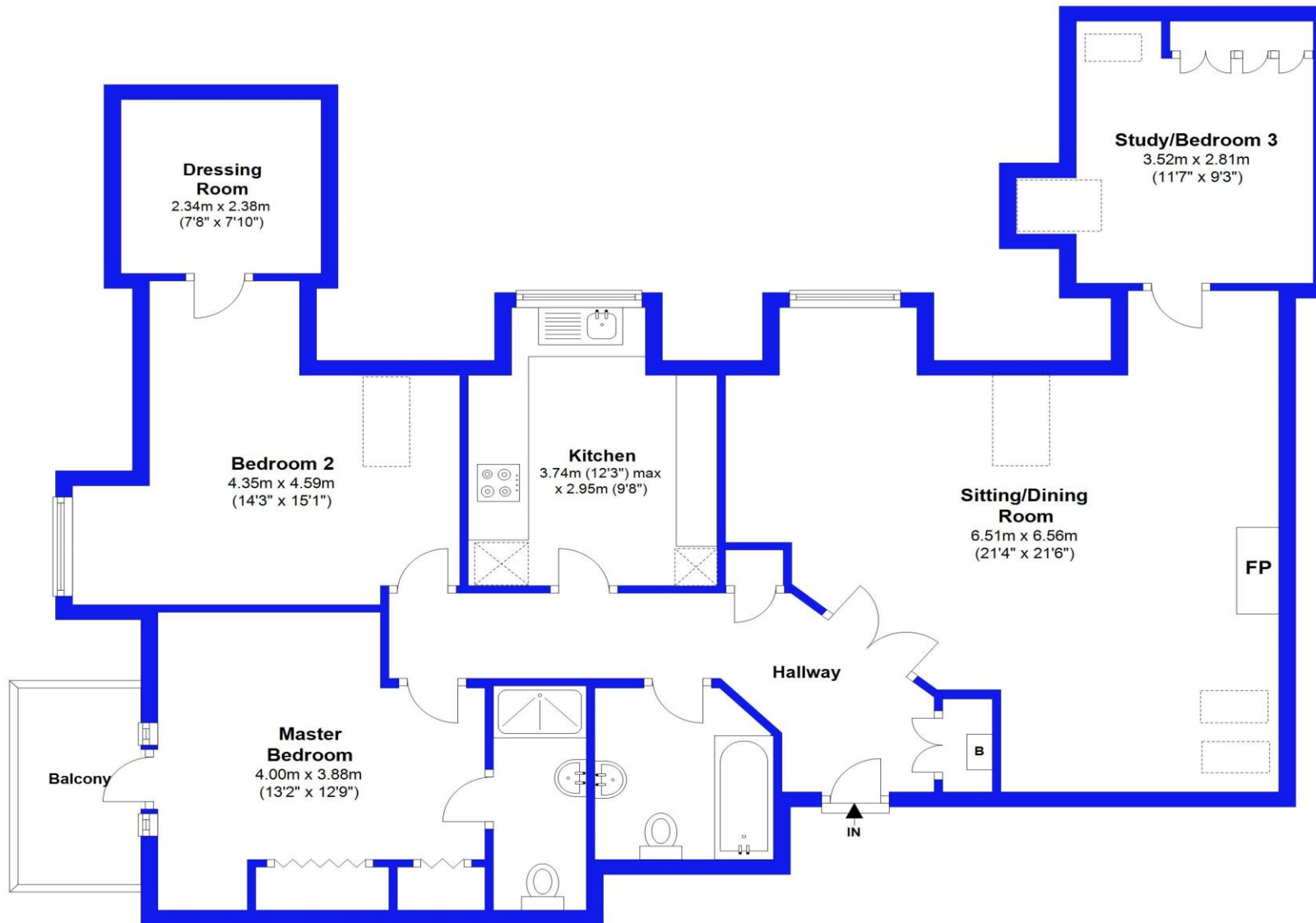

Illustration for identification purposes only; measurements are approximate, not to scale. EPC New Forest Plan produced using PlanUp.





mitchells.uk.com
highcliffe@mitchells.uk.com
01425 272206

Highcliffe on Sea
284 Lyminster Road
Highcliffe on Sea
BH23 4TH

