



118 Sycamore, Hoburne Bashley Holiday Park, BH25 5QR

£35,000

Mitchells
1963 — TODAY



*118 Sycamore
Hoburne Bashley
Holiday Park
New Milton
Hampshire
BH25 5QR*

A well-presented ABI Coworth Deluxe three bedroom holiday home situated in a lovely quiet cul de sac location on the popular Hoburne Bashley Holiday Park. Feature of the home include a modern kitchen leading through to the sitting/dining room with adjoining decking, a family shower room, two twin bedrooms and with bedroom one benefitting from an en-suite WC.

- 2021 ABI Coworth 36x12
- License Ends 30/11/2036
- Modern Kitchen
- Sitting/Dining Room
- Three Bedrooms
- Bedroom One With En Suite WC
- Family Shower Room
- Casual Parking
- Holiday Home
- Can't Be Main Residence



The Property

Entrance with UPVC double glazed door and cupboard housing the gas fired central heating boiler.

Kitchen with a range of timber effect wall and base units and matching timber worktop, contrasting tile effect flooring, stainless steel sink unit with mixer tap over and drainer, four burner gas hob with double oven underneath and extractor fan above and space for a stand up fridge/freezer.

Sitting/dining room with a U-shaped corner sofa unit, feature fireplace with shelving and electric fire, wall mounted TV aerial point, four seater dining table with bench seating and double casement doors onto the south facing decking.

Bedroom one is a generous size with a king sized bed, matching bedside units, double wardrobe and door leading to the en-suite WC.

Bedrooms two and three are both twin bedrooms with matching bedside units, a pleasant outlook to the side and a single wardrobe.

Family shower room with tile effect flooring, extractor fan and suite comprising a WC, pedestal wash hand basin with mixer tap over and mirror above and a shower cubicle with glass sliding doors and thermostatic controlled shower attachments.





Gardens & Grounds

To the front of the holiday home is a large area of south facing decking providing an excellent space for outside entertaining.

Adjoining the holiday home there is an area of patio providing extra outside space and a pathway leading to the casual parking.

Services

- Mains gas, electric, drainage and water



Ground Floor

Approx. 40.7 sq. metres (438.1 sq. feet)

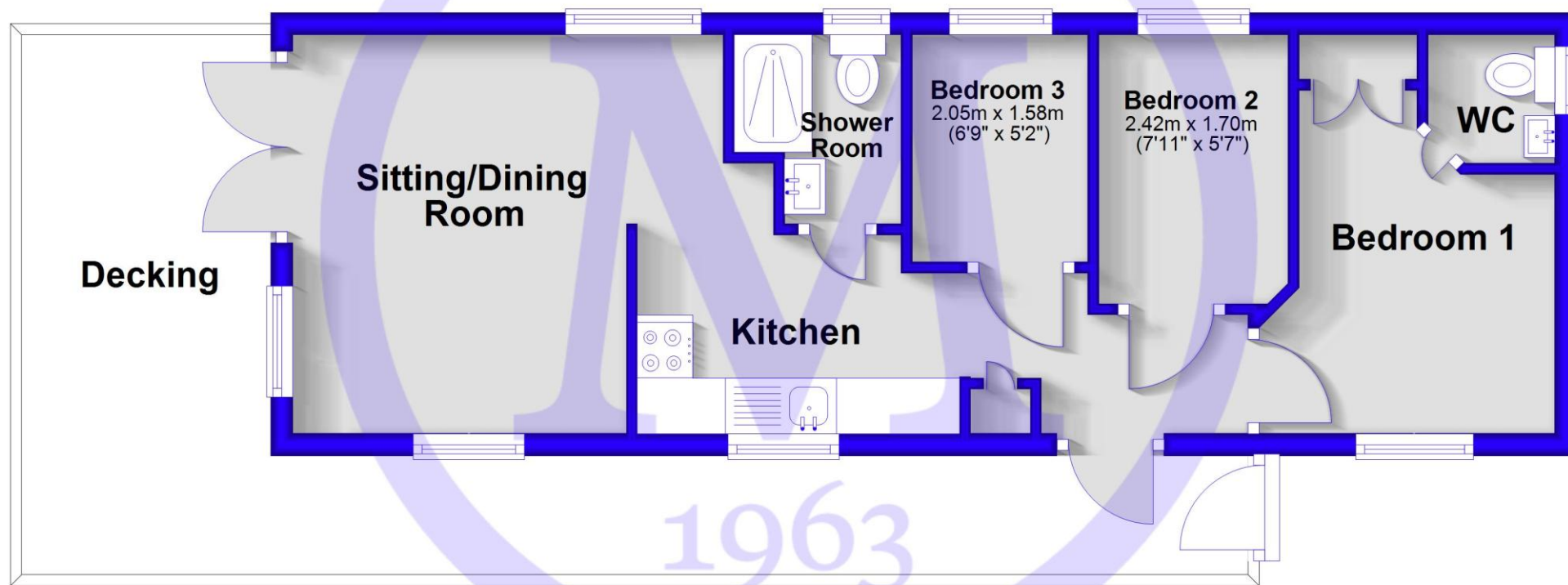

Total area: approx. 40.7 sq. metres (438.1 sq. feet)

Situation

In the heart of the enchanting New Forest Hoburne Bashley is a magical place to escape to with the open forest of the New Forest National Park, Barton on Sea clifftop and beach and New Milton high street all within easy reach. Facilities on offer at the park include an impressive entertainment complex, 9 hole golf course, heated pools, café and Brasserie, convenience store and a multi-use games area.

Directions

From Mitchells turn left at the traffic lights and proceed over the railway bridge. Upon reaching the roundabout turn right onto Sway Road. After 500 yards turn left into Hoburne Bashley, follow the road round past the reception building and follow the signs for Sycamore.

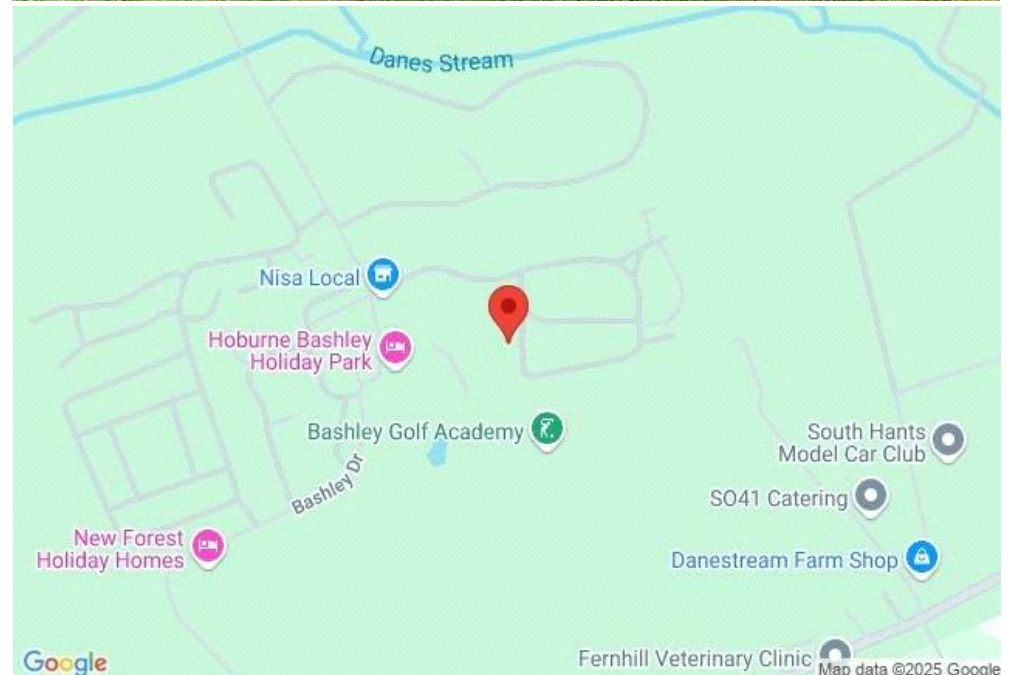



Mitchells.uk.com
info@mitchells.uk.com
01425 616411

Centenary Buildings
8-10 Old Milton Road
New Milton
Hampshire
BH25 6DT

Mitchells
1963 — TODAY

