

GROUND FLOOR
1372 sq.ft. (127.5 sq.m.) approx.

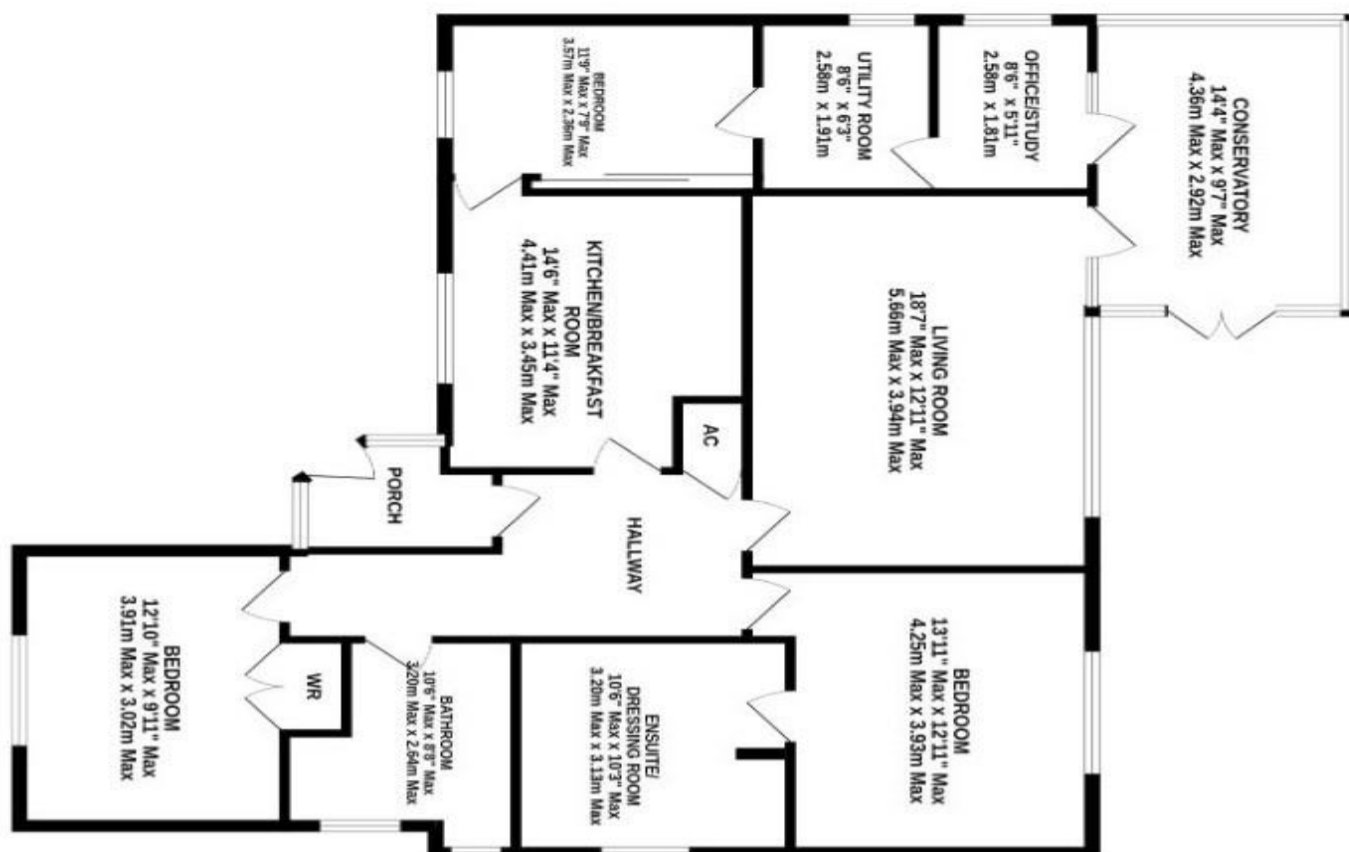

TOTAL FLOOR AREA: 1372 sq.ft. (127.5 sq.m.) approx.

While every effort has been made to ensure the accuracy of the floorplan, variations of doors, windows, rooms and any other items are approximate and no responsibility is taken for any error, omission or mis-statement. This plan is for illustrative purposes only and should be used in conjunction with the prospectus. The services, systems and appliances shown have not been tested and no guarantee as to their operation or efficiency can be given.
Made with SketchUp ©2023



12 Smugglers Lane South, Highcliffe On Sea, BH23 4NF

£625,000

Mitchells
1963 — TODAY

A very spacious detached bungalow of about 1400sqft situated opposite local beauty spot, Nea Meadows. The bungalow is in excellent condition and has been carefully maintained with modern fittings, a nicely fitted kitchen breakfast room, quality UPVC conservatory and a sunny, southwest facing garden.

This super home is conveniently situated for walking into Highcliffe village and is perfect for dog owners, having acres of open space immediately opposite on Nea Meadows. The shops at Saulflands are around the corner with Highcliffe Castle and the cliff top being nearby.

- Traditionally built detached bungalow
- Large master bedroom with extremely spacious en-suite
- Two further bedrooms and family bathroom
- Separate utility room and study
- Beautiful plot with established rear garden, garaging and parking
- Gas fired central heating and UPVC double glazing
- Plenty of space to extend (stpp)
- Excellent decorative order
- Council Tax 'E' £2658.58
- EPC 'D'

