



6 Jubilee Gardens, Shorefield Country Park, SO41 0LH

£579,995

Mitchells
1963 — TODAY



*6 Jubilee Gardens
Shorefield Country Park
Downton
Hampshire
SO41 0LH*

A truly stunning brand new two bedroom, two bathroom holiday home situated in a unique, select development within the ever popular Shorefield country park. Features of the property include spacious open plan living area with bifold doors onto the decking, two double bedrooms both with en suites and walk in wardrobes and allocated parking spaces.

- High Specification Luxury Holiday Home
- Spacious Open Plan Living Area
- Entrance Hall With WC
- Two Double Bedrooms, Both With En Suites And Walk In Wardrobes
- Large Area Of Decking
- Pergola And Sheltered Seating Area
- Allocated Parking
- The Hampton By Prestige 45x22
- 40 Year License
- Site Fees 2024/2025: £10,505.40
- Rates: £1649.39



The Property

Entrance hall with area for shoes and coats, airing cupboard housing the central heating boiler and washing machine.

Separate WC with UPVC double glazed window, wash hand basin with mixer tap over and WC.

Kitchen with navy shaker style wall and base units with contrasting worktop, wood effect flooring, UPVC double glazed window, ceramic sink unit with mixer tap over, breakfast bar overlooking the open plan living area and integrated appliances including microwave, raised electric oven, wine cooler, five burner gas hob, dishwasher and fridge freezer.

Sitting/dining room with bifold doors over the decking, large corner sofa, feature electric fire place, four seater dining table and chairs.

Bedroom one is a generous double bedroom with a vaulted ceiling, floor to ceiling windows, dressing area with ample storage and door leading to the part tiled en suite shower room with suite comprising walk in shower, WC with hidden cistern, wash hand basin with mixer tap over and storage beneath, fitted mirror and chrome ladder style heated towel rail.

Bedroom two is currently laid as a twin bedroom and also features a vaulted ceiling and floor to ceiling windows. It has a walk in wardrobe which houses the electrical consumer unit and is fitted with shelving and hanging space and also benefits from an en suite bathroom with suite comprising panel bath with mixer tap over and shower attachments, glass shower screen, wash hand basin with mixer tap over and storage beneath, WC and chrome ladder style heated towel rail.

The property is situated in Jubilee Gardens which is a brand new gated select development with prices starting at £289,950.





Gardens & Grounds

To the rear of the holiday home is an area of decking leading to the entrance hall.

To the front of the property is a large area of decking which adjoins the sitting/dining room and both bedrooms. The lodge also benefits from a sheltered seating area, pergola and allocated parking.

Services

At Shorefield Country Park the site fees run from November to October and the rates charge runs April to March. These can be paid over six or twelve months. The gas and electricity are metered and billed in May and November. The park is open from 10th February to 5th January.

Floor Plan

Approx. 83.3 sq. metres (896.2 sq. feet)

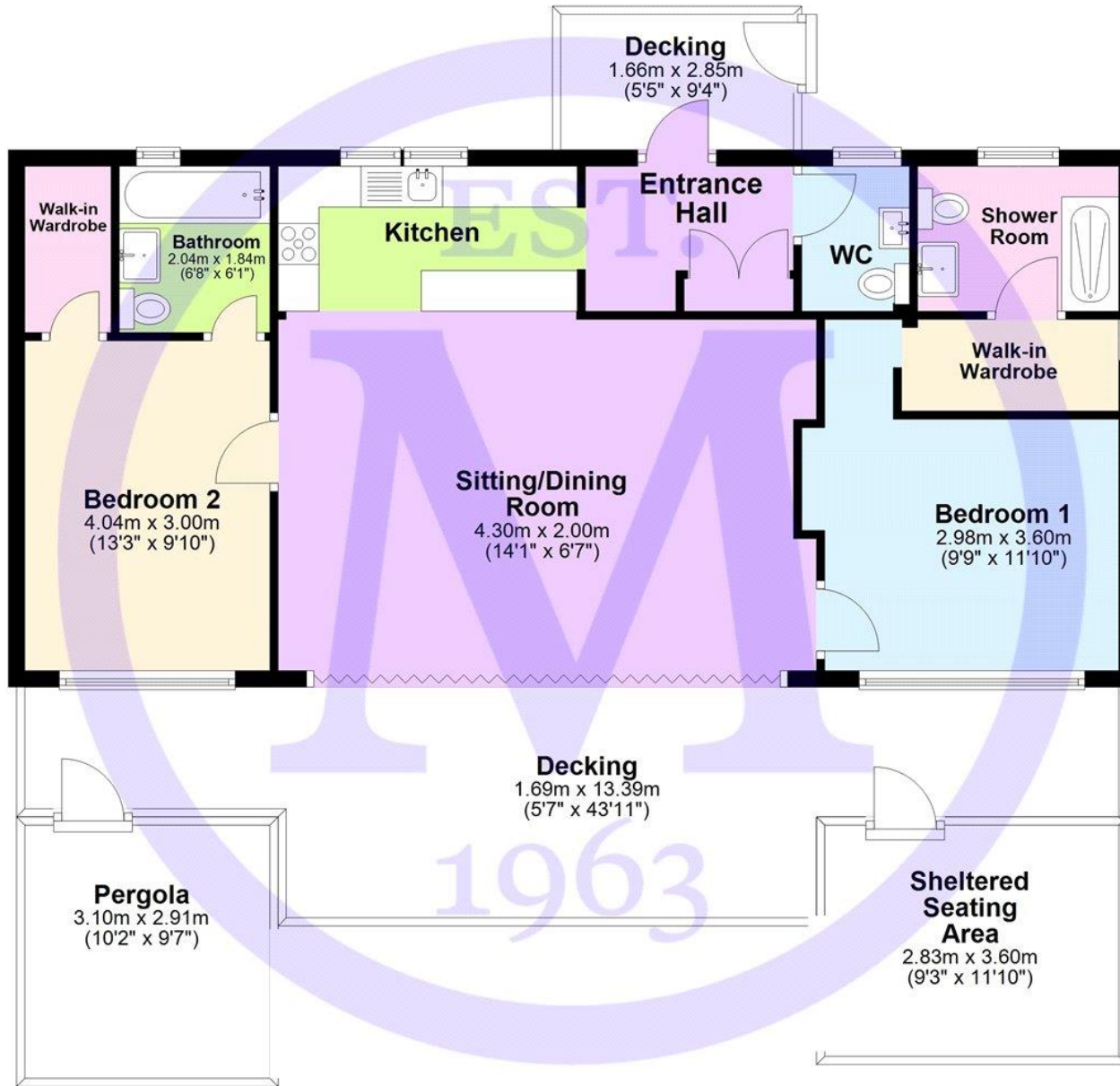

Total area: approx. 83.3 sq. metres (896.2 sq. feet)

Prestige Hampton 45x22

Situation

Situated on the southern edge of the New Forest National Park, and just a short stroll away from the shingled shores of the beach at Milford on Sea, the award winning Shorefield Country Park is a fantastic position to own the ultimate bolthole. Facilities include heated indoor and outdoor pools, gym and day spa, bars, restaurant, fishing lake, pet friendly areas, play areas, tennis courts and live family entertainment.

Directions

From Mitchells turn right at the traffic lights and proceed along Station Road. At the roundabout turn left onto Lymington Road, continue across the next roundabout and take the second right into Downton Lane where Shorefield Country Park will be found on the left hand side.





Mitchells.uk.com
info@mitchells.uk.com
01425 616411

Centenary Buildings
8-10 Old Milton Road
New Milton
Hampshire
BH25 6DT

Mitchells
1963 — TODAY

