



67 Field Place, Hoburne Naish, BH25 7RD

£265,000

Mitchells
1963 — TODAY



*67 Field Place
Hoburne Naish
New Milton
Hampshire
BH25 7RD*

A fantastic opportunity to purchase this brand new Omar Image 40 x 12 residential park home that is sited on the highly sought after Naish Park. The property comes fully furnished with features including a fully fitted kitchen/dining room, a separate sitting room, two bedrooms, a private garden and a driveway.

- Kitchen/Dining Room
- Sitting Room
- Hallway
- Family Bathroom
- Two Bedrooms
- Driveway
- Private Garden
- Omar Image
- Useful Storage Shed
- Ground Rent £251.97 per month



The Property

The front door leads through to the entrance hall with a radiator, useful coat hooks and carpeted flooring.

The kitchen/dining room is a particular feature of this property with a bright double aspect, Herringbone style flooring, a fantastic range of cream wall and base units with a contrasting marble effect worktop, stainless steel sink with mixer tap over and drainer and integrated appliances include a four burner gas hob with extractor fan over, undercounter oven, tall stand up fridge freezer, wall mounted Worcester boiler, washer dryer, slimline dishwasher, tiled splashback, four seater table and chairs and a double glazed door leading out to the garden.

The sitting room is situated at the front of the property with a bright double aspect, two seater sofa, arm chair, feature fireplace with an inset electric fire, wall mounted TV aerial point and recess ceiling spotlights.

The bathroom has been beautifully finished with a modern suite comprising a panel bath with mixer tap over and independent thermostatic shower attachment and folding glass shower screen, UPVC window, WC, wall hung wash hand basin with mixer tap over and storage beneath, tiled splashback, large chrome heated towel rail and shaver point.

Bedroom two is a lovely single bedroom with a built in wardrobe, single bed and bedside cabinets.

The master bedroom is a generous double bedroom with a great selection of built in storage, a wall mounted TV aerial point and a large UPVC window.





Gardens & Grounds

To the side of the property is a block paviour driveway giving off road parking for one vehicle with steps leading up to the front door with the rest of the garden laid to shingle for ease of maintenance with a useful storage shed, a small area of lawn and high level fencing making it extremely private and secluded.

The property must be viewed to be fully appreciated.

Services

- Mains gas, electric, drainage and water
- Council Tax Band A
- Energy Performance Rating TBC

Ground Floor

Approx. 45.0 sq. metres (484.4 sq. feet)

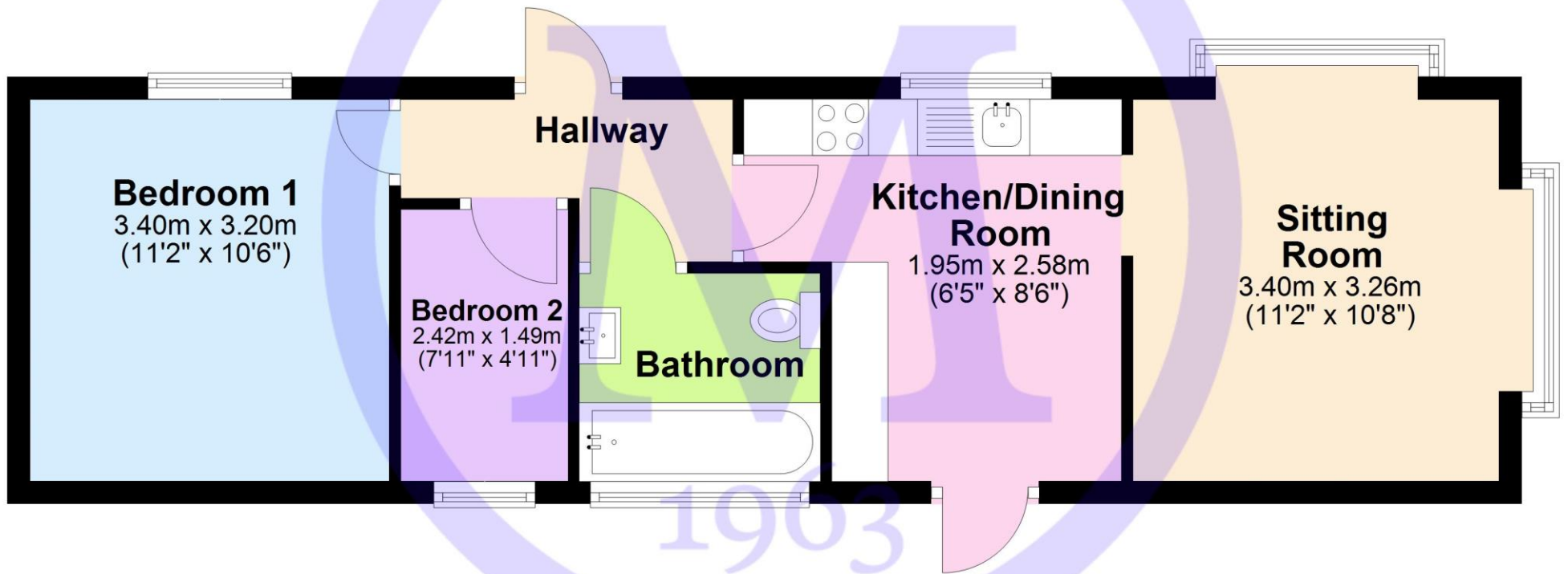

Omar Image 40x12, Hoburne Naish

Situation

Superb clifftop location with easy access to the beautiful beaches, the stunning clifftop walks, the open forest of the New Forest National Park and the nearby towns of Highcliffe on Sea and New Milton, Facilities include an impressive entertainment complex, heated pools, adventure golf, fitness suite, multi-use games area, brasserie and café among others.

Directions

From Mitchells proceed along Old Milton Road. At the roundabout continue straight across. At the T-Junction turn right onto Christchurch Road. Continue for approximately one mile and take the first turning left into Naish, second turning left into Field Place, second left again where the property will be found after a short distance on the right hand side.





Mitchells.uk.com
info@mitchells.uk.com
01425 616411

Centenary Buildings
8-10 Old Milton Road
New Milton
Hampshire
BH25 6DT

Mitchells
1963 — TODAY

