



19 Field Place, Naish Estate, BH25 7RD

£265,000

Mitchells
1963 — TODAY



*19 Field Place
Naish Estate
Barton On Sea
Hampshire
BH25 7RD*

This stunning two bedroom brand new residential park home is situated on this popular residential park and benefitting from the use of all the facilities and a short walk to Barton clifftop and beach. The property offers bright and airy accommodation with features including open planned living, a private garden, a driveway and a metal storage shed.

- Entrance Hall
- Kitchen/Dining Room
- Sitting Room
- Family Bathroom
- Two Bedrooms
- Off Road Parking
- Private Garden
- Metal Storage Shed
- Ground Rent £251.97 per month



The Property

Entrance hall with useful coat hooks, radiator and carpeted flooring.

The highly impressive open planned living area has been beautifully finished with shaker style wall and base units, a contrasting timber effect worktop, stainless steel sink with mixer tap over and drainer and integrated appliances include a four burner gas hob with a stainless steel splashback and extractor fan over, slimline dishwasher, washer dryer, eye level oven, tall stand up fridge freezer, a cupboard housing the Worcester combination boiler, a useful breakfast bar and a dining table and chairs.

This opens through to the double aspect sitting room with a wall mounted TV point and an attractive bay window to the front.

The family bathroom is finished to an extremely high standard with a suite comprising a panel bath with mixer tap over and independent thermostatic shower, folding glass shower screen, part tiled walls, wash hand basin with mixer tap over and storage beneath, WC, chrome heated towel rail, wall mounted mirror and shaver point.

Bedroom two is a lovely single with a built in wardrobe, a single bed and a bedside cabinet.

The master bedroom is a particularly good size with built in furniture and a dressing table.





Gardens & Grounds

To the front of the property is an area of parking with a block paviour path leading to the front door.

To the rear of the property the garden has been laid to lawn surrounded by high level fencing making it extremely private and secluded, a metal storage shed and a block paviour path leading from the back door to the rear garden and front.

Services

- Mains gas, electric, drainage and water
- Council Tax Band TBC
- Energy Performance Rating TBC

Floor Plan

Approx. 47.6 sq. metres (512.6 sq. feet)

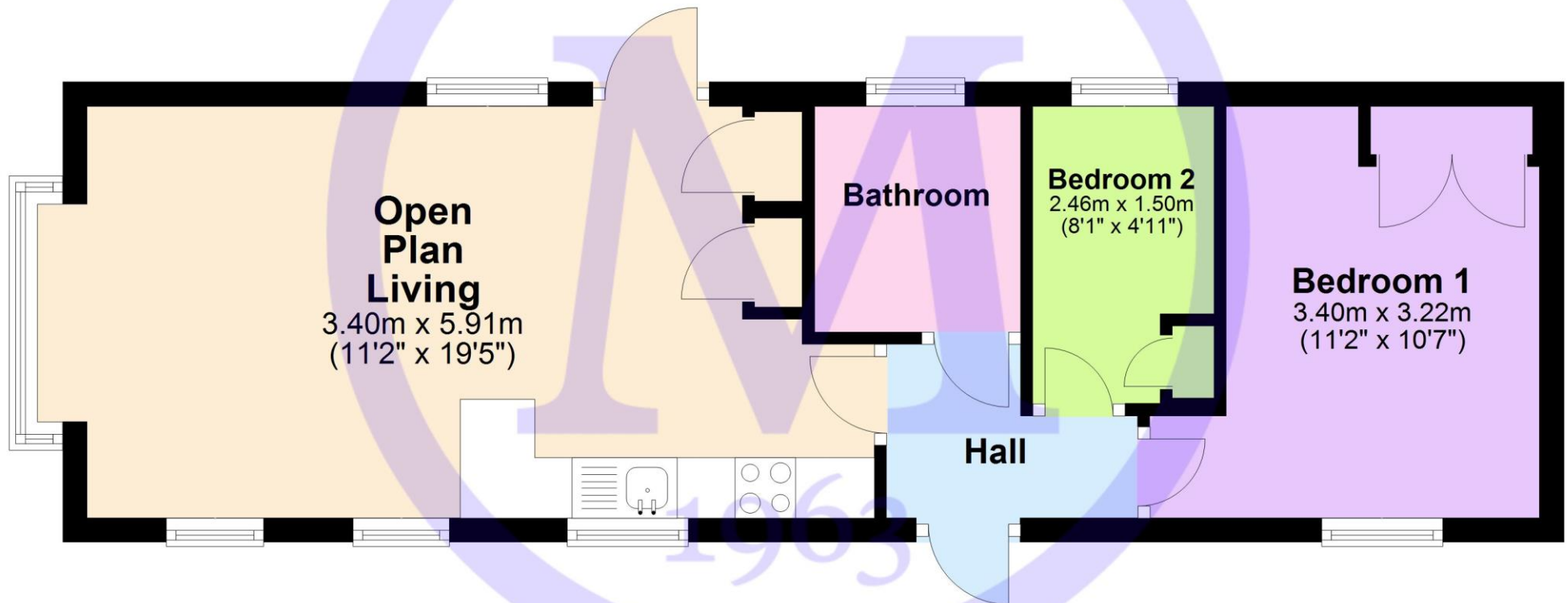

Omar Newmarket, 40 X 12, Barton On Sea



Situation

Superb clifftop location with easy access to the beautiful beaches, the stunning clifftop walks, the open forest of the New Forest National Park and the nearby towns of Highcliffe on Sea and New Milton, Facilities include an impressive entertainment complex, heated pools, adventure golf, fitness suite, multi-use games area, brasserie and café among others.

Directions

From Mitchells proceed along Old Milton Road. At the roundabout continue straight across. At the T-Junction turn right onto Christchurch Road. Continue for approximately one mile and take the first turning left into Naish, second turning left into Field Place, second left again where the property will be found after a short distance on the right hand side.





Mitchells.uk.com
info@mitchells.uk.com
01425 616411

Centenary Buildings
8-10 Old Milton Road
New Milton
Hampshire
BH25 6DT

Mitchells
1963 — TODAY

