

## Floor Plan

### Approx Gross Internal Areas

House: 119.8 sqm / 1289.4 sqft  
Garage: 18.5 sqm / 199.4 sqft

**Total Approx Gross Area:  
138.3 sqm / 1488.8 sqft**

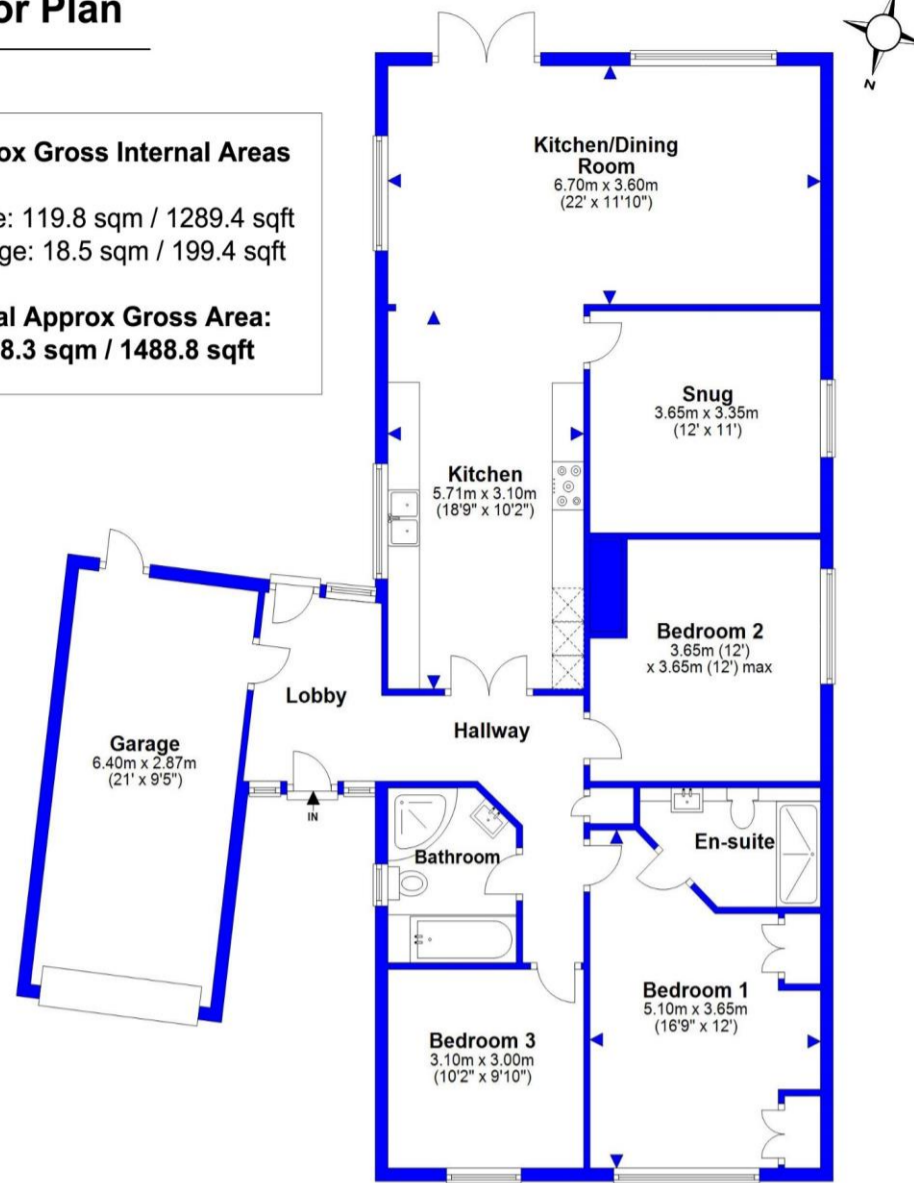

21 Braemar Drive, Highcliffe On Sea, BH23 5NN

£835,000

**Mitchells**  
1963 — TODAY

A stunning bungalow that has been comprehensively refurbished inside and out and now presented in 'as new' condition. Featuring high end fittings and a contemporary finish with stylish open plan living and generous bedrooms, the bungalow has a lovely rear garden and a pretty outlook to Lakewood open space to the front.

The developers have done everything they can to bring this property up to date with new drainage/soakaways, brand new central heating with underfloor heating throughout, new roof coverings, windows, fascias/soffits/guttering, wiring, water main/meter and a total re-plaster of walls/ceilings- it is the next best thing to a brand new home. Quick possession.

- Spacious accommodation of about 1400sq ft with an immaculate finish
- Master bedroom with fitted wardrobes and luxury en-suite shower room
- Two further double bedrooms and luxury family bath/shower room with designer sanitary ware and tiling
- Superb fitted kitchen with quality appliances, quartz work-tops and an open plan living/dining area
- Separate TV lounge/snug
- Integral garage with electric door and utility area to the rear
- Extensive parking on the block paved driveway
- Private south facing garden with 42 sq m of newly laid patio
- Council Tax Band 'E' - £2658.58
- EPC TBC

