



28 Woodland View, Bashley Caravan Park, BH25 5QR

£67,500

Mitchells
1963 — TODAY



*28 Woodland View
Bashley Caravan Park
Sway Road
New Milton
BH25 5QR*

This beautiful Atlas Lilac holiday home is situated in this highly sought after development on the popular Bashley Park and is situated in a quiet position just a short walk of the main restaurants, bar and swimming pool. The property offers bright and modern accommodation with features including a fully fitted kitchen, open planned living, a separate utility room, a master bedroom with a dressing room and en-suite and a private and secluded decking.

- Kitchen
- Sitting/Dining Room
- Utility Room
- Hallway
- Two Bedrooms
- Family Bathroom
- En-Suite Shower Room
- Dressing Room
- Private Decking
- Site Fees: £8,785
- 40 x 16
- License Until 2039



The Property

The UPVC double glazed front door leads through to the living area which has a bright triple aspect with an L-shaped sitting/dining room with a feature wall mounted fire, TV aerial point, two sofas, one with a pull out sofa bed, a four seater table and chairs and double casement doors leading out to the sunny west facing decking.

The kitchen is fitted with a fantastic range of cream wall and base units with a contrasting marble effect worktop, a stainless steel sink with mixer tap over and drainer, built in appliances include a tall stand up fridge freezer, dishwasher, eye level oven, microwave, four burner electric hob with extractor fan over and tile effect flooring.

The separate utility room has matching units and worktop with stainless steel sink with mixer tap over and drainer, built in washing machine, storage cupboard and radiator.

Hallway with central heating thermostat, hatch to loft space and useful coats cupboard.

The main shower room is fitted with a modern suite comprising a wash hand basin with mixer tap over and storage beneath, WC, walk in double shower with thermostatic shower attachments, radiator and wall mounted mirror.

Bedroom two is a full sized twin bedroom with two single beds, bedside cabinet and a fantastic range of built in storage.

The master bedroom is a particular feature of this property with TV aerial point, dressing room with built in wardrobe, shelving and hanging rails and this inert leads through to the en-suite bathroom.

The en-suite consists of a WC, wash hand basin with mixer tap over and storage beneath, wall mounted mirror, panel bath with mixer tap over and shower attachments, folding glass shower screen and a UPVC window.





Gardens & Grounds

To the front of the property is a private area of west facing decking with a glass balustrade and a sunny westerly aspect.

The property is offered with no chain and a viewing is highly recommended.

Services

- Mains electric, drainage and water
- Council Tax Band N/A
- Energy Performance Rating N/A

EST. Floor Plan

Approx. 56.4 sq. metres (606.8 sq. feet)

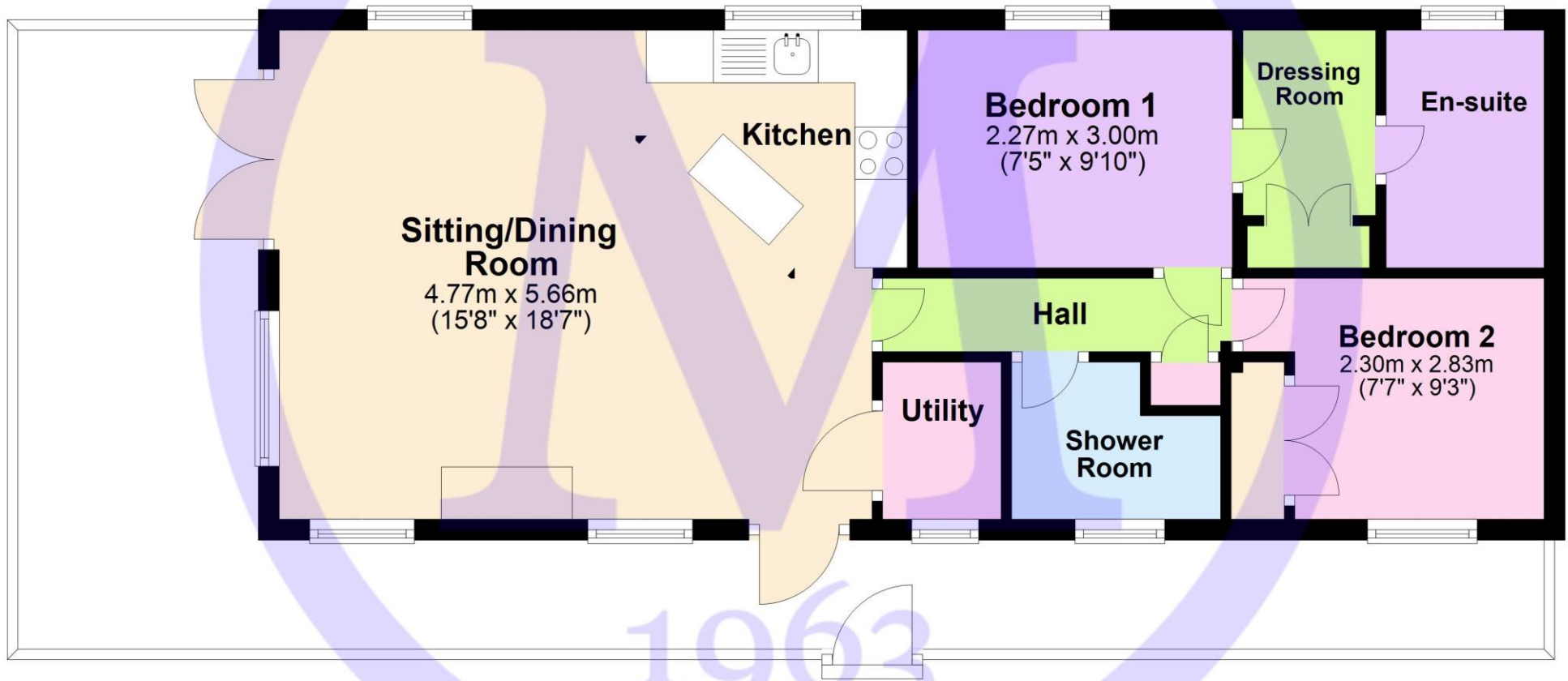

'Whilst every attempt has been made to ensure the accuracy of this floor plan, the measurements of doors, windows, rooms and any other items are approximate and no responsibility is taken for any error, omission or mis-statement. This plan is for illustrative purposes only and should be used as such by any prospective purchaser.'

Plan produced using PlanUp.

28 Woodland View, Bashley Park, New Milton

Situation

In the heart of the enchanting New Forest Hoburne Bashley is a magical place to escape to with the open forest of the New Forest National Park, Barton on Sea clifftop and beach and New Milton high street all within easy reach. Facilities on offer at the park include an impressive entertainment complex, 9 hole golf course, heated pools, café and Brasserie, convenience store and a multi-use games area.

Directions

From Mitchells turn left at the traffic lights and proceed over the railway bridge. Continue to the Bashley roundabout and turn right onto Sway Road. After approximately 500 yards turn left into Bashley Park. Follow the road and after passing reception, take the first left, then the second right onto Woodland View where the property will be found on the left hand side.



Hoburne
Bashley

Park map

- 1 Reception & entertainment complex
- 2 The Venue
- 3 Café h
- 4 Beauty h
- 5 Brasserie 1932
- 6 Lounge bar
- 7 Indoor pool
- 8 Outdoor pool
- 9 Adventure playground
- 10 Crazy golf
- 11 Multi-use sports court
- 12 Holiday home showground
- 13 Holiday home sales office
- 14 Laundrette
- 15 Park shop
- 16 Woodland h
- 17 Toddler's play area
- 18 Outdoor café
- 19 Archery tunnel
- 20 Woodland Activity Area
- 21 Accessible Woodland Walks, Fairy Trail and Picnic Areas
- 22 Recycling
- 23 Nature trail





Mitchells.uk.com
info@mitchells.uk.com
01425 616411

Centenary Buildings
8-10 Old Milton Road
New Milton
Hampshire
BH25 6DT

Mitchells
1963 — TODAY

