



*254 Sycamore, Hoburne Bashley, BH25 5QR*

*£69,995*

**Mitchells**  
1963 — TODAY



*254 Sycamore  
Hoburne Bashley  
Holiday Park  
New Milton  
Hampshire*

This beautifully presented ABI Malham holiday home is situated on the popular Bashley Park on the edge of the New Forest National Park. The property offers bright accommodation with modern fittings with features including an open plan kitchen/living area, master bedroom with ensuite shower room, a generous and secluded decking and a 9 year license.

- Entrance Hall
- Kitchen/Breakfast Room
- Sitting Room
- Two Bedrooms
- Ensuite Shower Room
- Family Shower Room
- Private & Secluded Decking
- Nearby Parking
- License Length: 9 Years
- 40 x 13
- 2025 Fees & Insurance Included
- 11 Month Season (Can't Be Main Residence)



## The Property

Entrance hall with tiled effect flooring, cupboard housing the central heating boiler, useful coat hooks and a double glazed front door.

The kitchen/dining room is fitted to with a fantastic range of timber effect wall and base units with a contrasting stone effect worktop, a bright double aspect and built in appliances include a five burner gas hob with extractor fan over, microwave, eye level double oven, tall stand up fridge freezer, washing machine, dishwasher and a one and a half bowl sink unit with mixer tap over and drainer. There is also a four seater table and chairs and an archway leading through to the sitting room.

The sitting room has a spacious L shaped sofa with pull out sofa bed, a bright triple aspect, built in sound system, TV aerial point, feature fireplace and double casement doors leading out to the private decking.

The main shower room is fitted with a modern suite comprising a WC, wash hand basin with mixer tap over and storage beneath, walk in double shower with sliding glass shower doors, heated towel rail and window.

The master bedroom is a particularly spacious room with a great range of built in furniture, a double bed with built in cabinets and its own luxury ensuite shower room.

The ensuite comprises of a walk in double shower, WC, wash hand basin with mixer tap over and storage beneath, built in mirror, shaver point and heated towel rail.

Bedroom two is a spacious twin bedroom with built in wardrobes, two single beds, TV aerial point and additional USB sockets.





## *Gardens & Grounds*

To the front of the property is a spacious and private decking area making a fantastic space for outside entertaining and the unit is a short walk from all the main facilities.

## *Services*

- Mains gas, electric, drainage and water

## Floor Plan

Approx. 46.5 sq. metres (500.8 sq. feet)

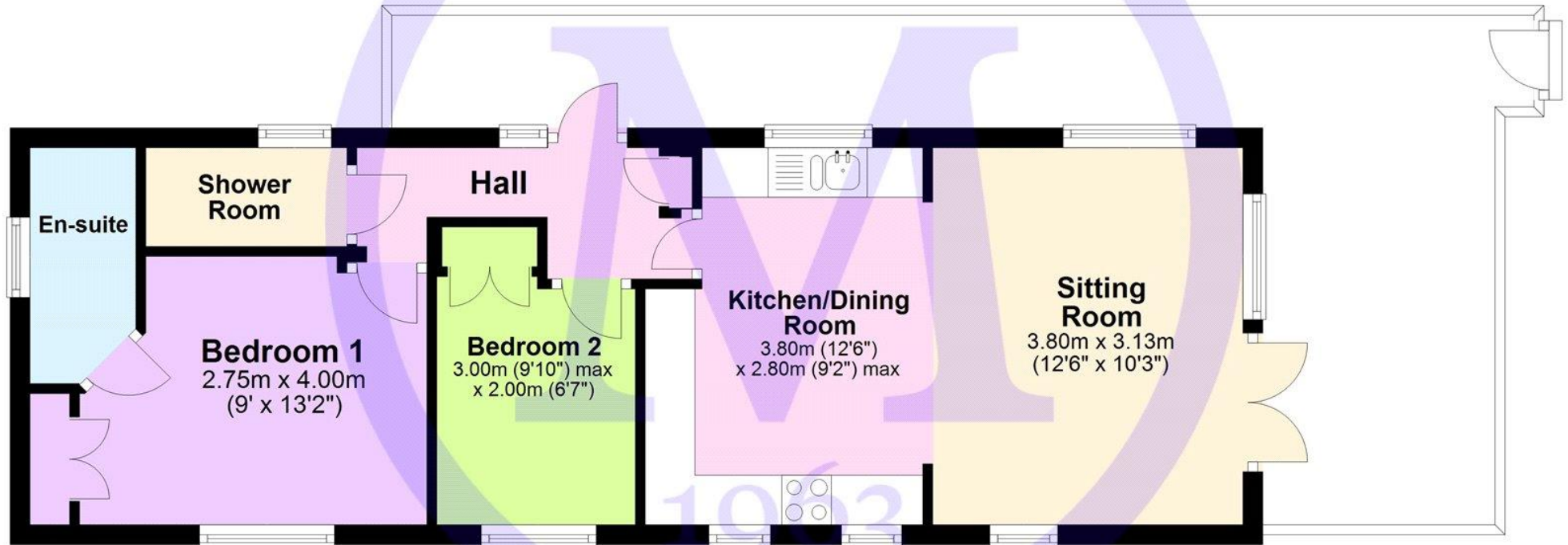

Total area: approx. 46.5 sq. metres (500.8 sq. feet)

'Whilst every attempt has been made to ensure the accuracy of this floor plan, the measurements of doors, windows, rooms and any other items are approximate and no responsibility is taken for any error, omission or mis-statement. This plan is for illustrative purposes only and should be used as such by any prospective purchaser.'

Plan produced using PlanUp.

**254 Sycamore, Bashley Park, New Milton**



## Situation

Superb clifftop location with easy access to the beautiful beaches, the stunning clifftop walks, the open forest of the New Forest National Park and the nearby towns of Highcliffe on Sea and New Milton, Facilities include an impressive entertainment complex, heated pools, adventure golf, fitness suite, multi-use games area, brasserie and café among others.

## Directions

From Mitchells turn left at the traffic lights and proceed over the railway bridge. Upon reaching the roundabout turn right onto Sway Road. After 500 yards turn left into Hoburne Bashley, follow the road round past the reception building and full the signs for Sycamore.





[Mitchells.uk.com](http://Mitchells.uk.com)  
[info@mitchells.uk.com](mailto:info@mitchells.uk.com)  
01425 616411

Centenary Buildings  
8-10 Old Milton Road  
New Milton  
Hampshire  
BH25 6DT

**Mitchells**  
1963 — TODAY

