



*5 Hurst Close, Naish Estate, BH25 7RF*

*£265,000*

**Mitchells**  
1963 — TODAY



*5 Hurst Close  
Naish Estate  
New Milton  
Hampshire  
BH25 7RF*

An immaculately presented three bedroom park home situated on the popular Naish Estate and with the added benefit of the use of the facilities. Other features of this property include a lovely decking style balcony, off road parking for two vehicles, private gardens, a modern kitchen and shower room, a lovely double aspect sitting/dining room, extensive built in storage and excellent condition throughout.

- Hall
- Sitting/Dining Room
- Kitchen
- Inner Hall
- Three Bedrooms
- Shower Room
- Double Driveway
- Private Gardens



## The Property

Entrance hall with a UPVC double glazed front door and a useful cloak/utility cupboard with space for a tumble dryer.

A lovely double aspect sitting/dining room with a feature fireplace with a timber fire surround and an inset flame effect electric fire and UPVC double glazed casement doors onto the west facing decking.

Kitchen fitted with a range of modern wall and base units with a contrasting worktop and an inset one and a half bowl sink unit with a mixer tap over, an integrated double electric oven, gas hob and extractor, space for a dishwasher, washing machine and tall fridge freezer, part tiled walls, recess ceiling spotlights and under cupboard lighting.

Inner hall with trap to the loft space, a boiler cupboard housing the wall mounted Worcester gas fired boiler and a separate airing cupboard.

Three bedrooms all with built in bedroom furniture.

Luxury shower room fitted with a modern white suite comprising a large shower cubicle with a glass shower screen and a thermostatic control shower, wash basin, WC and attractive tile effect walls.

UPVC double glazing & gas fired central heating.





## *Gardens & Grounds*

The property sits on a private plot with a driveway providing off road parking and gardens extended to three sides laid mainly to textured paved patio and shingle for ease of maintenance, a small area of lawn, a timber gate providing side access, a second off road parking area and a wooded backdrop.

## *Services*

- Mains gas, electric, drainage and water
- Council Tax Band A
- Energy Performance Rating To be confirmed

## First Floor

Approx. 72.1 sq. metres (776.4 sq. feet)

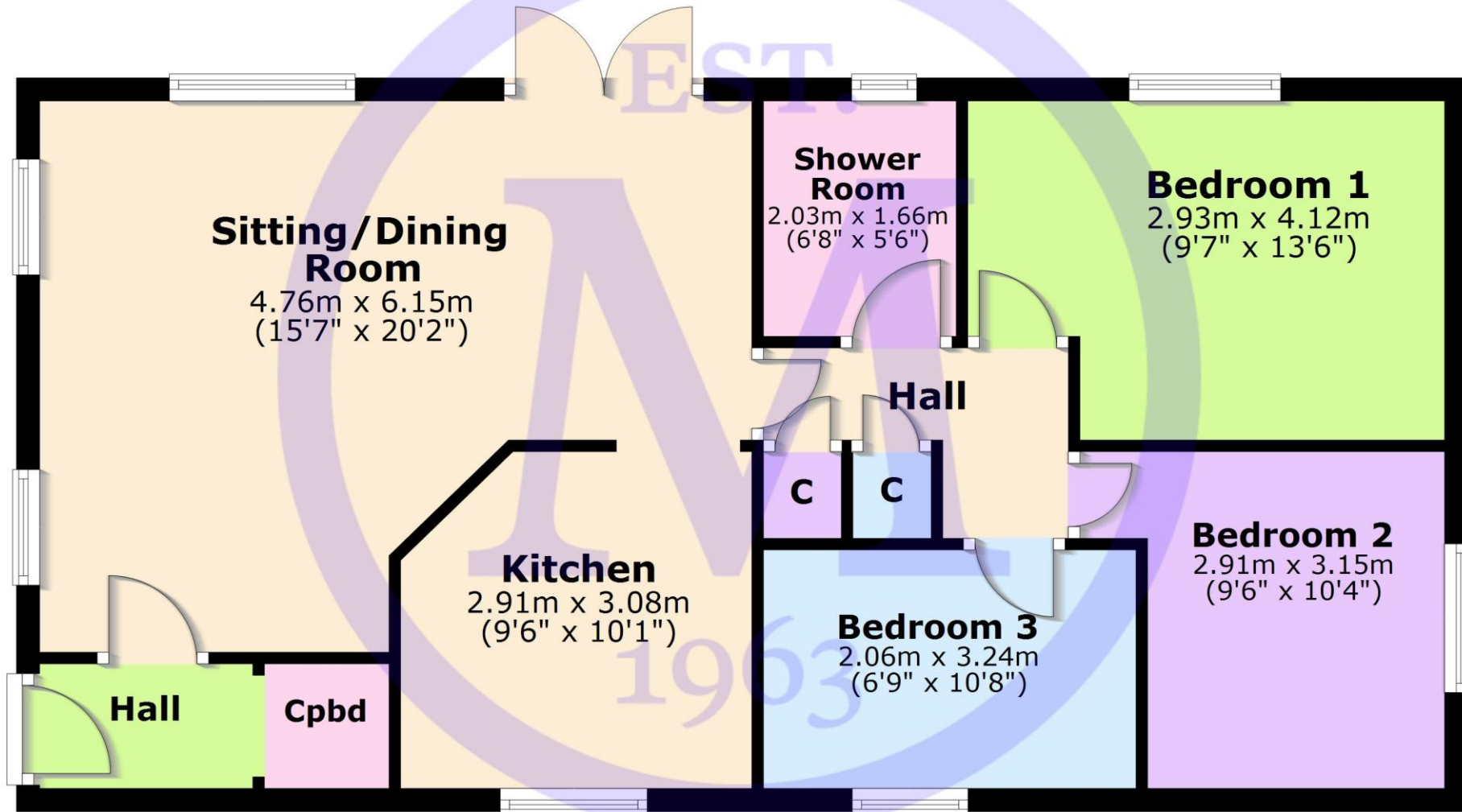

Total area: approx. 72.1 sq. metres (776.4 sq. feet)

**5 Hurst Close, Naish Estate, Barton On Sea, New Milton**



## Situation

Superb clifftop location with easy access to the beautiful beaches, the stunning clifftop walks, the open forest of the New Forest National Park and the nearby towns of Highcliffe on Sea and New Milton, Facilities include an impressive entertainment complex, heated pools, adventure golf, fitness suite, multi-use games area, brasserie and café among others.

## Directions

From Mitchells proceed along Old Milton Road. At the roundabout continue straight across and upon reaching the T junction turn right onto Christchurch Road. After approximately half a mile turn left into Field Place, fork right and take the first turning on the left. At the end of the road turn left and follow the signs into Hurst Close.





[Mitchells.uk.com](http://Mitchells.uk.com)  
[info@mitchells.uk.com](mailto:info@mitchells.uk.com)  
01425 616411

Centenary Buildings  
8-10 Old Milton Road  
New Milton  
Hampshire  
BH25 6DT

**Mitchells**  
1963 — TODAY

