



*3 Elmwood Way, Highcliffe on Sea, BH23 5DL*

*£795,000*

**Mitchells**  
1963 — TODAY







# *Elmwood Way, Highcliffe on Sea*

Enviably located in Highcliffe's Premier residential area midway between the sea front and the main high street shopping centre. A stunning three bedroom, two bathroom detached luxury bungalow. Properties like this are a rarely available. Viewing highly recommended.

- **THREE BEDROOMS • TWO BATH/SHOWER ROOMS (ONE EN-SUITE) • KITCHEN/BREAKFAST ROOM • UTILITY ROOM • CONSERVATORY • GARAGE • GARDENS • OFF-ROAD PARKING •**

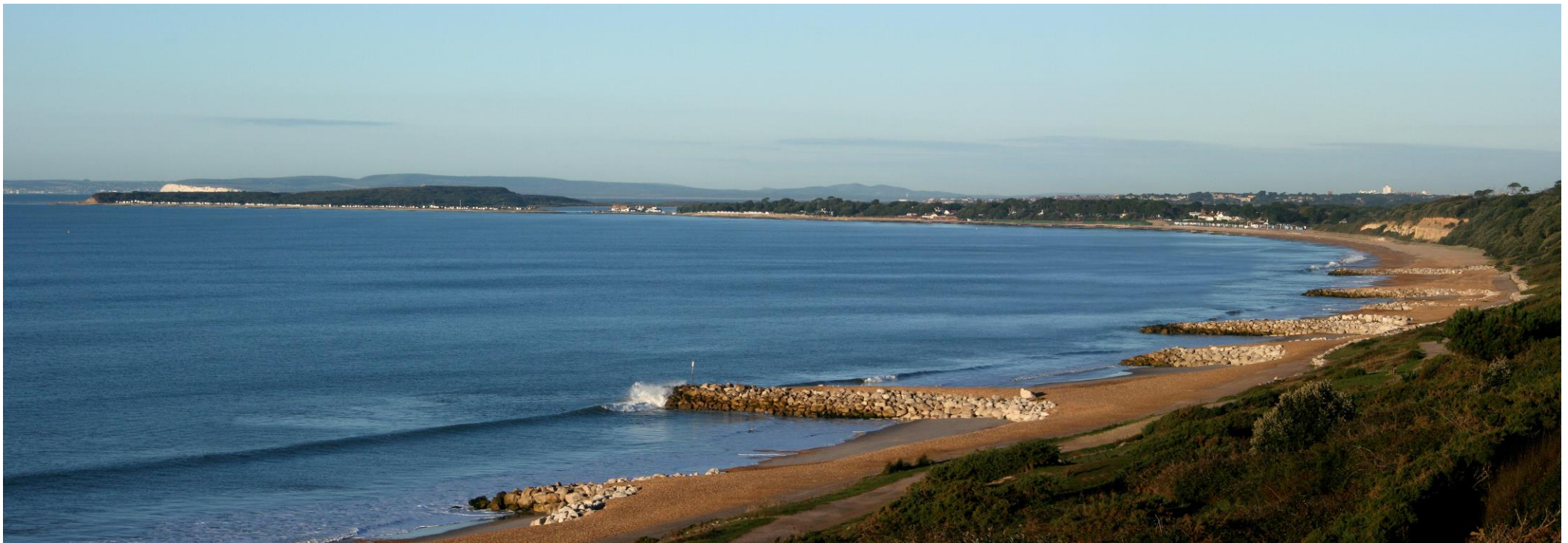



## The Property

- Fabulous master bedroom suite with luxury full en-suite bathroom inc bath and separate shower
- Delightful sitting room to the front with feature raised Living Flame gas fire
- Large luxury beautifully fitted kitchen/breakfast room with integrated appliances and granite worktops
- Superb large upvc conservatory/dining room overlooking the garden
- Upvc double glazing & Gas C.H. and solar panels
- Good size integral garage & off-road parking
- Excellent location within a 'stone's throw' of the sea front and just a short stroll to the main high street
- Quiet cul-de-sac location in this premier residential area
- Viewing highly recommended in order to fully appreciate the style, quality and the many fine features
- Council Tax 'E' £2658.58
- EPC TBC







## Location

Highcliffe is a small village in the borough of Christchurch, Dorset. The village lies on a picturesque stretch of Solent coastline with views over Christchurch Bay to the Isle of Wight. Fuelled by its enviable location, coastal walks, main line railway links to London (in under two hours) excellent schools and the popularity of the Chewton Glen Hotel, the Highcliffe Golf Course and the Nature Reserve at Steamer Point, Highcliffe is a popular area for those relocating to the coast.



## Ground Floor

Approx. 139.2 sq. metres (1498.1 sq. feet)

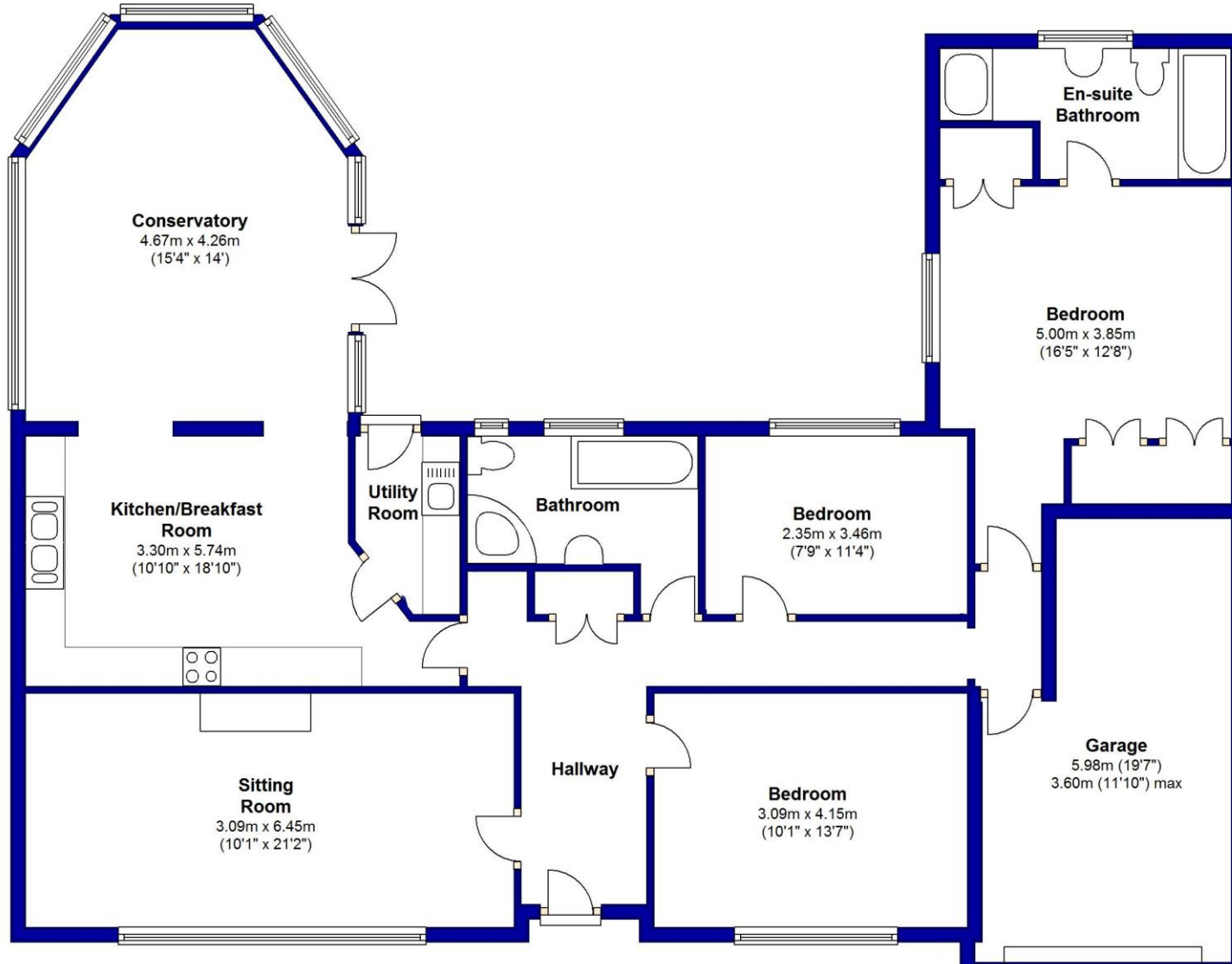









[mitchells.uk.com](http://mitchells.uk.com)  
[highcliffe@mitchells.uk.com](mailto:highcliffe@mitchells.uk.com)  
01425 272206

Highcliffe  
284 Lymington Road  
Highcliffe  
BH23 5ET

