



4 Carisbrooke Court, New Milton, BH25 5US

£325,000

Mitchells
1963 — TODAY



*4 Carisbrooke Court
New Milton
Hampshire
BH25 5US*

This beautifully presented two double bedroom semi detached house is ideally situated in this quiet cul de sac and features include excellent decorative order throughout, modern kitchen and bathroom, driveway, garage and private secluded gardens.

- Entrance Hall
- Sitting/Dining Room
- Kitchen
- First floor Landing
- Two Double Bedrooms
- Family Bathroom
- Driveway
- Garage
- Secluded Gardens



The Property

Entrance hall with UPVC window, useful coat hooks and glazed door leading through to the sitting/dining room.

Sitting/dining room with timber effect flooring, stairs to first floor landing, modern UPVC window with outlook to the front, TV ariel point and glazed door leading through to the kitchen.

The kitchen is a particular feature of the property with a modern range of grey shaker style wall and base units with a contrasting Quartz worktop, timber effect flooring, UPVC door leading out to the patio and rear garden and integrated appliances include five burner gas hob with tiled splashback, under counter oven, stainless steel sink with mixer tap over and drainer and space and plumbing for a dishwasher and tall stand up fridge freezer.

First floor landing with trap to roof space.

The family bathroom has been beautifully fitted with suite comprising WC, wash hand basin with mixer tap over and storage beneath, panel bath with mixer tap over and independent thermostatic shower attachment, glass shower screen, fully tiled walls, tiled floor and chrome heated towel rail.

Bedroom one and two are both lovely double bedrooms with the master enjoying an outlook to the front and bedroom two having an outlook over the rear garden with storage cupboard housing the modern Glow worm combination boiler and further area of storage.





Gardens & Grounds

To the front of the property is an area of lawn with driveway giving access to the single garage and giving off road parking for two vehicles.

The garage is a single garage with pitched roof with modern electric roller door, power and lighting and a rear door giving access to the rear garden.

The rear garden has been nicely landscaped with an area of patio with the rest of the garden mainly laid to lawn with mature borders and raised area of artificial grass to enjoy the late evening sun.

Services

- Mains gas, electric, drainage and water
- Council Tax Band C
- Energy Performance Rating D

Ground Floor

Approx. 47.4 sq. metres (510.1 sq. feet)

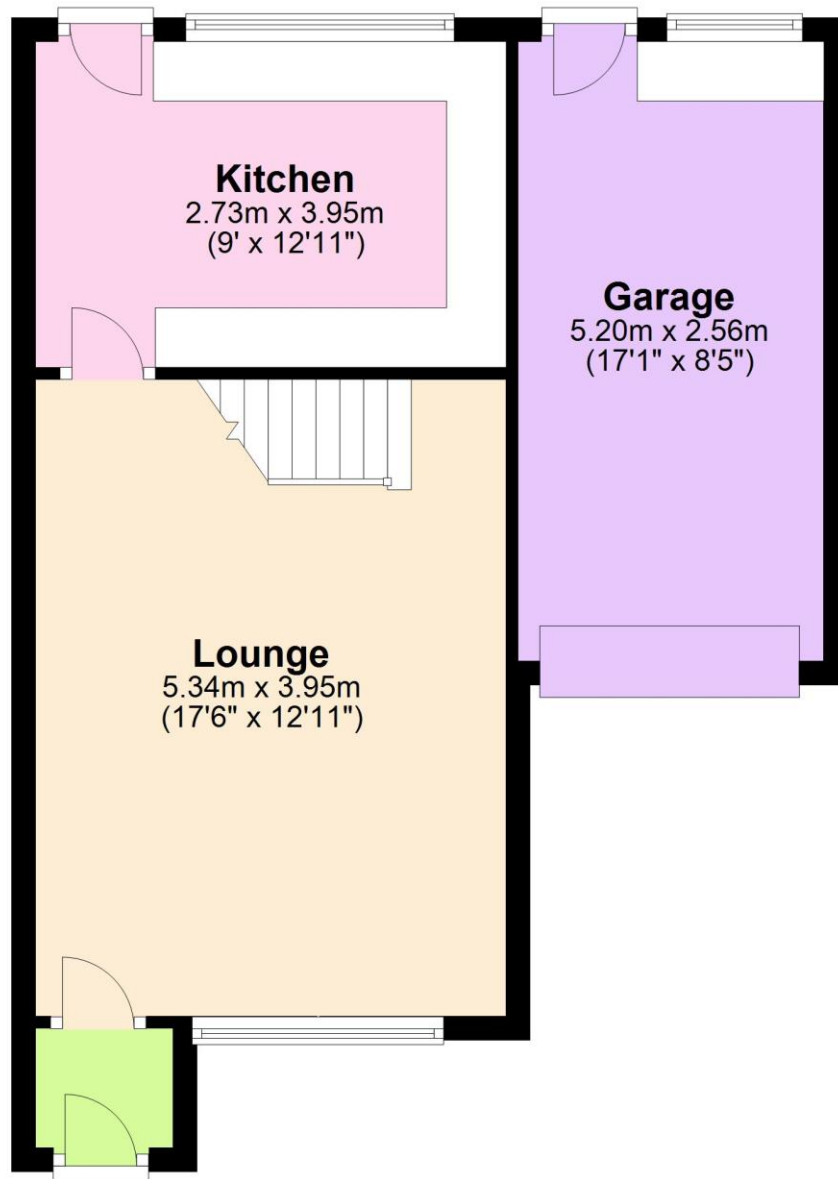

First Floor

Approx. 32.3 sq. metres (347.4 sq. feet)

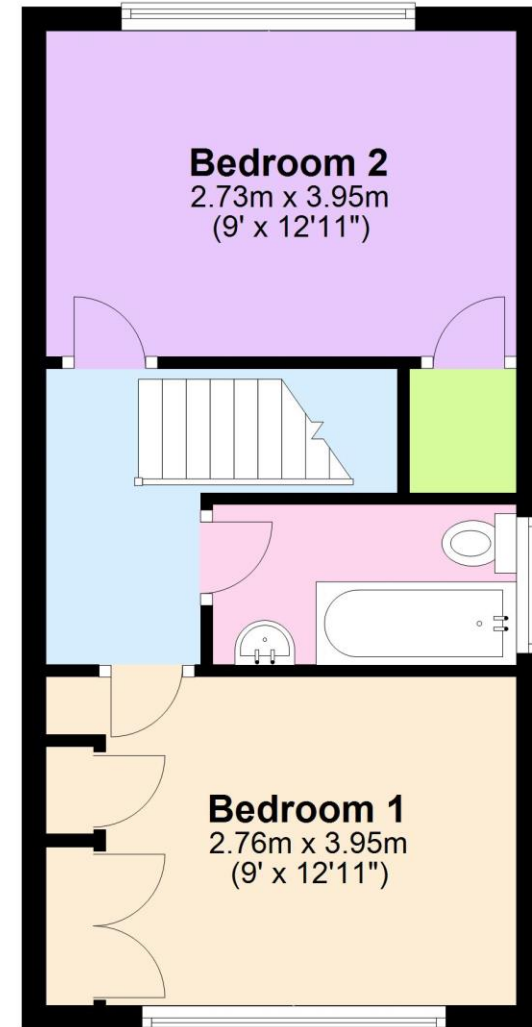

4 Carisbrook Court

Situation

New Milton is a thriving market town on the western edge of Hampshire. The area lies on a picturesque stretch of the Solent coastline with stunning views over Christchurch Bay to the Isle of Wight. With the enviable location, beautiful coastal walks, main line railway station reaching London Waterloo in less than two hours, excellent schools, both private and state, 27 hole links style golf course and the renowned Chewton Glen hotel, New Milton remains an extremely popular location for those relocating to the coast.

Directions

From Mitchells proceed along Old Milton Road. At the roundabout continue straight across and take the first turning right into Gore Road. After approximately half a mile turn right into Stem Lane. Take the fourth turning right into Chatsworth Way, take the fifth turning left into Carisbrooke Court where the property will be found on the left hand side.

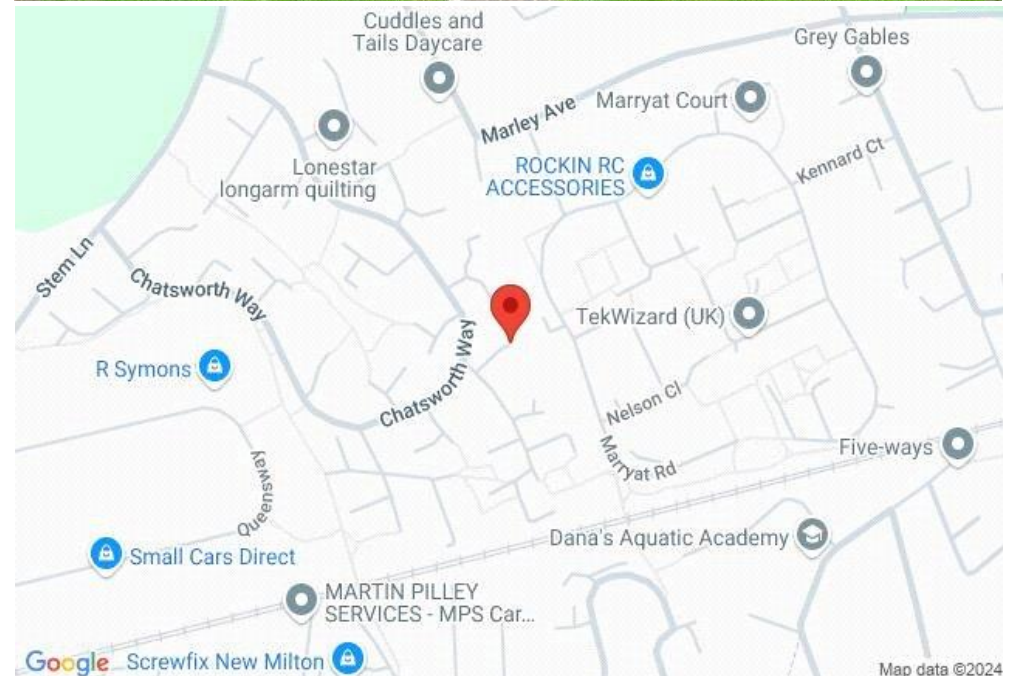



Mitchells.uk.com
info@mitchells.uk.com
01425 616411

Centenary Buildings
8-10 Old Milton Road
New Milton
Hampshire
BH25 6DT

Mitchells
1963 — TODAY

