



*116 Sycamore, Bashley Caravan Park, BH25 5QR*

*£32,995*

**Mitchells**  
1963 — TODAY



*116 Sycamore  
Bashley Caravan Park  
Sway Road  
New Milton  
BH25 5QR*

This fantastic three bedroom ABI Blenheim is situated just a steps from all the facilities including the golf course, swimming pool and restaurants. The property offers bright and modern accommodation with features including an open plan kitchen/living area, a master bedroom with an en-suite cloakroom, a private decking and parking.

- Kitchen/Dining Room
- Sitting Room
- Three Bedrooms
- Family Shower Room
- En-Suite Cloakroom
- Private Parking
- Large Area Of Decking
- License ends November 2031
- 11 Month Season (Can't Be Main Residence)



## The Property

The kitchen is fitted with a fantastic range of wall and base units with a contrasting worktop, a stainless steel sink with mixer tap over and drainer and other built in appliances include a microwave, cooker with four burner electric hob and double oven, extractor fan over, tall stand up fridge freezer and a four seater table and chairs.

This opens through to the sitting room with a generous L-shaped sofa, double casement doors leading out to the decking, shelving unit with built in electric fire and wall mounted TV and has a bright triple aspect.

Bedrooms two and three are both lovely twin bedrooms both benefitting from built in storage and bedroom two benefits from a TV aerial point.

The master bedroom is situated at the rear of the property and is a lovely double bedroom with a good range of built in storage and benefits from its own en-suite cloakroom.

The en-suite cloakroom consists of a WC, pedestal wash hand basin with mixer tap over, UPVC window and mirror fronted medicine cabinet.

The main shower room is a lovely size with a walk in double shower with thermostatic shower attachment, WC, pedestal wash hand basin, mirror fronted medicine cabinet with shaver point and UPVC window.

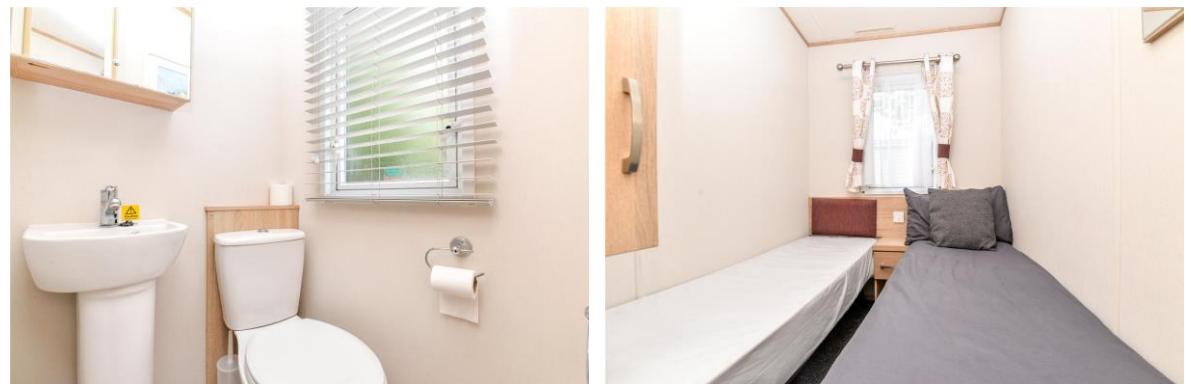



## *Gardens & Grounds*

To the front of the property is a private raised decking with steps leading down to a private parking bay and an outside storage unit.

The property is offered with vacant possession and a viewing is highly recommended.

## *Services*

- Mains gas, electric, drainage and water
- Council Tax Band N/A
- Energy Performance Rating N/A

## Floor Plan

Approx. 41.8 sq. metres (450.0 sq. feet)

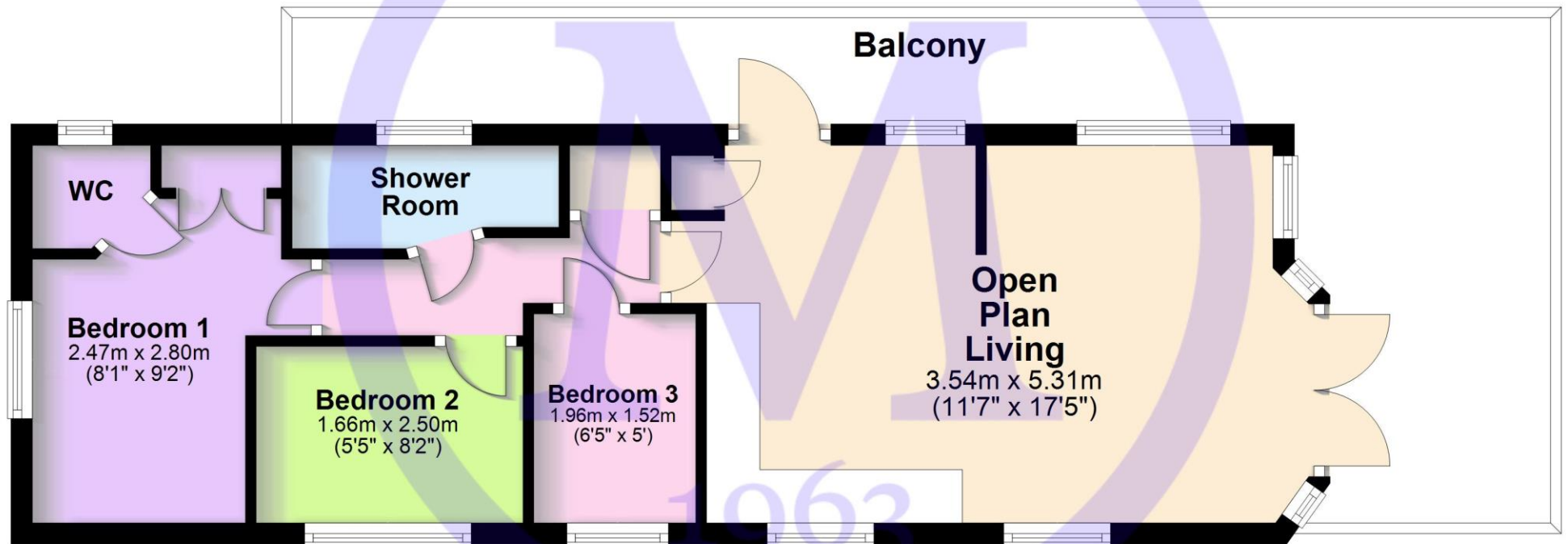

Total area: approx. 41.8 sq. metres (450.0 sq. feet)

'Whilst every attempt has been made to ensure the accuracy of this floor plan, the measurements of doors, windows, rooms and any other items are approximate and no responsibility is taken for any error, omission or mis-statement. This plan is for illustrative purposes only and should be used as such by any prospective purchaser.'

Plan produced using PlanUp.



## Situation

In the heart of the enchanting New Forest Hoburne Bashley is a magical place to escape to with the open forest of the New Forest National Park, Barton on Sea clifftop and beach and New Milton high street all within easy reach. Facilities on offer at the park include an impressive entertainment complex, 9 hole golf course, heated pools, café and Brasserie, convenience store and a multi-use games area.

## Directions

From Mitchells turn left at the traffic lights and proceed over the railway bridge. Upon reaching the roundabout turn right onto Sway Road. After 500 yards turn left into Hoburne Bashley, follow the road round past the reception building and full the signs for Sycamore.



### Park map

- 1 Reception & entertainment complex
- 2 The Venue
- 3 Café h
- 4 Beauty h
- 5 Brasserie 1932
- 6 Lounge bar
- 7 Indoor pool
- 8 Outdoor pool
- 9 Adventure playground
- 10 Crazy golf
- 11 Multi-use sports court
- 12 Holiday home showground
- 13 Holiday home sales office
- 14 Laundrette
- 15 Park shop
- 16 Woodland h
- 17 Toddler's play area
- 18 Outdoor café
- 19 Archery tunnel
- 20 Woodland Activity Area
- 21 Accessible Woodland Walks, Fairy Trail and Picnic Areas
- 22 Recycling
- 23 Nature trail





[Mitchells.uk.com](http://Mitchells.uk.com)  
[info@mitchells.uk.com](mailto:info@mitchells.uk.com)  
01425 616411

Centenary Buildings  
8-10 Old Milton Road  
New Milton  
Hampshire  
BH25 6DT

**Mitchells**  
1963 — TODAY

