



G24 Shorefield Country Park, Downton, SO41 0LH

£52,250

Mitchells
1963 — TODAY



*G24
Shorefield Country Park
Downton
Lymington
Hampshire
SO41 0LH*

An excellent positioned eight berth holiday home which is only a few steps from the clubhouse and all facilities. This holiday home is presented in as new condition having only been used a handful of times and offers seventeen years remaining on the licence. Features include a very bright open planned kitchen/living/dining area located on the south-west side of the caravan, a fully integral kitchen, a luxury bathroom, an en-suite WC to the master bedroom, excellent storage, a wraparound decking and two allocated parking bays.

- ABI Beverley 40x12ft
- 17 Years Remaining On License
- Kitchen/Dining Room
- Sitting Room
- Three Bedrooms
- Bathroom
- En-Suite WC
- South Facing Decking
- Two Parking Bays



The Property

Entrance doors leading from the decking into the kitchen area.

The kitchen is fully integral including a washer dryer, fridge freezer, double electric oven with gas hob and a microwave.

This is pleasantly open planned into the generous living space which enjoys a triple aspect with sliding doors leading onto the south facing decking.

Bedrooms two and three are generous twins both with built in storage.

The master bedroom is of a good sized with a built in drawer units and shelving and benefits from an en-suite WC.

Main bathroom with part tiled walls, walk in double width shower cubicle, pedestal wash hand basin, low flush WC, window, ladder towel rail and vinyl flooring.

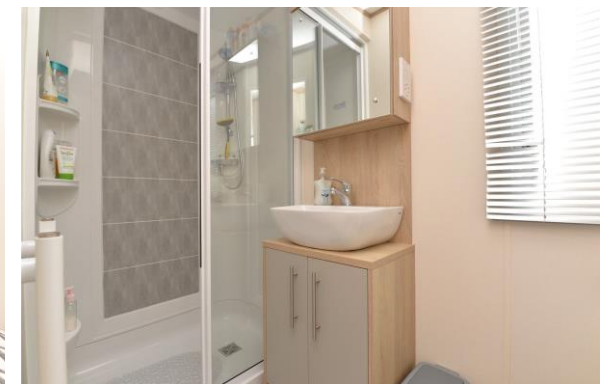



Gardens & Grounds

This caravan occupies a well-positioned plot with two allocated parking spaces, a surrounding decking, a large outside storage containing for bikes, barbeques, etc. and is only a few steps from the clubhouse.

Services

- Mains gas, electric, drainage and water
- Council Tax Band N/A
- Energy Performance Rating N/A

Ground Floor

Approx. 46.2 sq. metres (496.9 sq. feet)

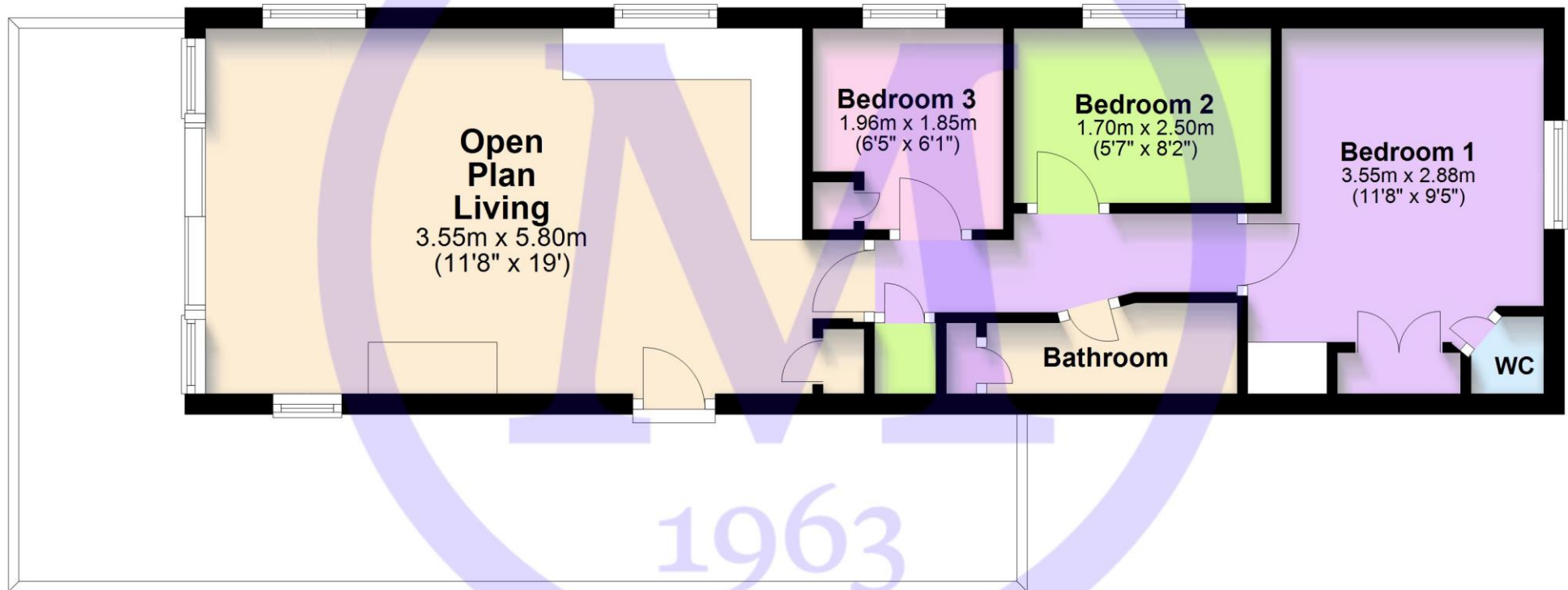

'Whilst every attempt has been made to ensure the accuracy of this floor plan, the measurements of doors, windows, rooms and any other items are approximate and no responsibility is taken for any error, omission or mis-statement.

This plan is for illustrative purposes only and should be used as such by any prospective purchaser.'

Plan produced using PlanUp.

G24 Shorfield, Downton

Situation

Situated on the southern edge of the New Forest National Park, and just a short stroll away from the shingled shores of the beach at Milford on Sea, the award winning Shorefield Country Park is a fantastic position to own the ultimate bolthole. Facilities include heated indoor and outdoor pools, gym and day spa, bars, restaurant, fishing lake, pet friendly areas, play areas, tennis courts and live family entertainment.

Directions

From Mitchells turn right at the traffic lights and proceed down Station Road. Continue across the mini roundabout onto Milford Road, continue for approximately one and a half miles, turn left into Downton Lane, immediately right into Shorefield, continue along Shorefield Way, through the barriers which will open automatically. At the roundabout turn left, take the second left where the property will be found on the right hand side.





Mitchells.uk.com
info@mitchells.uk.com
01425 616411

Centenary Buildings
8-10 Old Milton Road
New Milton
Hampshire
BH25 6DT

Mitchells
1963 — TODAY

