

GROUND FLOOR
531 sq.ft. (49.3 sq.m.) approx.

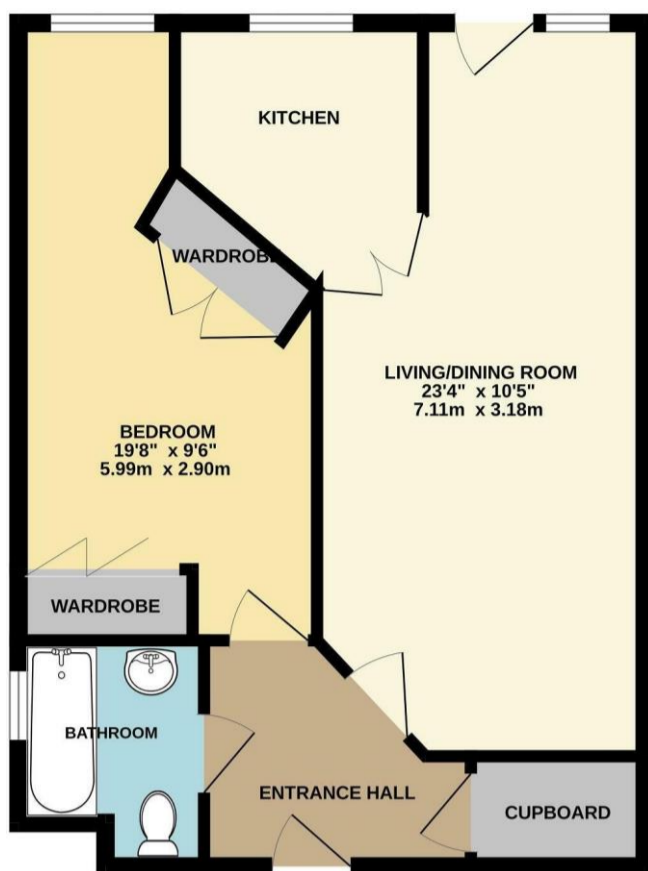

TOTAL FLOOR AREA: 531 sq.ft. (49.3 sq.m.) approx.
Whilst every attempt has been made to ensure the accuracy of the floorplan contained here, measurements of doors, windows, rooms and any other items are approximate and no responsibility is taken for any error, omission or mis-statement. This plan is for illustrative purposes only and should be used as such by any prospective purchaser. The services, systems and appliances shown have not been tested and no guarantee as to their operability or efficiency can be given.
Made with Metropix 5/2023



17 Seward Court. Lymington Road, Highcliffe, BH23 5HD

£135,000

Mitchells
1963 — TODAY

A very well presented one bedroom first floor retirement apartment in one of the most desirable locations in this prestigious complex. Built by renowned developers McCarthy & Stone to exacting standards, boasting excellent communal facilities including residents lounge, house warden and 24 hour careline.

Seward Court is situated right in the centre of the village with all the local facilities on your door step. The cliff top and beach are just a short level stroll away. No forward chain.

- Retirement apartment of approx 530sqft
- Double bedroom with fitted wardrobes
- Good size sitting/dining room with Juliette balcony
- Pleasant outlook over the communal gardens
- Fully fitted kitchen
- Neutral décor throughout
- Modern bathroom with window
- Ground Rent: £197.50 payable twice yearly on 1st March & 1st September
- Maintenance: £1798.73 Variable & payable twice yearly on 1st March & 1st September
- Lease: 125 yrs from 1 July 2006
- Council Tax 'C' £1933.52
- EPC 'C'

